

**EJM ENGINEERING, INC.**  
 411 South Wells Street Suite 800  
 Chicago, Illinois 60607

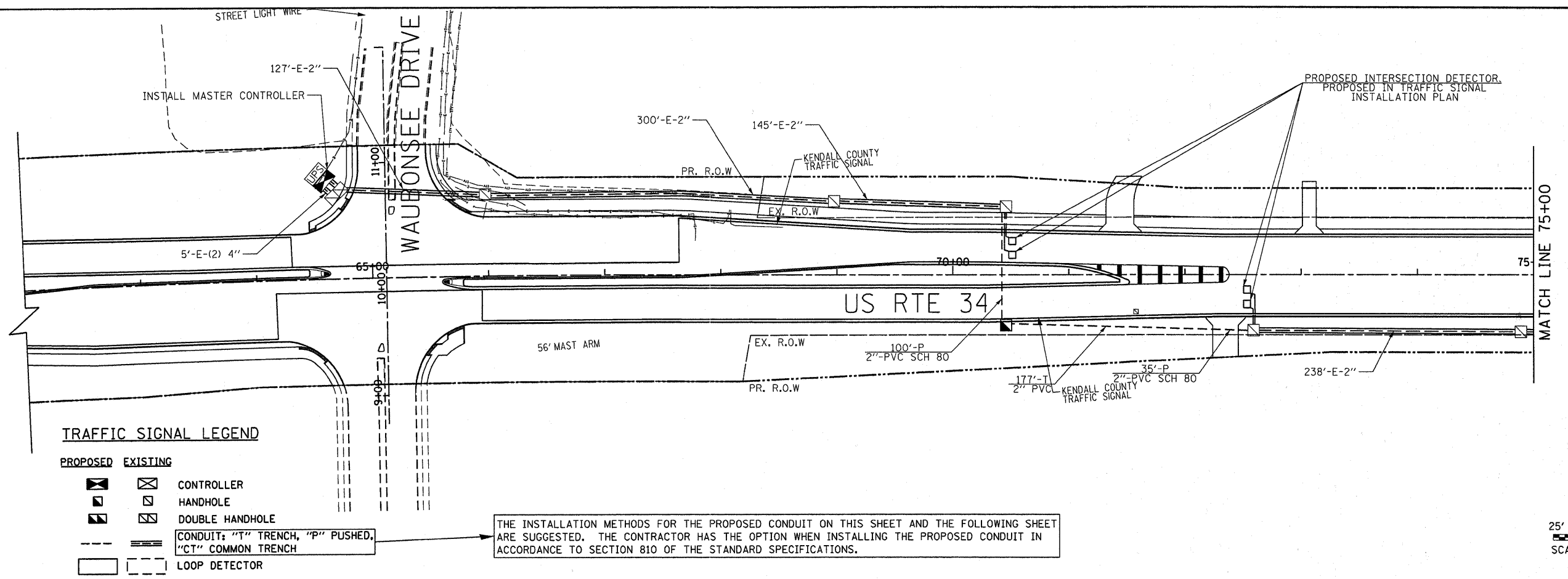

c:\pwwork\purdos\duncanbd\0214252\_0366985-plt-ts-interconnect1-revised.dgn



**TRAFFIC SIGNAL LEGEND**

PROPOSED    EXISTING

- CONTROLLER
- HANDHOLE
- DOUBLE HANDHOLE
- CONDUIT: "T" TRENCH, "P" PUSHED, "CT" COMMON TRENCH
- LOOP DETECTOR

THE INSTALLATION METHODS FOR THE PROPOSED CONDUIT ON THIS SHEET AND THE FOLLOWING SHEET ARE SUGGESTED. THE CONTRACTOR HAS THE OPTION WHEN INSTALLING THE PROPOSED CONDUIT IN ACCORDANCE TO SECTION 810 OF THE STANDARD SPECIFICATIONS.

25' 0 25' 50'  
 SCALE: 1" = 50'

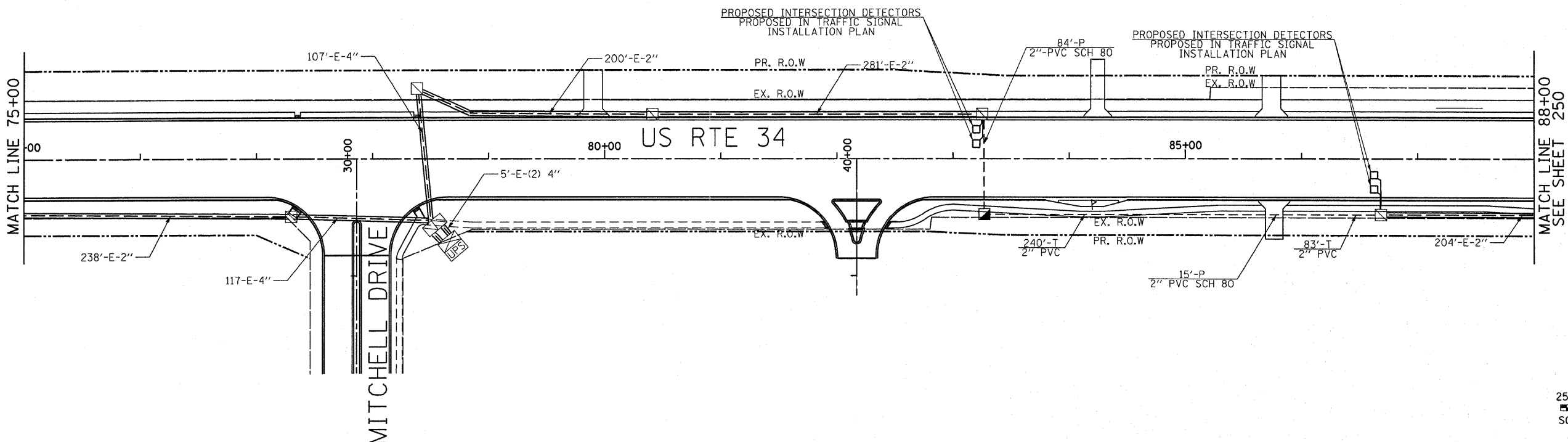

25' 0 25' 50'  
 SCALE: 1" = 50'

**PB Americas, Inc.**  
 230 WEST MONROE STREET,  
 SUITE 900  
 CHICAGO, IL 60606  
 (312) 782-8150

FILE NAME = duncanbd	DESIGNED - GR	REVISED - BDD 09/26/2011
DRAWN - GR	CHECKED - BS	DATE - 4/8/2011
PLT SCALE = 50.0000' / 1" =		
PLT DATE = 9/27/2011		

**STATE OF ILLINOIS  
 DEPARTMENT OF TRANSPORTATION**

**PROPOSED TRAFFIC SIGNAL INTERCONNECT PLAN  
 US 34**

SCALE: 1"=50' SHEET NO. 1 OF 2 SHEETS STA. TO STA.

F.A.P. RTE.	SECTION	COUNTY	TOTAL SHEETS	SHEET NO.
591	13R-2;14R-1 & BR-1(1);15R-1	KENDALL	429	249
CONTRACT NO. 66985			ILLINOIS FED. AID PROJECT	