

EJM ENGINEERING, INC.
 411 South Wells Street Suite 800
 Chicago, Illinois 60607

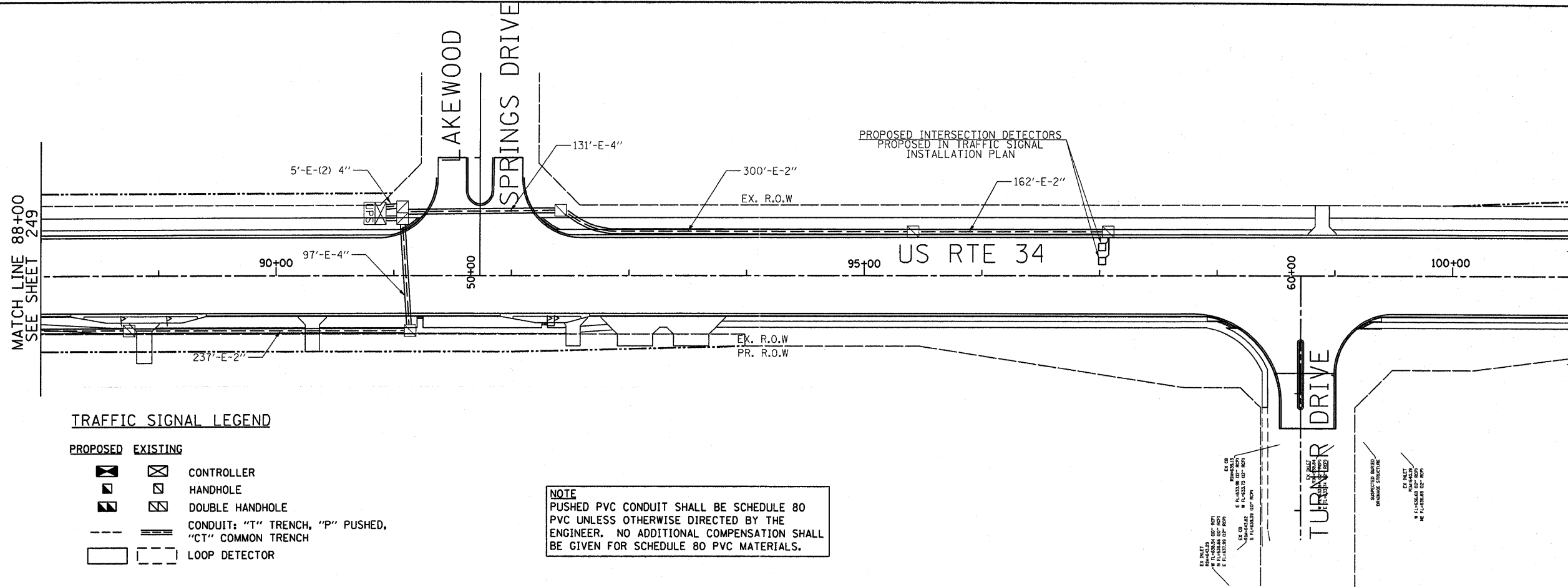

c:\p\work\k\purdot\duncenbd\0214252_0366985-plt-ts-intarconnect2-revised.dgn



TRAFFIC SIGNAL LEGEND

- | | | |
|--|--|---|
| | | CONTROLLER |
| | | HANDHOLE |
| | | DOUBLE HANDHOLE |
| | | CONDUIT: "T" TRENCH, "P" PUSHED, "CT" COMMON TRENCH |
| | | LOOP DETECTOR |

NOTE
 PUSHED PVC CONDUIT SHALL BE SCHEDULE 80 PVC UNLESS OTHERWISE DIRECTED BY THE ENGINEER. NO ADDITIONAL COMPENSATION SHALL BE GIVEN FOR SCHEDULE 80 PVC MATERIALS.

25' 0 25' 50'
 SCALE: 1" = 50'

CABLE PLAN LEGEND

- | | | |
|--|--|---|
| | | MASTER CONTROLLER |
| | | CONTROLLER CABINET |
| | | VEHICLE DETECTOR, INDUCTION LOOP |
| | | DENOTES NUMBER OF CONDUCTORS, ALL CABLE NO. 14 EXCEPT AS INDICATED. ALL LOOP DETECTOR CABLE TO BE SHIELDED. |
| | | TRACER CABLE, NO. 14 1C |
| | | FIBER OPTIC CABLE IN CONDUIT, NO. 62.5/125 MM12F & SM12F |

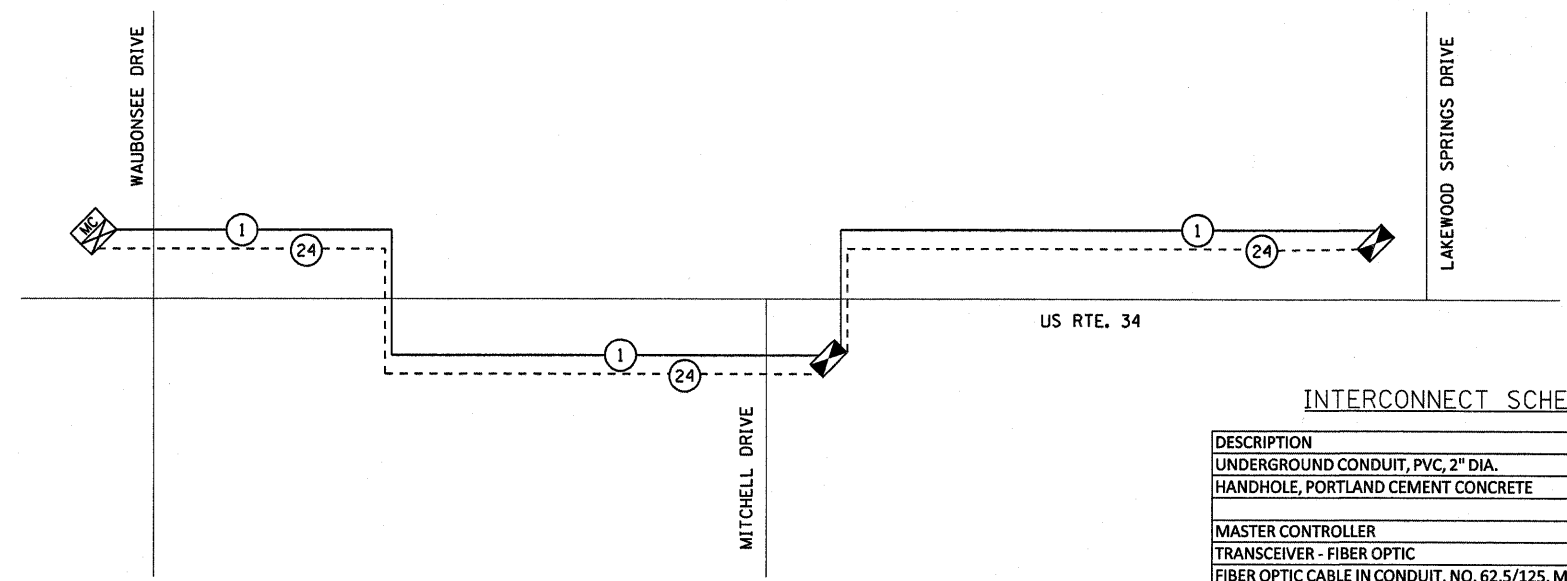

INTERCONNECT SCHEDULE OF QUANTITIES

DESCRIPTION	UNIT	QUANTITY
UNDERGROUND CONDUIT, PVC, 2" DIA.	FOOT	734
HANDHOLE, PORTLAND CEMENT CONCRETE	EACH	2
MASTER CONTROLLER	EACH	1
TRANSCEIVER - FIBER OPTIC	EACH	2
FIBER OPTIC CABLE IN CONDUIT, NO. 62.5/125, MM12F SM12F	EACH	3253
ELECTRIC CABLE IN CONDUIT, SIGNAL NO. 14 1C	FOOT	3189
OPTIMIZE TRAFFIC SIGNAL SYSTEM	FOOT	1
TEMPORARY WIRELESS INTERCONNECT, COMPLETE	FOOT	1
RE-OPTIMIZE TEMPORARY TRAFFIC SIGNAL SYSTEM	FOOT	1

NOT TO SCALE

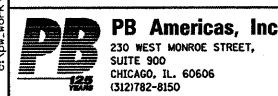

FILE NAME = dunoenbd	DESIGNED - GR	REVISED - BDD 09/26/2011
PLOT SCALE = 50.0000' / 1"	DRAWN - GR	REVISED -
PLOT DATE = 9/27/2011	CHECKED - BS	REVISED -
	DATE - 4/8/2011	REVISED -

**STATE OF ILLINOIS
 DEPARTMENT OF TRANSPORTATION**

**PROPOSED TRAFFIC SIGNAL INTERCONNECT & SCHEMATIC
 US 34**

SCALE: 1"=50' SHEET NO. 2 OF 2 SHEETS STA. TO STA.

F.A.P. RTE.	SECTION	COUNTY	TOTAL SHEETS	SHEET NO.
591	13R-2;14R-1 & BR-1(I);15R-1	KENDALL	429	250
				CONTRACT NO. 66985
ILLINOIS FED. AID PROJECT FINAL SUBMITTAL				