

GENERAL NOTES

Reinforcement bars shall conform to the requirements of ASTM A 706, Grade 60.
 Reinforcement bars designated (E) shall be epoxy coated.
 The Contractor is responsible for the design and performance of the lagging using no less than a 3" nominal rough-sawn thickness and timber with a minimum allowable bending stress of 1000 psi.
 Prior to commencing work, the Contractor shall verify the location of all existing utilities. Work shall be completed in such a manner so as not to disturb or damage the existing utilities.

INDEX OF SHEETS

- 1 General Plan and Elevation
- 2 General Data
- 3-5 Plan and Elevation
- 6-7 Sections and Details
- 8 Parapet Railing
- 9 HP Pile Details
- 10-13 Soil Boring Logs

TOTAL BILL OF MATERIAL

ITEM	UNIT	QUANTITY
Concrete Structures	Cu. Yd.	123.7
Protective Coat	Sq. Yd.	301
Form Liner Textured Surface	Sq. Ft.	2585
Stud Shear Connectors	Each	314
Reinforcement Bars, Epoxy Coated	Pound	14230
Parapet Railing	Foot	319
Name Plates	Each	1
Geocomposite Wall Drain	Sq. Yd.	153
Pipe Underdrains for Structures 4"	Foot	318
Concrete Gutter, Type B	Foot	319
Driving Soldier Piles	Foot	1376
Untreated Timber Lagging	Sq. Ft.	1935
Furnishing Soldier Piles (HP Section)	Foot	1376

Note: Excavation and Backfill quantities are included with Roadway quantities.

WORK POINTS & WALL ELEVATION

WP No.	Station	Offset Left Ft.	Top/Wall Elev.	Bot./Wall Elev.
1	13+70.00	32.58	639.66	635.58
2	13+87.58	32.58	640.67	634.88
3	14+17.32	32.58	642.37	633.70
3	14+17.32	32.58	642.37	632.87
4	14+47.07	32.58	641.16	631.66
5	14+76.81	32.58	639.95	630.45
6	15+06.54	32.58	638.74	629.24
6	15+06.54	32.58	638.74	628.41
7	15+36.29	32.58	637.53	627.20
8	15+66.03	32.58	636.33	625.99
9	15+95.77	32.58	635.12	624.79
9	15+95.77	32.58	635.12	624.12
10	16+25.52	32.58	633.91	622.91
11	16+55.26	32.58	632.70	621.70
12	16+85.00	32.58	624.57	620.49

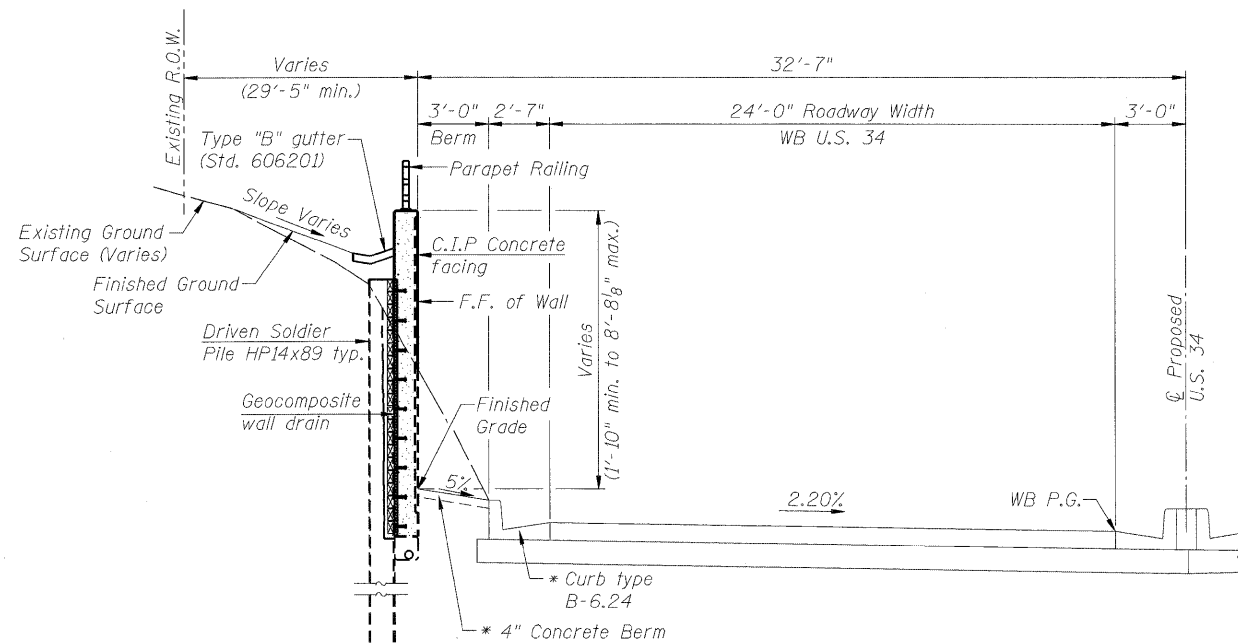

TYPICAL WALL SECTION

(Looking East)

* See Roadway Plans

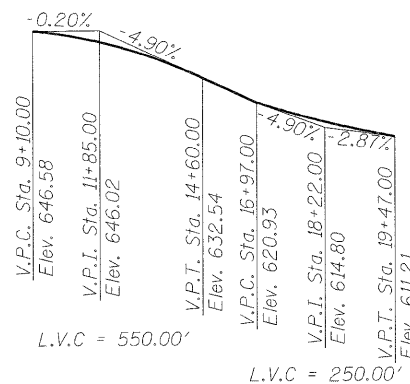

PROFILE GRADE

(along centerline of U.S. Rte. 34)

STATION 13+70.00 TO 16+85.00
 BUILT 20__ BY
 STATE OF ILLINOIS
 F.A.P. RTE. 591 SEC. 14R-1
 STRUCTURE NO. 047-8800

NAME PLATE

See Std. 515001

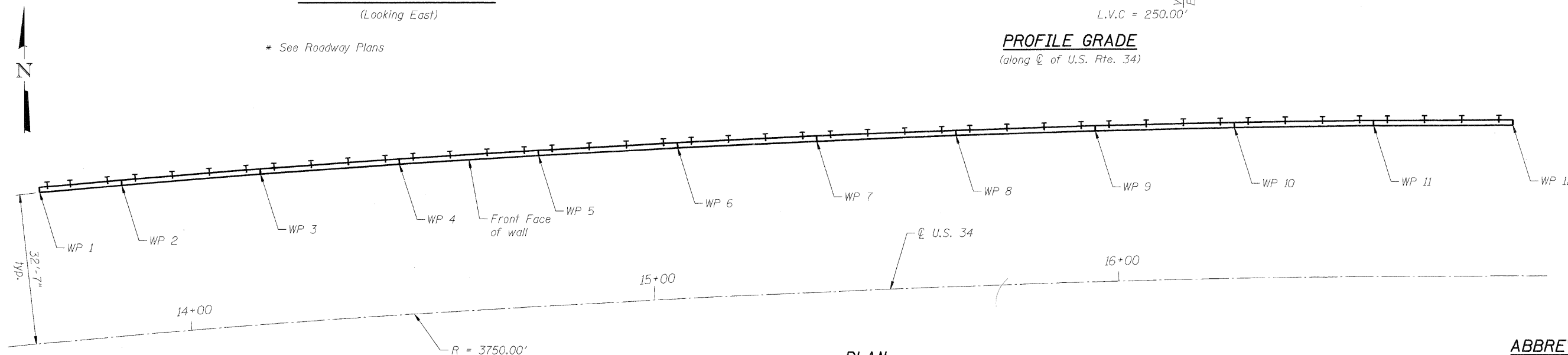

PLAN

(Work point location)

Note:
 Wall to be built along straight chords
 between adjacent construction joints
 & expansion joints.

ABBREVIATIONS

- E.F. Each Face
- N.F. Near Face
- F.F. Front Face
- B.F. Back Face
- WP Work Point

T:\16928-PrairiePkwy-Ph2\Struct\Cadd\Prefinal\US54 Retaining Wall 10478800-66985-002-DAT.dgn
 05-MAY-2011 10:31

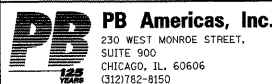

FILE NAME = 0478802-66985-002-DAT.dgn
 PLOT SCALE = NONE
 PLOT DATE = 5/5/2011

DESIGNED - Y. AII
 CHECKED - M. Shaikh
 DRAWN - H. Alkhatib
 CHECKED - J. GRAINAWI

REVISED -
 REVISED -
 REVISED -
 REVISED -

STATE OF ILLINOIS
 DEPARTMENT OF TRANSPORTATION

GENERAL DATA
 STRUCTURE NO. 047-8800

SHEET NO. 2 OF 13 SHEETS

F.A.P. RTE.	SECTION	COUNTY	TOTAL SHEETS	SHEET NO.
591	13R-2;14R-1 & BR-1(1);15R-1	KENDALL	429	295

CONTRACT NO. 66985
 ILLINOIS/FED. AID PROJECT