

FINAL SURVEY	BY	DATE
PLOTTED		
NOTE BOOK		
AREAS CHECKED		
NO.		

ORIGINAL SURVEY	BY	DATE
PLOTTED		
NOTE BOOK		
AREAS CHECKED		
NO.		

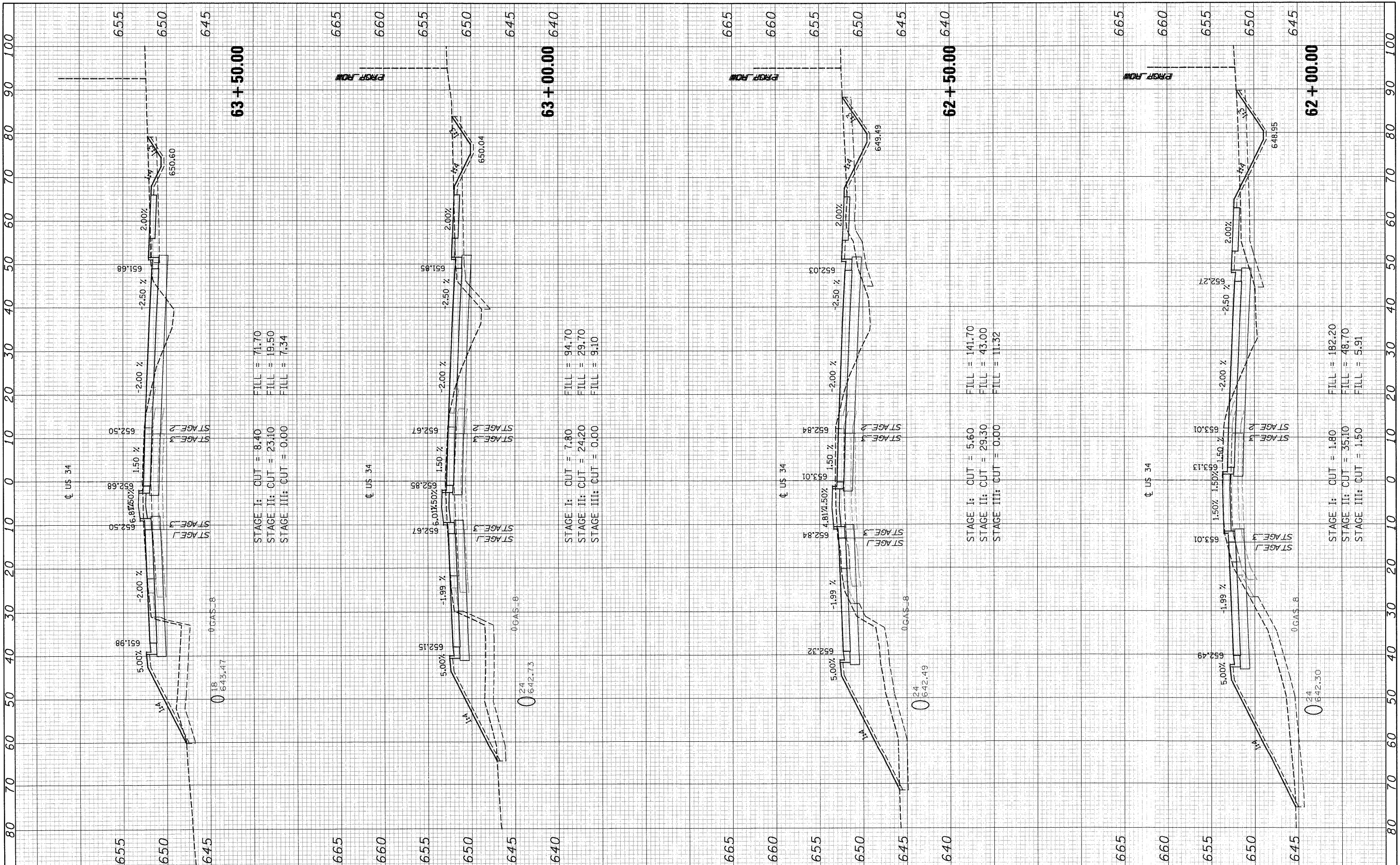

STAGE I: CUT = 8.40  
 STAGE II: CUT = 23.10  
 STAGE III: CUT = 0.00

STAGE I: CUT = 7.80  
 STAGE II: CUT = 24.20  
 STAGE III: CUT = 0.00

STAGE I: CUT = 5.60  
 STAGE II: CUT = 29.30  
 STAGE III: CUT = 0.00

STAGE I: CUT = 1.80  
 STAGE II: CUT = 35.10  
 STAGE III: CUT = 1.50

FILE NAME = T:\16829-PrariePkwy-Ph2\Civ1\Plans\Xshs\US34\sheet-FINAL-plotting.dgn	USER NAME = MMS	DESIGNED - MMS	REVISED -	<b>STATE OF ILLINOIS</b> <b>DEPARTMENT OF TRANSPORTATION</b>	<b>US ROUTE 34 CROSS SECTIONS</b>		F.A.P. RTE. 591	SECTION 13R-2;14R-1 & BR-1(1);15R-1	COUNTY KENDALL	TOTAL SHEETS 429	SHEET NO. 396	
PLOT SCALE =	PLOT DATE = 19-AUG-2011 08:52	DRAWN - MMS	REVISED -		SCALE:	SHEET NO. 53 OF 86 SHEETS	STA. 62+00.00 TO STA. 63+00.00	CONTRACT NO. 66985		ILLINOIS FED. AID PROJECT		
		CHECKED - KJB	REVISED -									
		DATE - 08-18-2011	REVISED -									