

DATE	
BY	
SURVEY NO.	
REVISIONS	
DATE	
BY	
DESCRIPTION	
NO.	

DATE	
BY	
SURVEY NO.	
REVISIONS	
DATE	
BY	
DESCRIPTION	
NO.	

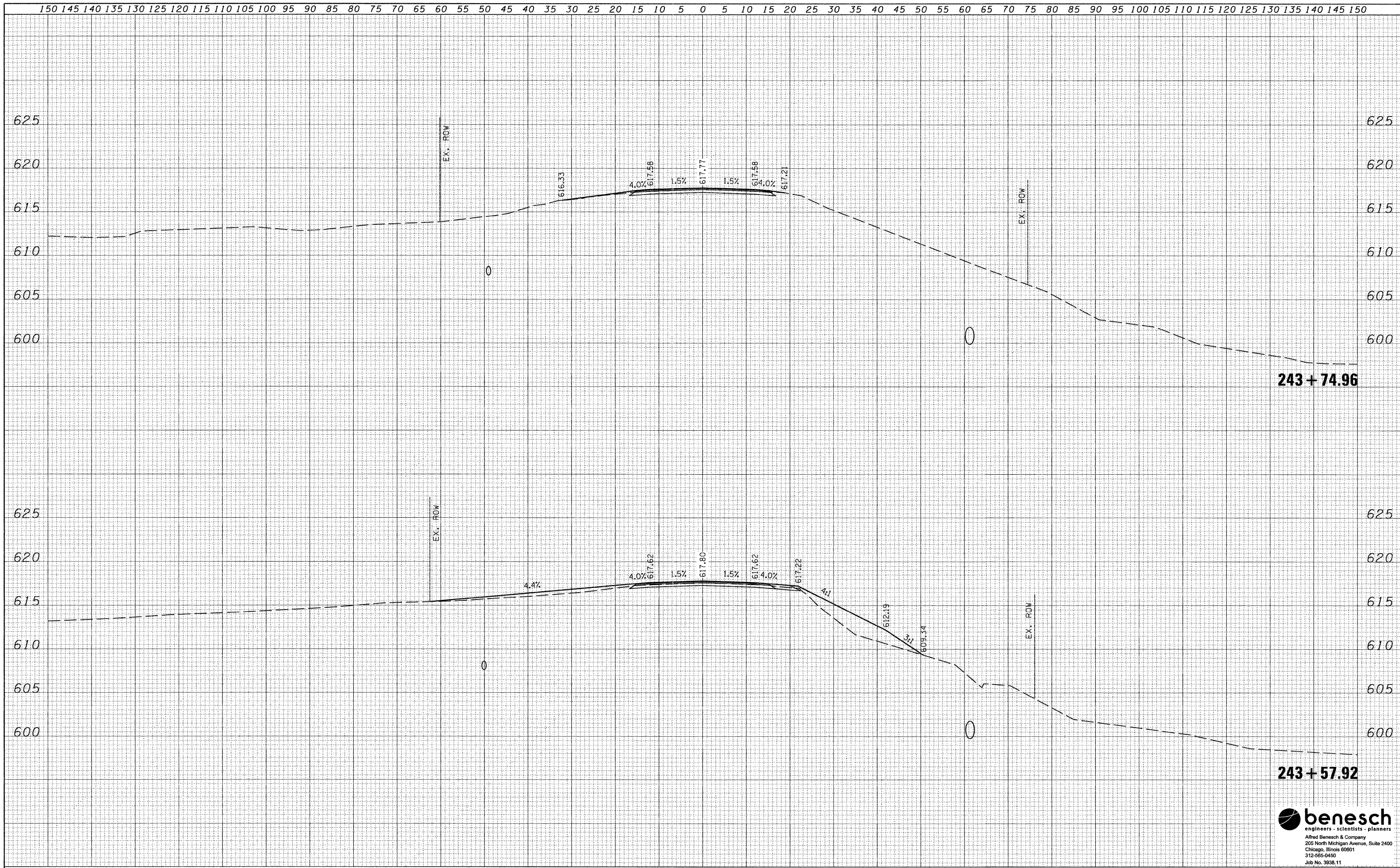

benesch
 engineers - scientists - planners
 Alfred Benesch & Company
 205 North Michigan Avenue, Suite 2400
 Chicago, Illinois 60601
 312-565-0450
 Job No. 9838.11

FILE NAME = ...D366A28-cross-sections.dgn	USER NAME = tblank	DESIGNED - AE	REVISED -	STATE OF ILLINOIS DEPARTMENT OF TRANSPORTATION	CROSS SECTIONS IL 23			F.A.P. RTE. 68	SECTION (3)BR-3	COUNTY LASALLE	TOTAL SHEETS 61	SHEET NO. 59
	PLOT SCALE =	DRAWN - TMB	REVISED -		SCALE:	SHEET NO. 9 OF 11 SHEETS	STA. 243+57.92 TO STA. 243+74.96	CONTRACT NO. 66A20		ILLINOIS FED. AID PROJECT		
	PLOT DATE = 10/20/11	CHECKED - JMM	REVISED -									
		DATE - 10/20/11	REVISED -									