

GENOA

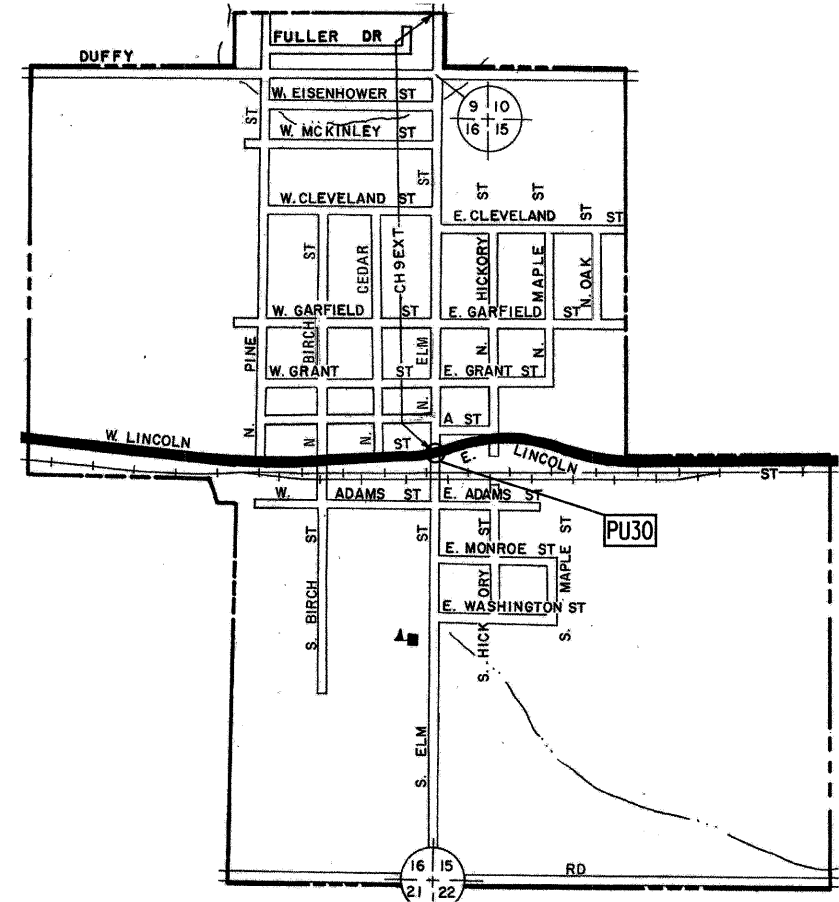

WATERMAN

**LEGEND NOTES**

- I = INTERSECTION WILL BE RETROFITTING INCANDESCENT BULBS WITH LEDS AND IF NEEDED INSTALLING UNINTERRUPTABLE POWER SUPPLY UNIT, AND PEDESTRIAN COUNTDOWN HEADS
- P = INTERSECTION WILL BE REPLACING EXISTING FLASHING PEDESTRIAN HEADS WITH COUNTDOWN PEDESTRIAN HEADS
- U = INTERSECTION WILL BE INSTALLING UNINTERRUPTABLE POWER SUPPLY UNIT
- PU = INTERSECTION WILL BE INSTALLING UNINTERRUPTABLE POWER SUPPLY UNIT AND REPLACING EXISTING FLASHING PEDESTRIAN HEADS WITH COUNTDOWN PEDESTRIAN HEADS AND IF NEEDED PEDESTRIAN ADA PUSH BUTTONS
- E = INTERSECTION WILL BE REPLACING 8" SIGNAL HEADS WITH 12" SIGNAL HEADS

**LEGEND**

- PU30 - US 30 & ELM STREET
- I18 - IL 72 & WASHINGTON STREET
- I19 - IL 72 & SYCAMORE STREET
- U10 - IL 23 & IL 72 (MAIN STREET)

FILE NAME = 0366854-SHT-LOCATION-MAPS.DGN

USER NAME = --

DESIGNED - --

REVISED - ---

PLOT SCALE = N/A

DRAWN - ARR/NV

REVISED - ---

PLOT DATE = 10/11

CHECKED - JKC

REVISED - ---

DATE - 10/11

REVISED - ---

STATE OF ILLINOIS  
DEPARTMENT OF TRANSPORTATION

INTERSECTION LOCATION MAP  
GENOA AND WATERMAN

SCALE: N/A

SHEET NO. \_\_\_ OF \_\_\_ SHEETS

STA. \_\_\_\_\_ TO STA. \_\_\_\_\_

F.A. RTE.	SECTION	COUNTY	TOTAL SHEETS	SHEET NO.
---	D-3 LED RETROFIT 2012-1	DEKALB	41	6
CONTRACT NO. 66B54				
ILLINOIS FED. AID PROJECT				