

ELECTRICAL LOAD FOR INTERSECTION				
STREET NAME	COMPONENT	NUMBER	WATTAGE EACH	BURNTIME %
US 34	RED	4	7	35
	YELLOW	4	12	5
	GREEN	4	9.5	60
INDIAN SPRINGS MALL	RED	2	7	60
	YELLOW	2	12	5
	GREEN	2	9.5	35
TRAFFIC SIGNAL CABINET	CONTROLLER	1	6	100
	UPS	1	50	100

THERE MAY BE ADDITIONAL ELECTRICAL LOADS DUE TO LIGHTING AND EMERGENCY VEHICLE DETECTION EQUIPMENT.
 AGENCY RESPONSIBLE FOR TRAFFIC SIGNAL ENERGY CHARGES:
 CITY OF SANDWICH

CONSTRUCTION NOTES:

- MODIFY EXISTING CONTROLLER CABINET.
- INSTALL UNINTERRUPTABLE POWER SUPPLY.
- RETROFIT THE SIX (6) 3-SECTION HEADS WITH LED SIGNAL HEADS.

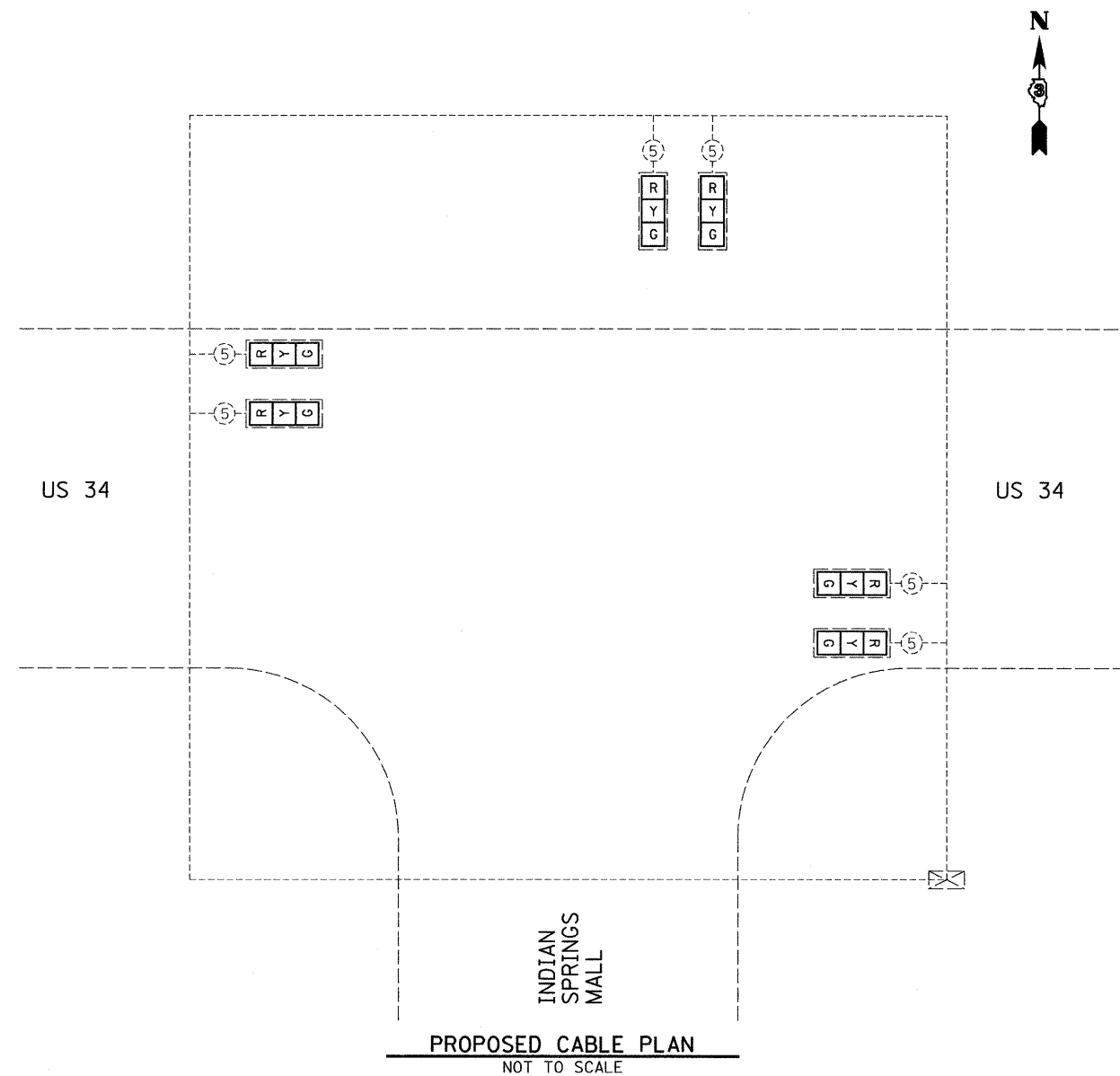

SCHEDULE OF QUANTITIES (95% STATE / 5% CITY)

SANDWICH US 34 & INDIAN SPRINGS MALL				
ITEM NO.	DESCRIPTION	UNIT	TOTAL QUANTITY	
86200300	UNINTERRUPTABLE POWER SUPPLY, EXTENDED	EACH	1	
89502210	MODIFY EXISTING CONTROLLER CABINET	EACH	1	
Z0033002	LED SIGNAL FACE RETROFIT, RED BALL	EACH	6	
Z0033004	LED SIGNAL FACE RETROFIT, GREEN BALL	EACH	6	
Z0033008	LED SIGNAL FACE RETROFIT, YELLOW BALL	EACH	6	

	DENOTES NUMBER OF EXISTING CONDUCTORS
	EXISTING CONTROLLER AND CABINET
	SIGNAL SECTION 12"
	RETROFIT EXISTING TRAFFIC SIGNAL WITH LED HEADS

FILE NAME = D366B54-SHT-TS-CABLE-SANDWICH-US34-INDIAN-SPRINGS.DGN

USER NAME = --

DESIGNED - --

REVISED - ---

PLOT SCALE = 1" = 20'

DRAWN - ARR/NV

REVISED - ---

PLOT DATE = 10/11

CHECKED - JKC

REVISED - ---

DATE - 10/11

REVISED - ---

STATE OF ILLINOIS
 DEPARTMENT OF TRANSPORTATION

TRAFFIC SIGNAL CABLE PLAN
 SANDWICH - US 34 & INDIAN SPRINGS MALL

F.A. RTE. ---

SECTION

COUNTY

TOTAL SHEETS

SHEET NO.

D-3 LED RETROFIT 2012-1

DEKALB

41

31

CONTRACT NO. 66B54

SCALE: 1" = 20'

SHEET NO. ___ OF ___ SHEETS

STA. _____ TO STA. _____

ILLINOIS FED. AID PROJECT