

CURVE: GRANT PROP 1
 PI STA. = 8+58.62
 $\Delta = 12^\circ 14' 33''$ (LT)
 $D = 17^\circ 56' 14''$
 $R = 319.42'$
 $T = 34.26'$
 $L = 68.25'$
 $E = 1.83'$
 P.C. STA = 8+24.36
 P.T. STA = 8+92.61

GRANT STREET

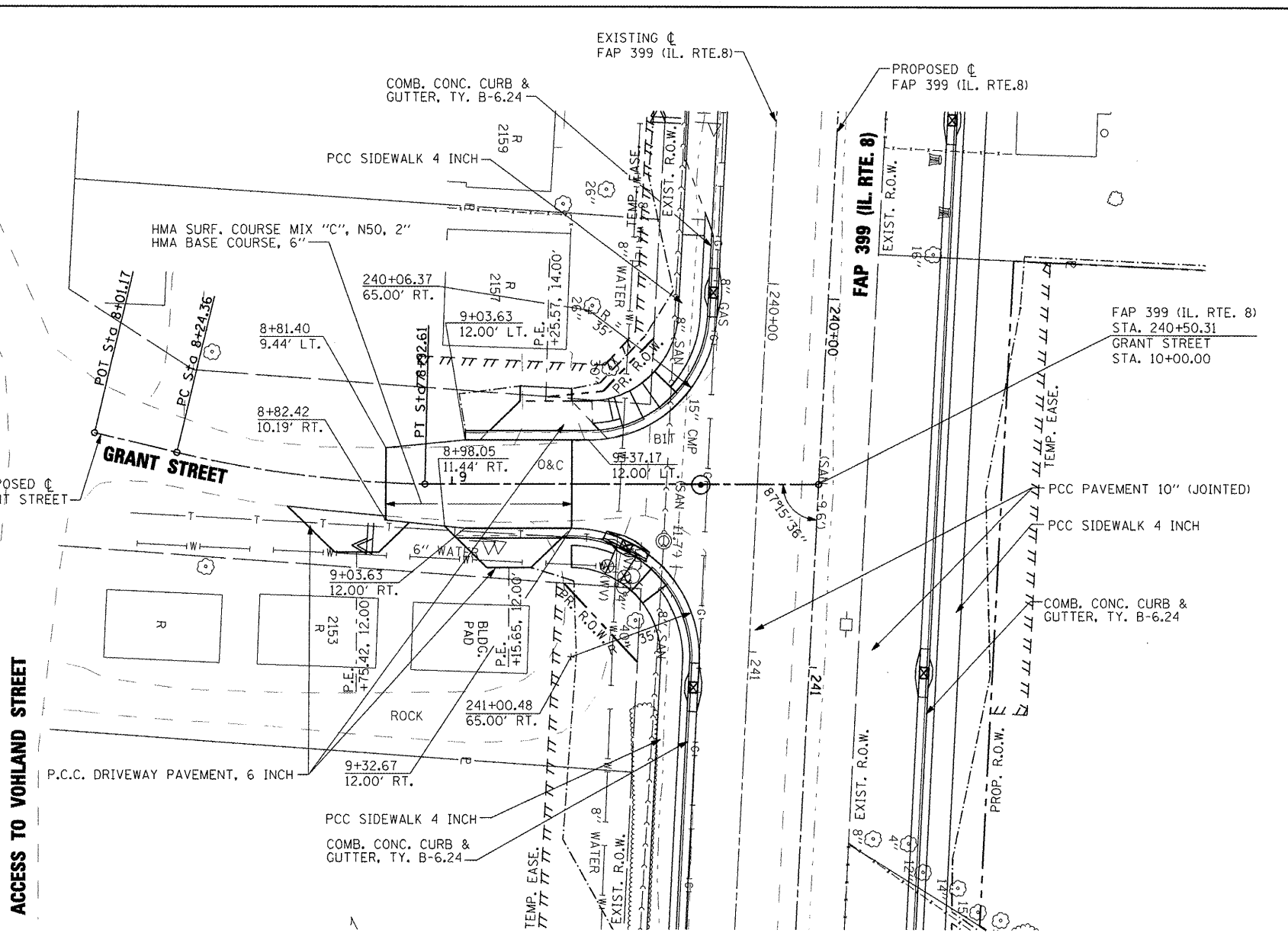

SEE IL. ROUTE 8 PLAN AND PROFILES FOR ADDITIONAL INFORMATION

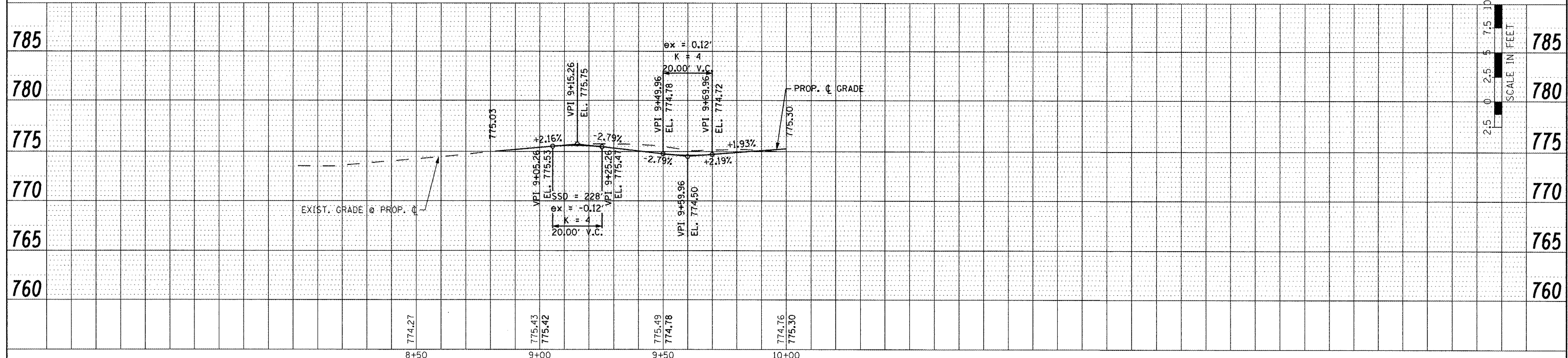
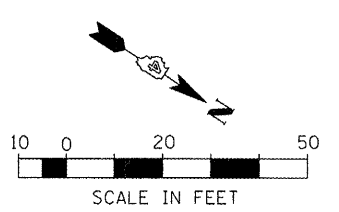

PLAN	DATE
BY	
NO.	
DATE	
BY	
NO.	
DATE	
BY	
NO.	
DATE	
BY	
NO.	
DATE	
BY	
NO.	
DATE	
BY	
NO.	
DATE	
BY	
NO.	
DATE	
BY	
NO.	
DATE	
BY	
NO.	
DATE	
BY	
NO.	
DATE	
BY	
NO.	
DATE	

PROFILE	DATE
BY	
NO.	
DATE	
BY	
NO.	
DATE	
BY	
NO.	
DATE	
BY	
NO.	
DATE	
BY	
NO.	
DATE	
BY	
NO.	
DATE	
BY	
NO.	
DATE	
BY	
NO.	
DATE	
BY	
NO.	
DATE	
BY	
NO.	
DATE	

FILE NAME =	USER NAME = IDOT	DESIGNED -	REVISED -	<p align="center">STATE OF ILLINOIS DEPARTMENT OF TRANSPORTATION</p> <p align="center">FAP 399 (IL. RTE. 8) GRANT STREET - ROADWAY PLAN AND PROFILE</p>	F.A.P. RTE.	SECTION	COUNTY	TOTAL SHEETS	SHEET NO.
x:\projects\200802566\dgn\04-Rte8-sh1-PLN-PRF-Grant.dgn		DRAWN -	REVISED -		399	36 R-7	TAZEWELL	390	69
PLOT SCALE = 40.00' / IN.		CHECKED -	REVISED -		CONTRACT NO. 68370				
PLOT DATE = 10/21/2011		DATE = 10-21-11	REVISED -		ILLINOIS FED. AID PROJECT				
				SCALE: AS SHOWN	SHEET NO.	OF	SHEETS	STA. 8+01.17	TO STA. 10+00.00