

TEMPORARY SOIL RETENTION SYSTEM DETAIL
NOT TO SCALE

TEMPORARY SOIL RETENTION SYSTEM	
LOCATION	AREA
	SQ. FT.
7.5' RT STA 208+83.5 TO 209+09.5	225

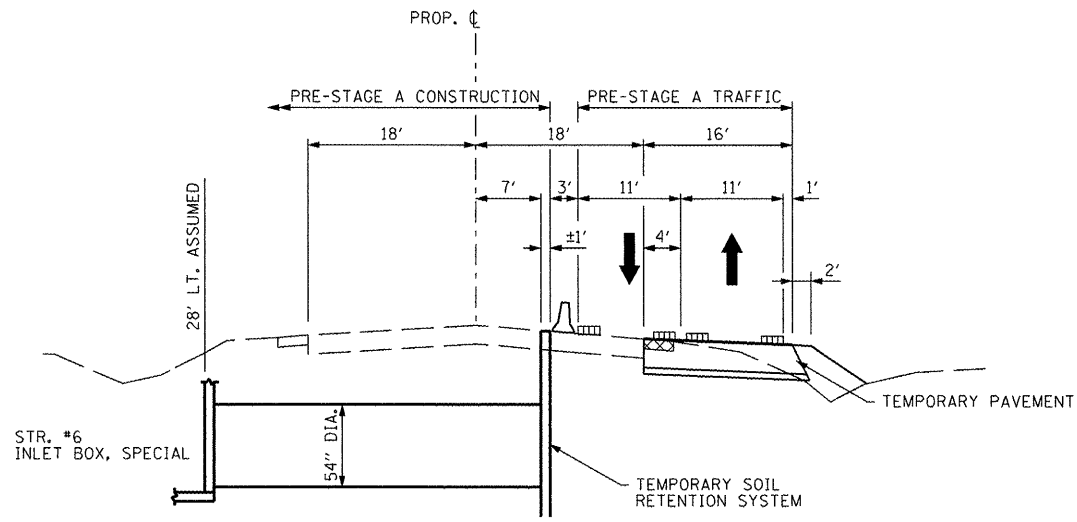

MAINTENANCE OF TRAFFIC CROSS SECTION - PRE-STAGE A
STA. 208+96

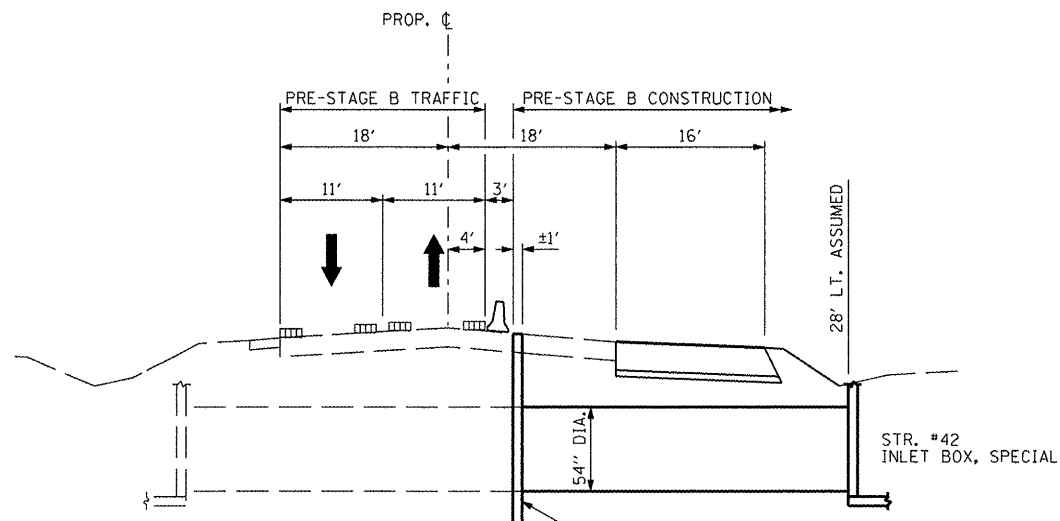

MAINTENANCE OF TRAFFIC CROSS SECTION - PRE-STAGE B
STA. 208+96

LEGEND

- EXISTING PAVEMENT MARKING
- TEMPORARY PAVEMENT MARKING
- PROPOSED PAVEMENT MARKING
- DRUM, WITH STEADY BURNING LIGHT
- TEMPORARY CONCRETE BARRIER
- CONSTRUCTION THIS STAGE
- VERTICAL PANEL WITH STEADY BURNING LIGHT
- EXISTING TRAFFIC LANE IN USE
- TRAFFIC LANE

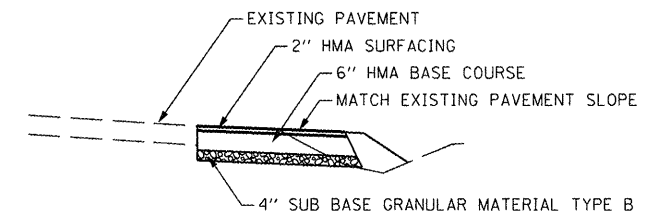

TEMPORARY PAVEMENT DETAIL, HMA OPTION
NOT TO SCALE

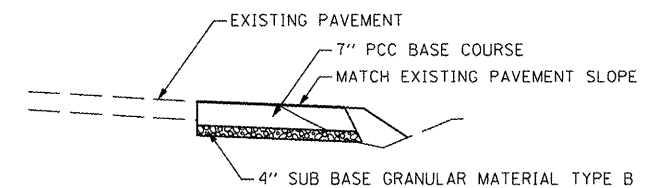

TEMPORARY PAVEMENT DETAIL, PCC OPTION
NOT TO SCALE

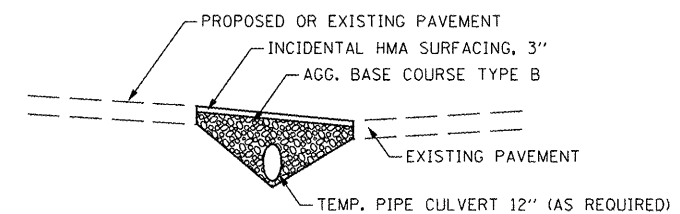

TEMPORARY ACCESS TO SIDE STREETS
NOT TO SCALE

NOTE:
SEE SHEET 31 FOR SCHEDULE

FILE NAME =	USER NAME = ID07	DESIGNED -	REVISED -
x:\projects\200803566\dgn\04-Rte8-shr-S	aging-Typ-1-1.dgn	DRAWN -	REVISED -
		CHECKED -	REVISED -
		DATE - 10-21-11	REVISED -

**STATE OF ILLINOIS
DEPARTMENT OF TRANSPORTATION**

**FAP 399 (IL. RTE. 8)
MAINT. OF TRAFFIC - TYP. SECT. PRE-STAGE & SOIL RETENTION SYSTEM**

SCALE: AS SHOWN SHEET NO. OF SHEETS STA. TO STA.

F.A.P. RTE.	SECTION	COUNTY	TOTAL SHEETS	SHEET NO.
399	36 R-7	TAZEWELL	390	77
CONTRACT NO. 68370			ILLINOIS FED. AID PROJECT	