

MATCH LINE STA. 206+00.00

MATCH LINE STA. 212+00.00

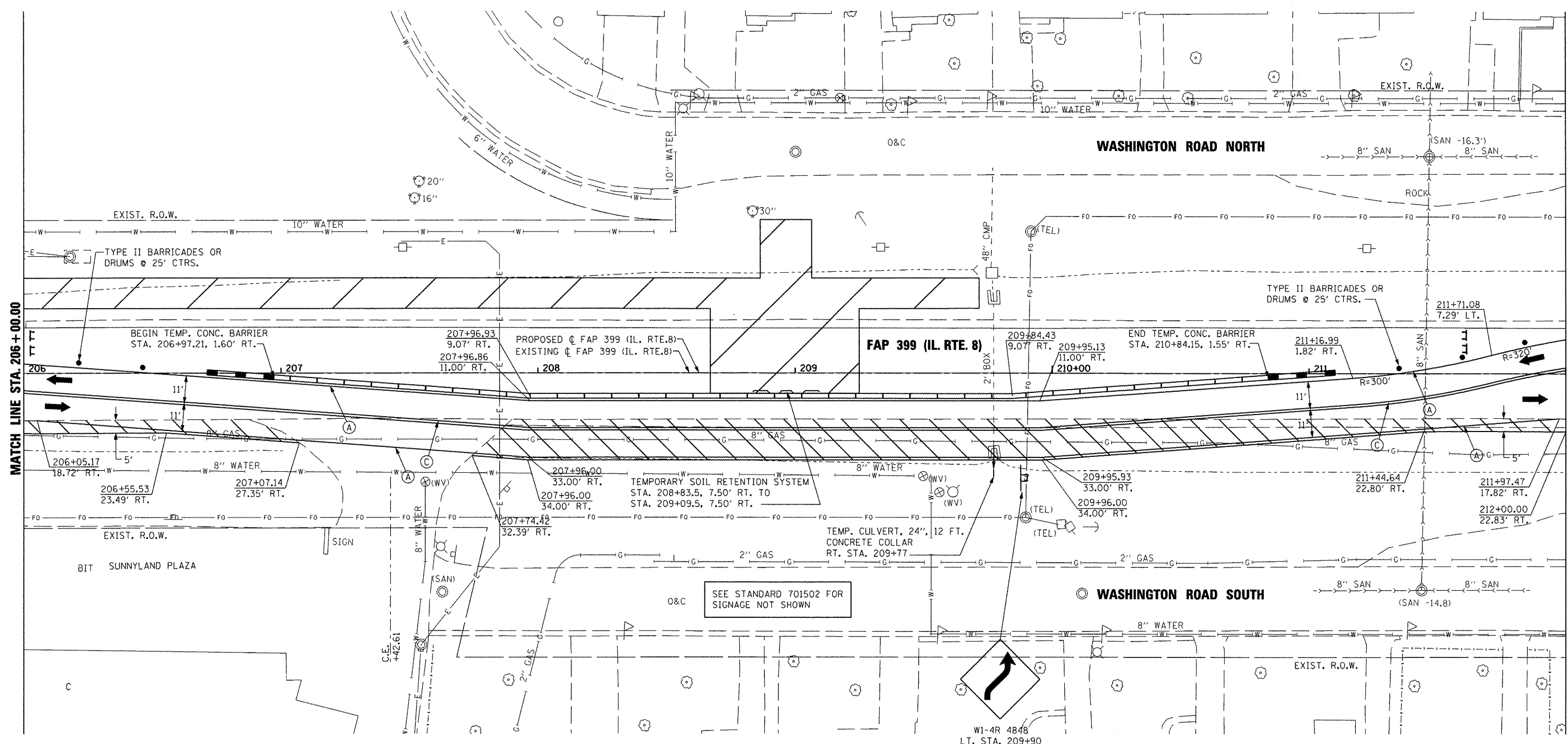

NOTE: TEMPORARY CONCRETE BARRIER LOCATIONS ARE SHOWN AT ϕ OF WALL.

TEMPORARY PAVEMENT MARKING LEGEND

| | | | |
|--|--|--|---------------------------------------|
| (A) TEMP. PAVE. MARK. - 4" WHITE SOLID | (I) PAVE. MARK. TAPE - 4" WHITE SOLID | | CONSTRUCTION THIS STAGE |
| (B) TEMP. PAVE. MARK. - 4" YELLOW SOLID | (J) PAVE. MARK. TAPE - 4" YELLOW SOLID | | |
| (C) TEMP. PAVE. MARK. - DOUBLE 4" YELLOW SOLID | (K) PAVE. MARK. TAPE - DOUBLE 4" YELLOW SOLID | | TEMPORARY PAVEMENT |
| (D) TEMP. PAVE. MARK. - 4" YELLOW SKIP DASH | (L) PAVE. MARK. TAPE - 4" YELLOW SKIP DASH | | EXISTING TRAFFIC LANE TRAFFIC LANE |
| (E) TEMP. PAVE. MARK. - 8" WHITE SOLID | (M) PAVE. MARK. TAPE - 8" WHITE SOLID | | TYPE III BARRICADE WITH R 11-2 SIGN |
| (F) TEMP. PAVE. MARK. - 8" WHITE SKIP DASH | (N) PAVE. MARK. TAPE - 8" WHITE SKIP DASH | | |
| (G) TEMP. PAVE. MARK. - 24" WHITE SOLID (STOP BAR) | (O) PAVE. MARK. TAPE - 12" YELLOW SOLID (DIAGONAL) | | TEMPORARY IMPACT ATTENUATOR |
| (H) TEMP. PAVE. MARK. - LETTERS AND SYMBOLS | (P) PAVE. MARK. TAPE - 12" WHITE SOLID (DIAGONAL) | | |
| TEMP. PAVE. MARK. = PAINT | (Q) PAVE. MARK. TAPE - 24" WHITE SOLID (STOP BAR) | | |
| | (R) PAVE. MARK. TAPE - LETTERS AND SYMBOLS | | |

PAVE. MARK. TAPE = PAVEMENT MARKING TAPE, TYPE III

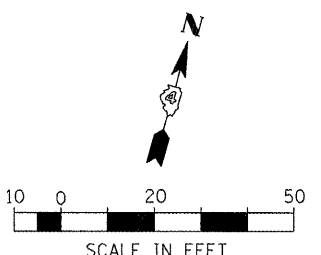

| | | | |
|---|------------------|-----------------|-----------|
| FILE NAME = | USER NAME = IDOT | DESIGNED - | REVISED - |
| x:\projects\200803566\dgn\04-Rte8-sht-S | loging-PSA-C.dgn | DRAWN - | REVISED - |
| PLOT SCALE = 41.248711 FT / IN. | | CHECKED - | REVISED - |
| PLOT DATE = 10/21/2011 | | DATE - 10-21-11 | REVISED - |

**STATE OF ILLINOIS
DEPARTMENT OF TRANSPORTATION**

**FAP 399 (IL. RTE. 8)
MAINTENANCE OF TRAFFIC - PRE-STAGE A**

SCALE: AS SHOWN SHEET NO. OF SHEETS STA. 206+00.00 TO STA. 212+00.00

| | | | | |
|---------------------------|---------|----------|--------------|-----------|
| F.A.P. RTE. | SECTION | COUNTY | TOTAL SHEETS | SHEET NO. |
| 399 | 36 R-7 | TAZEWELL | 390 | 91 |
| CONTRACT NO. 68370 | | | | |
| ILLINOIS FED. AID PROJECT | | | | |