

ROAD CONSTRUCTION AHEAD
W20-1 4848
LOCATION PER STANDARD

PI STA. = 202+21.64
Δ = 3° 02' 07" (LT)
D = 0° 34' 23"
R = 10,000.00'
T = 264.95'
L = 529.78'
E = 3.51'
P.C. STA. = 199+56.69
P.T. STA. = 204+86.47

EXIST. CURVE IL8EXCL3
PI STA. = 200+32.94
Δ = 3° 02' 07" (LT)
D = 0° 34' 00"
R = 10,111.00'
T = 267.89'
L = 535.66'
E = 3.55'
P.C. STA. = 197+65.05
P.T. STA. = 203+00.71

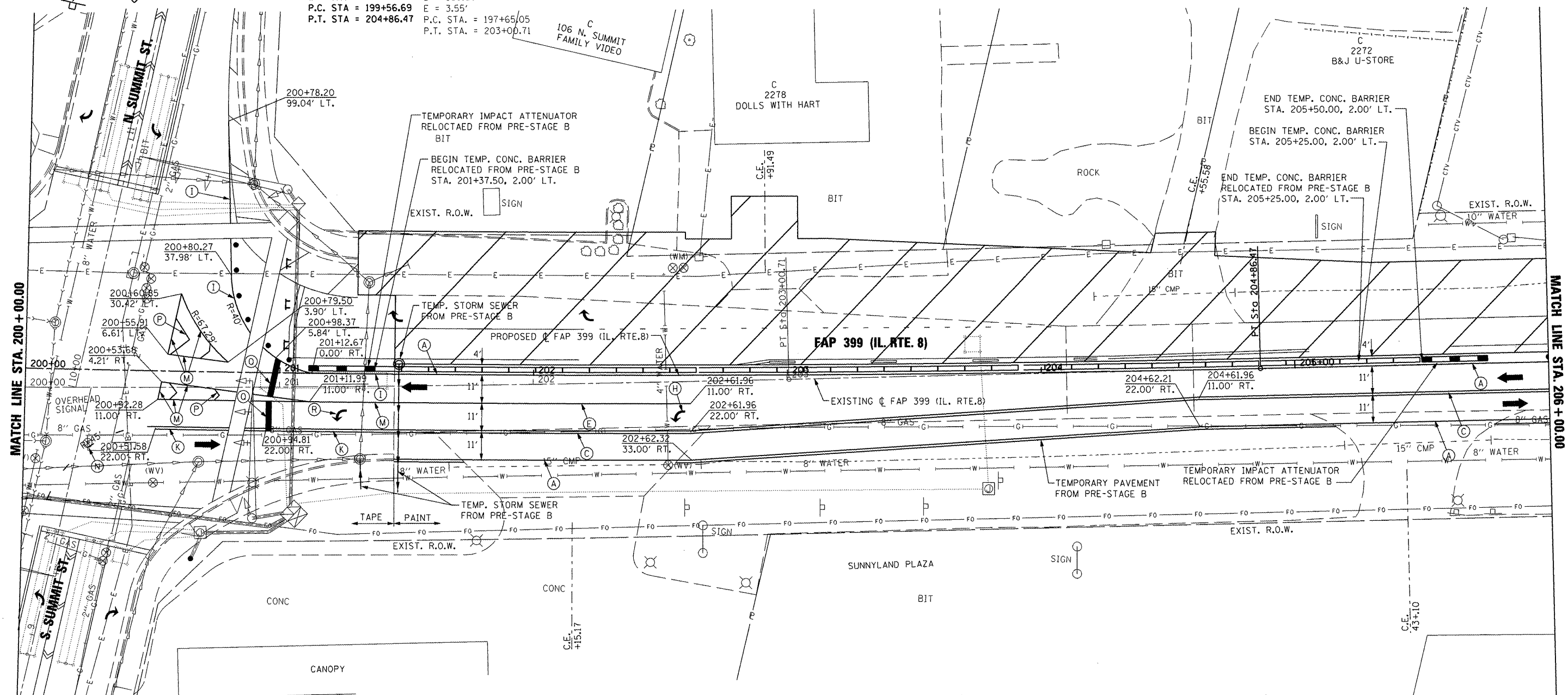

MATCH LINE STA. 200+00.00

MATCH LINE STA. 206+00.00

ROAD CONSTRUCTION AHEAD
W20-1 4848
LOCATION PER STANDARD

NOTE: TEMPORARY CONCRETE BARRIER LOCATIONS ARE SHOWN AT C OF WALL.

TEMPORARY PAVEMENT MARKING LEGEND	
(A) TEMP. PAVE. MARK. - 4" WHITE SOLID	(I) PAVE. MARK. TAPE - 4" WHITE SOLID
(B) TEMP. PAVE. MARK. - 4" YELLOW SOLID	(J) PAVE. MARK. TAPE - 4" YELLOW SOLID
(C) TEMP. PAVE. MARK. - DOUBLE 4" YELLOW SOLID	(K) PAVE. MARK. TAPE - DOUBLE 4" YELLOW SOLID
(D) TEMP. PAVE. MARK. - 4" YELLOW SKIP DASH	(L) PAVE. MARK. TAPE - 4" YELLOW SKIP DASH
(E) TEMP. PAVE. MARK. - 8" WHITE SOLID	(M) PAVE. MARK. TAPE - 8" WHITE SOLID
(F) TEMP. PAVE. MARK. - 8" WHITE SKIP DASH	(N) PAVE. MARK. TAPE - 8" WHITE SKIP DASH
(G) TEMP. PAVE. MARK. - 24" WHITE SOLID (STOP BAR)	(O) PAVE. MARK. TAPE - 12" YELLOW SOLID (DIAGONAL)
(H) TEMP. PAVE. MARK. - LETTERS AND SYMBOLS	(P) PAVE. MARK. TAPE - 12" WHITE SOLID (DIAGONAL)
TEMP. PAVE. MARK. = PAINT	(Q) PAVE. MARK. TAPE - 24" WHITE SOLID (STOP BAR)
	(R) PAVE. MARK. TAPE - LETTERS AND SYMBOLS
	PAVE. MARK. TAPE = PAVEMENT MARKING TAPE, TYPE III

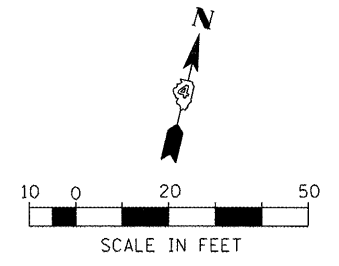

FILE NAME = v:\projects\200803566\dgn\04-Rte8-sht-5.dgn
USER NAME = IDOT
DESIGNED -
DRAWN -
CHECKED -
DATE = 10/21/2011

DESIGNED -
REVISED -
REVISED -
REVISED -
REVISED -

STATE OF ILLINOIS
DEPARTMENT OF TRANSPORTATION

FAP 399 (IL RTE. 8)
MAINTENANCE OF TRAFFIC - STAGE I
SCALE: AS SHOWN SHEET NO. OF SHEETS STA. 200+00.00 TO STA. 206+00.00

F.A.P. RTE. 399	SECTION 36 R-7	COUNTY TAZEWELL	TOTAL SHEETS 390	SHEET NO. 101
ILLINOIS FED. AID PROJECT				CONTRACT NO. 68370