

STRUCTURE #133
STA. 266+10.00, 30.0' LT
INLET, TYPE G-1
RIM ELEV = 801.99
INV ELEV = 798.20 (12" W)
INV ELEV = 798.00 (12" E)

STRUCTURE #134
STA. 267+20.00, 30.8' LT
INLET, TYPE G-1
RIM ELEV = 801.73
INV ELEV = 797.45 (12" W)
INV ELEV = 797.25 (15" E)

STRUCTURE #135
STA. 268+30.00, 32.2' LT
INLET, TYPE G-1
RIM ELEV = 801.47
INV ELEV = 796.70 (15" W)
INV ELEV = 796.50 (15" E)

STRUCTURE #136
STA. 269+27.00, 33.4' LT
INLET-MANHOLE, TYPE G-1, 5' DIA.
RIM ELEV = 801.19
INV ELEV = 797.08 (12" E)
INV ELEV = 796.01 (15" W)
INV ELEV = 792.71 (EXIST 24" S)
INV ELEV = 792.71 (30" N)

STRUCTURE #137
STA. 270+10.00, 34.4 LT
INLET, TYPE G-1
RIM ELEV = 800.99
INV ELEV = 797.49 (12" W)

STRUCTURE #148
STA. 269+27.00, 80.0 LT
PRECAST REINFORCED
CONCRETE END SECTION 30"
INV ELEV = 791.45 (30" S)

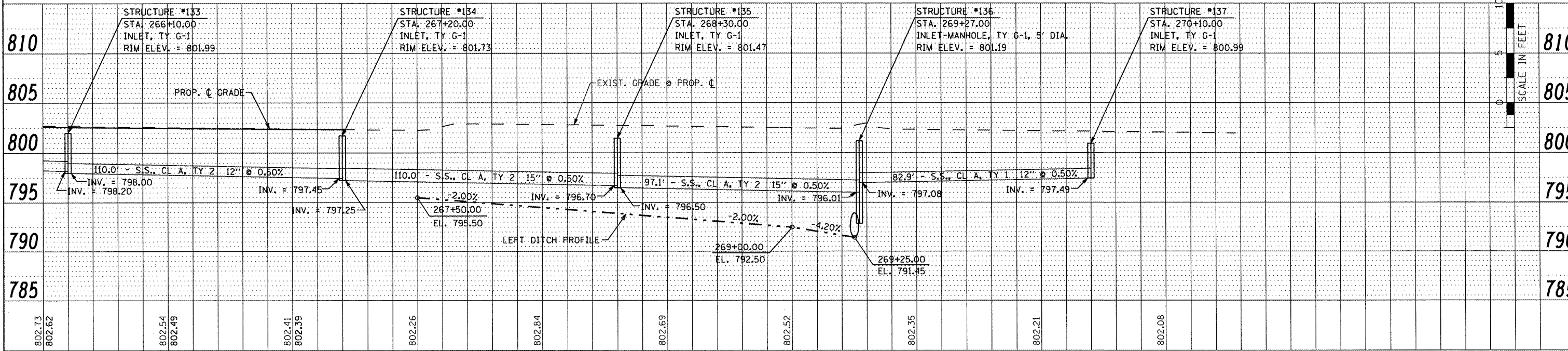
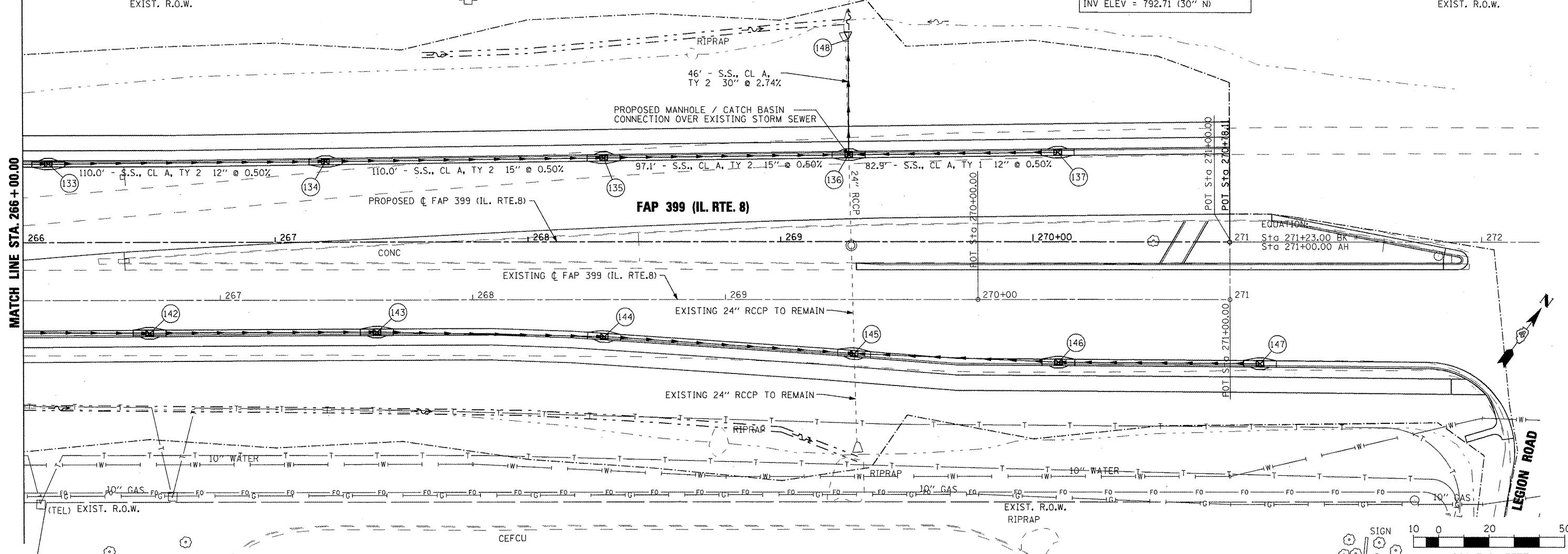

DATE	
BY	
PLAN	
NO.	
DATE	
BY	
PROFILE	
NO.	

DATE	
BY	
PROFILE	
NO.	