

DATE	
BY	
FINAL SURVEY	
NOTED	
PLOTTED	
TEMPLATE	
AREAS CHECKED	
NO.	

DATE	
BY	
ORIGINAL SURVEY	
NOTED	
PLOTTED	
TEMPLATE	
AREAS CHECKED	
NO.	

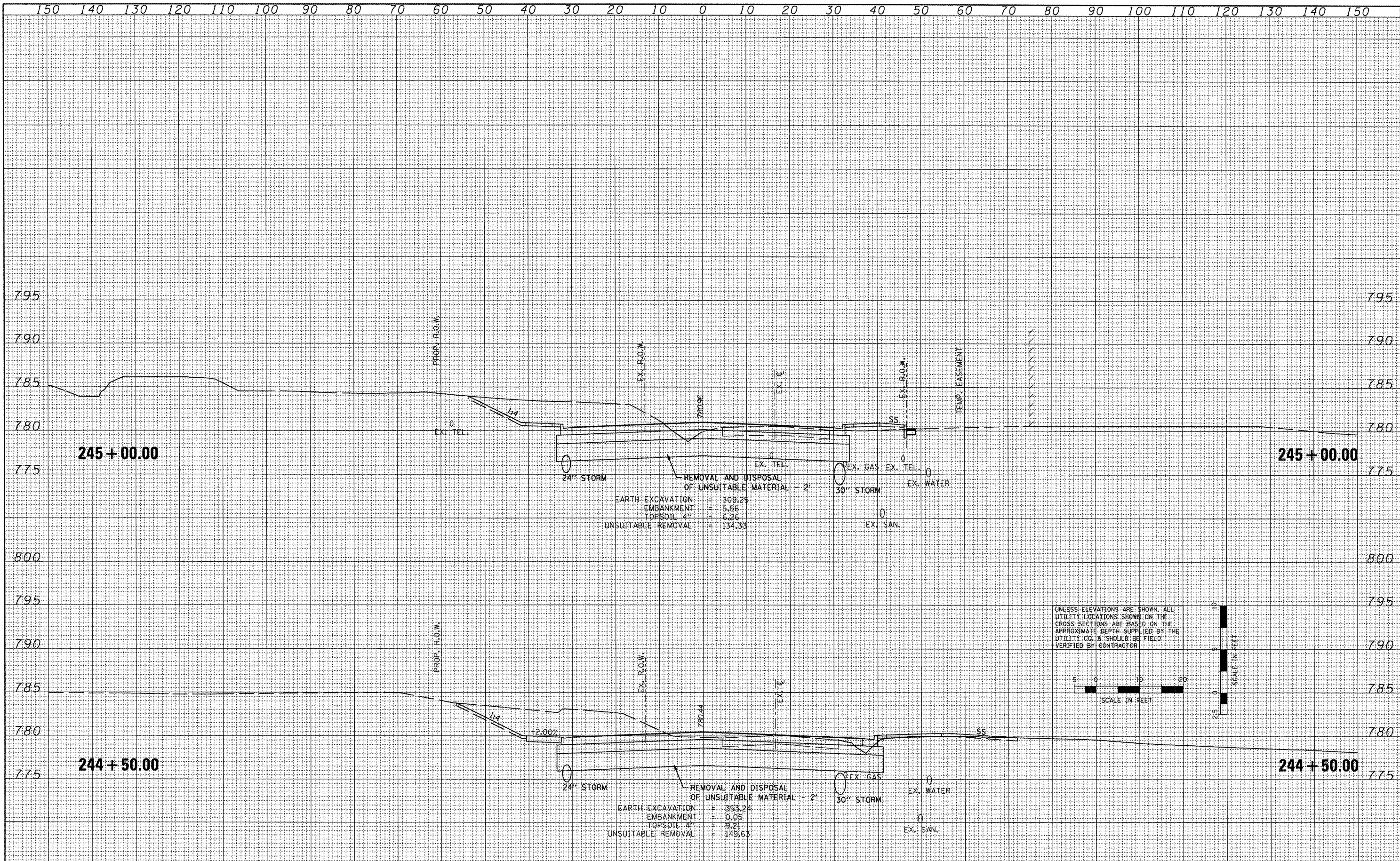

REMOVAL AND DISPOSAL OF UNSUITABLE MATERIAL - 2'

EARTH EXCAVATION = 309.25
 EMBANKMENT = 5.56
 TOPSOIL 4" = 6.26
 UNSUITABLE REMOVAL = 134.33

REMOVAL AND DISPOSAL OF UNSUITABLE MATERIAL - 2'

EARTH EXCAVATION = 353.24
 EMBANKMENT = 0.05
 TOPSOIL 4" = 9.21
 UNSUITABLE REMOVAL = 149.63

UNLESS ELEVATIONS ARE SHOWN, ALL UTILITY LOCATIONS SHOWN ON THE CROSS SECTIONS ARE BASED ON THE APPROXIMATE DEPTH SUPPLIED BY THE UTILITY CO. & SHOULD BE FIELD VERIFIED BY CONTRACTOR

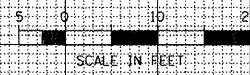

FILE NAME -	USER NAME - 1007	DESIGNED -	REVISED -	STATE OF ILLINOIS DEPARTMENT OF TRANSPORTATION	FAP 399 (IL. RT. 8) CROSS SECTIONS	F.A.P. RTE. 399	SECTION 36 R-7	COUNTY TAZEWELL	TOTAL SHEETS 390	SHEET NO. 353		
x:\projects\200803566\dgn\gpk\XS-IL-RT8-sheets.dgn	PLOT SCALE = 20.7420' / IN.	DRAWN -	REVISED -			SCALE:	SHEET NO. OF SHEETS	STA. 244+50.00 TO STA. 245+00.00	ILLINOIS FED. AID PROJECT			
	PLOT DATE = 10/21/2011	CHECKED -	REVISED -							CONTRACT NO. 68370		
		DATE - 10-21-11	REVISED -									