

FRAMING PLAN

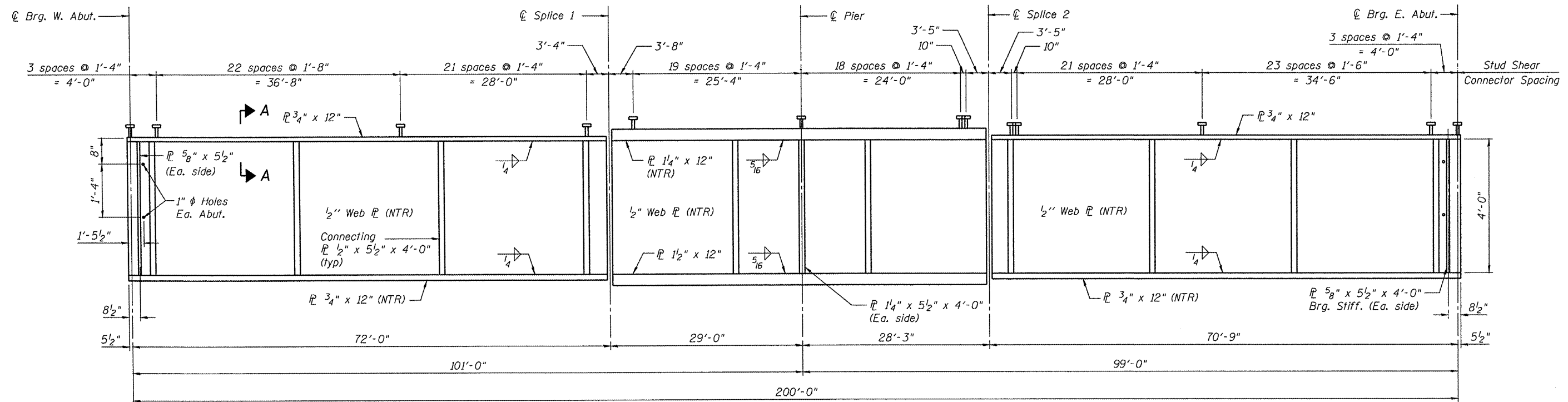

GIRDER ELEVATION

Notes:

1. All flange and web splice plates, except filler plates, shall be M270 Grade 50 and meet notch toughness requirements.
2. Load carrying components designated "NTR" shall conform to the Supplemental Requirements for Notch Toughness, Zone 2.
3. All girder flanges, webs and bearing stiffeners shall be M270 Grade 50.

4. All diaphragms shall be installed as steel is erected and secured with erection pins and bolts except as otherwise noted. Individual cross frames or diaphragms at supports may be temporarily disconnected to install bearing anchor rods.
5. For Section A-A, see sheet S15 of S23.
6. Work this sheet with sheet S15 of S23.



FILE NAME D468418_014_Framing.dgn	USER NAME = TERRA	DESIGNED - OY	REVISED -
		CHECKED - DA	REVISED -
	PLOT SCALE = 1/8" = 1' / IN.	DRAWN - CM	REVISED -
	PLOT DATE = 11/29/2011	CHECKED - JB	REVISED -

**STATE OF ILLINOIS
DEPARTMENT OF TRANSPORTATION**

**FRAMING PLAN
STRUCTURE NO. 055-0067**

SHEET NO. S14 OF 523 SHEETS

F.A.P. RTE. 407	SECTION 55-3HB-1	COUNTY McDONOUGH	TOTAL SHEETS 103	SHEET NO. 39
CONTRACT NO. 68A41			ILLINOIS FED. AID PROJECT	