

PROPOSED HMA SURFACE REMOVAL, 2"
 PROPOSED HMA SURFACE COURSE, MIX "D",
 N70 (2" DEPTH)

EXIST. CURVE #2
 P.I. STA= 930+46.67
 ΔI= 10°30'02"
 D= 2°49'27"
 R= 2028.69'
 T= 186.42'
 L= 371.80'
 E= 8.55'
 S.E.=
 P.C. STA= 928+60.25
 P.T. STA= 932+32.05

NOTE:
 THE PROPOSED PAVEMENT STRIPING IS NOT SHOWN
 ON THIS PLAN SHEET. SEE PAVEMENT MARKING SHEETS
 AND SCHEDULES FOR PROPOSED STRIPING LOCATIONS.

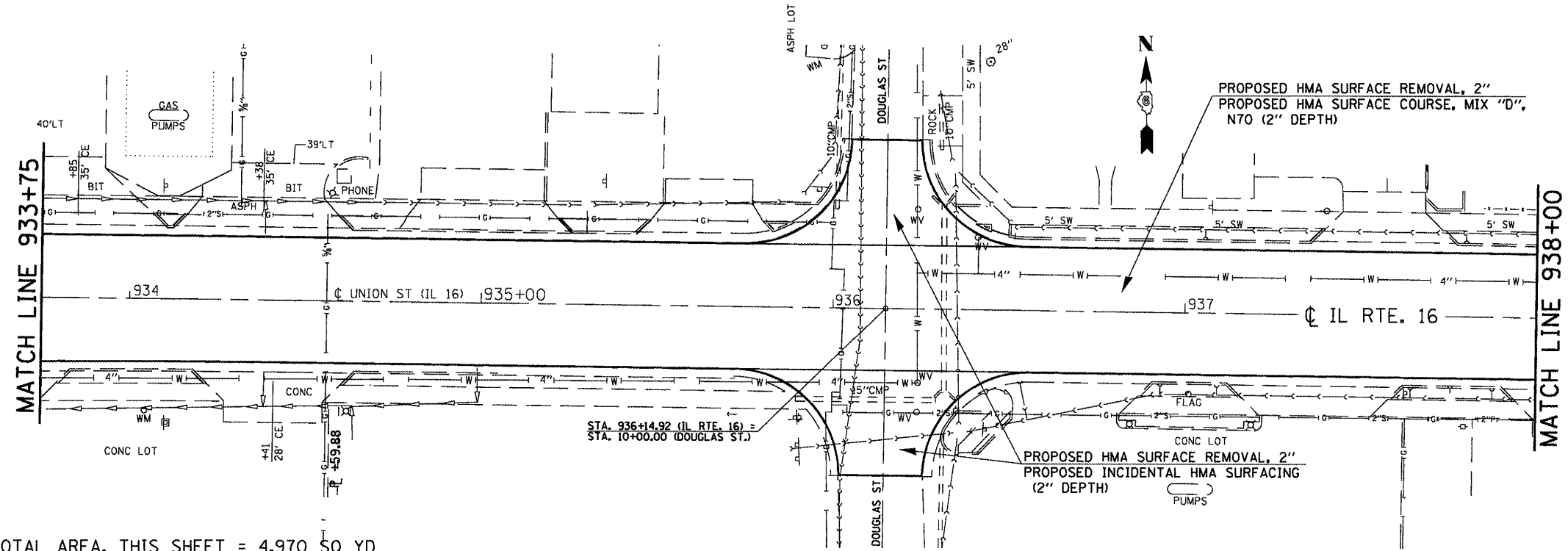

PROPOSED HMA SURFACE REMOVAL, 2"
 PROPOSED HMA SURFACE COURSE, MIX "D",
 N70 (2" DEPTH)

PROPOSED HMA SURFACE REMOVAL, 2"
 PROPOSED INCIDENTAL HMA SURFACING
 (2" DEPTH)

TOTAL AREA, THIS SHEET = 4,970 SQ YD

FILE NAME =	USER NAME = sparksgw	DESIGNED - RTS	REVISED -	STATE OF ILLINOIS DEPARTMENT OF TRANSPORTATION	PLAN SHEET (LITCHFIELD)	F.A.P. RTE.	SECTION	COUNTY	TOTAL SHEETS	SHEET NO.	
es:\pwork\p\dot\sparksgw\0222005\0672067-ah-plot.dgn	PLLOT SCALE = 48.0000' / in.	DRAWN - RTS	REVISED -			•	••	MONTGOMERY	80	37	
PLLOT DATE = Aug-25-2011 10:16:01AM	DATE = 06-15-11	CHECKED -	REVISED -			CONTRACT NO. 72D67					
		DATE = 06-15-11	REVISED -			FED. ROAD DIST. NO. ILLINOIS FED. AID PROJECT					