

When cantilever forming brackets are used, the work shall be done according to Article 503.06(b) of the Standard Specifications, except as modified below and in the details shown on this sheet.

The finishing machine rails shall be placed on the top flange of the exterior beams.

The beams or girders, supporting cantilever forming brackets, shall be tied together at 4 foot intervals.

For Standard construction, or Stage Construction the Hardwood bracing materials shall be placed as shown between webs of beams in each bay.

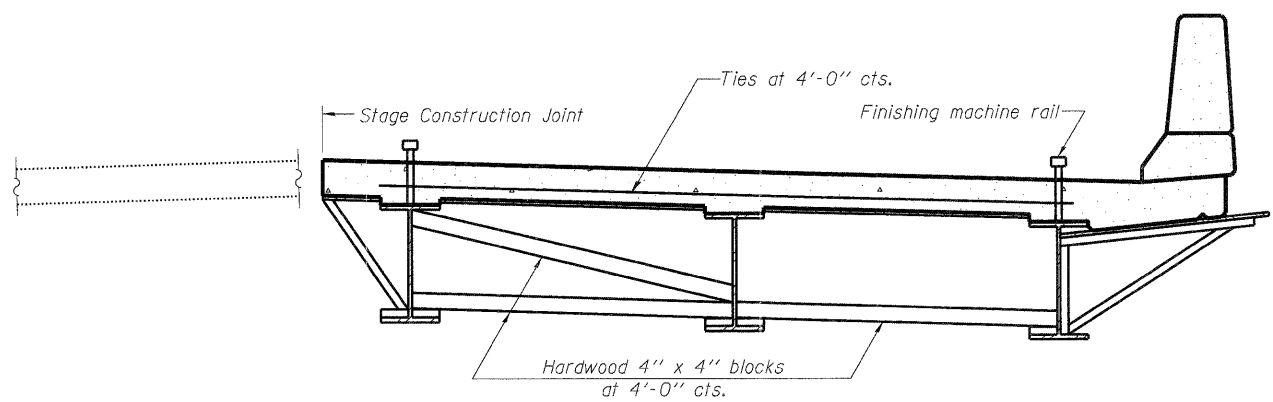

**FORM BRACES FOR
STAGE CONSTRUCTION**

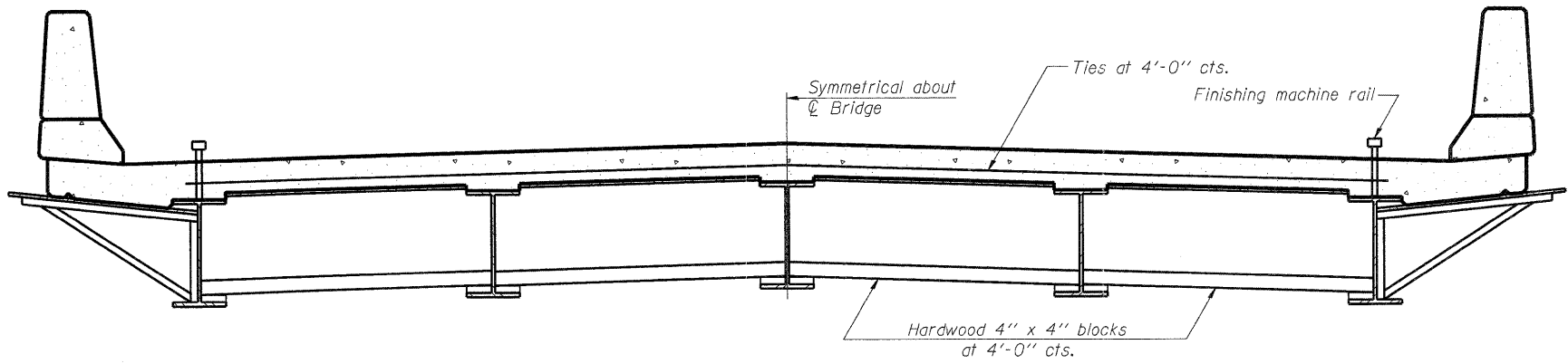

**FORM BRACES FOR
STANDARD CONSTRUCTION**

PRINTED DATE: 12/29/2011
FILE NAME: C:\p03\3031a\yds\sub 148, Item 25 - d7 - various design\work_order_06\cadd\formings\sheet17.W06.GNS\stage0a.dgn

SB-1 7-1-10

(Sheet 2 of 3)

DESIGNED	-	ADG
CHECKED	-	DF
DRAWN	-	ADG
CHECKED	-	DF

ESI ESI CONSULTANTS, LTD
 753 WINDSOR ROAD
 CHARLESTON, IL 61920
 (217) 346-1800
 WWW.ESI-CONSULTANTS.LTD.COM
 ILLINOIS DEPARTMENT OF PROFESSIONAL REGULATION REGISTRATION #184-003685

**STATE OF ILLINOIS
DEPARTMENT OF TRANSPORTATION**

GENERAL DATA & DETAILS
CANTILEVER FORMING BRACKETS
STRUCTURE NO. 096-0074
 SHEET NO. 3 OF 24 SHEETS

F.A.P. RTE.	SECTION	COUNTY	TOTAL SHEETS	SHEET
823	(22.B2A)B-1 & (22.B2B)B-1	Wayne	85	17
				CONTRACT NO. 74216
ILLINOIS FEDERAL AID PROJECT				