

TRAVERSE/P.O.T. NUMBER 25052  
 STA 2127+28.00  
 TRAVERSE/P.O.T. NUMBER 25051  
 STA 2128+17.00  
 TRAVERSE/P.O.T. NUMBER 429  
 STA 2128+50.00

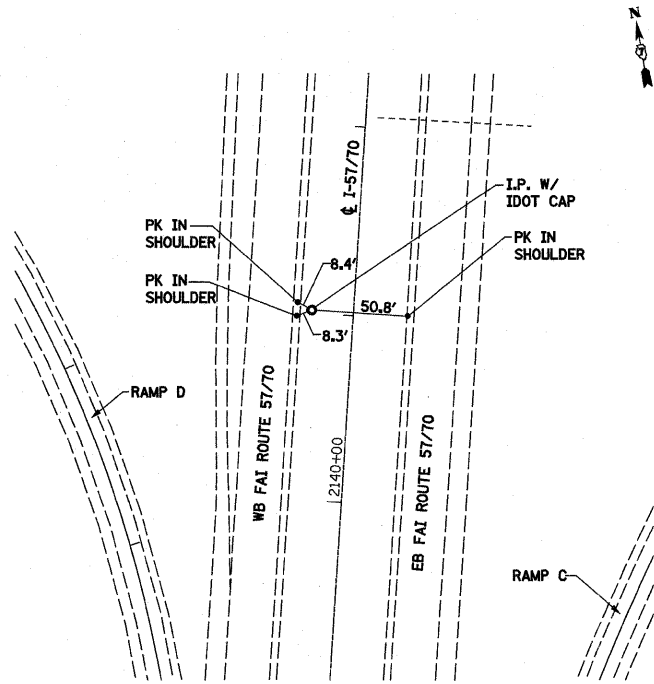

TRAVERSE/P.O.T. NUMBER 428  
 STA 2141+01.61

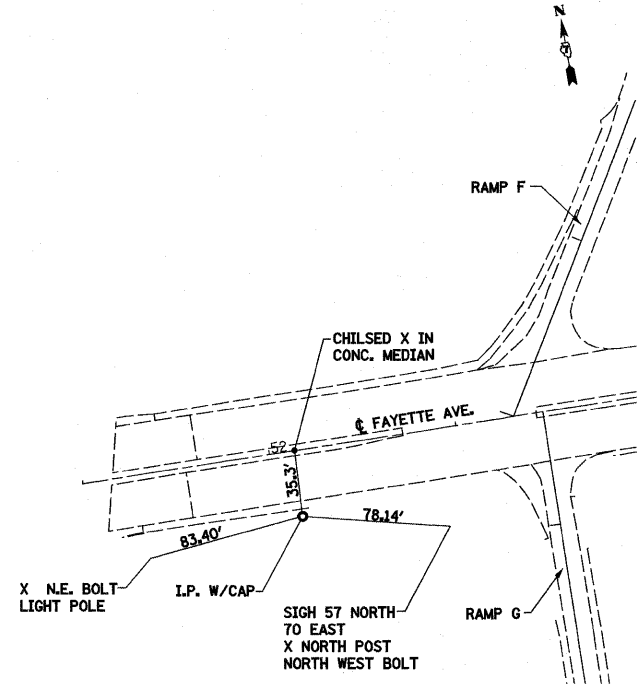

TRAVERSE/P.O.T. NUMBER 52  
 STA 52+12.44

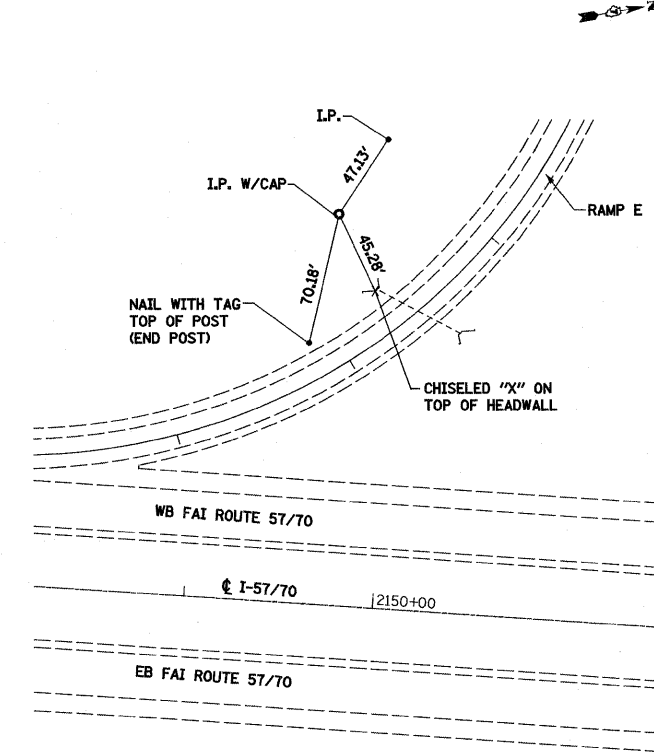

TRAVERSE/P.O.T. NUMBER 54  
 STA 11+53.80

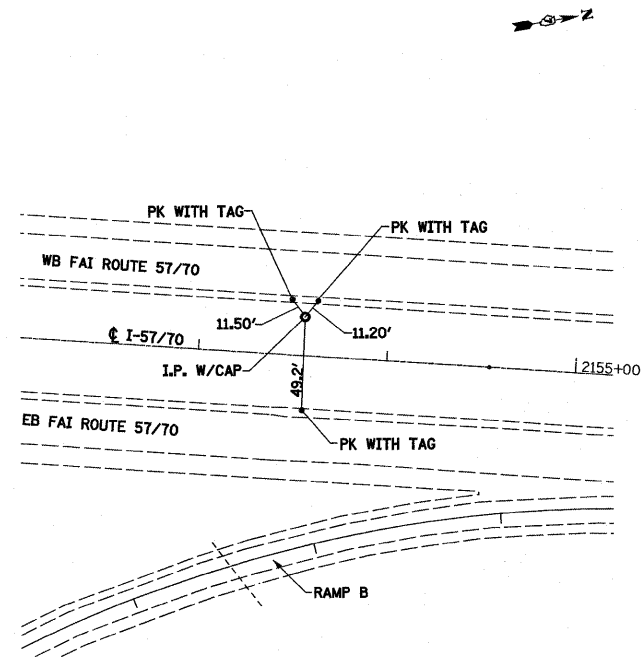

TRAVERSE/P.O.T. NUMBER 427  
 STA 2153+55.35

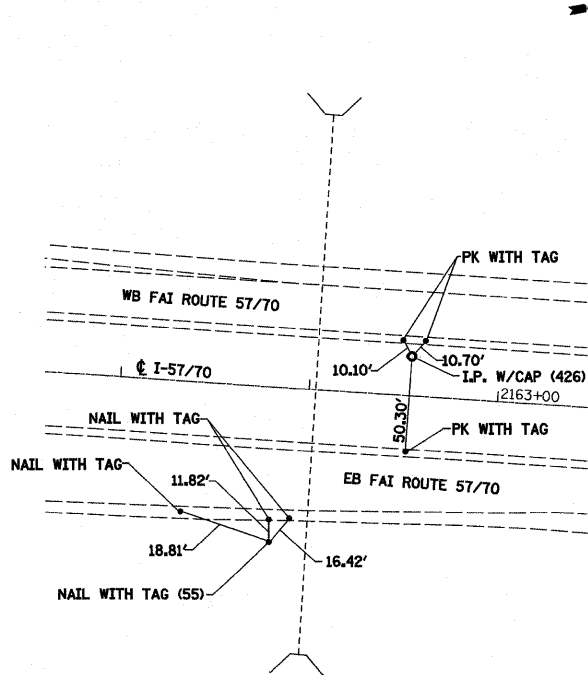

TRAVERSE/P.O.T. NUMBER 55  
 STA 2161+83.75  
 TRAVERSE/P.O.T. NUMBER 426  
 STA 2162+53.25

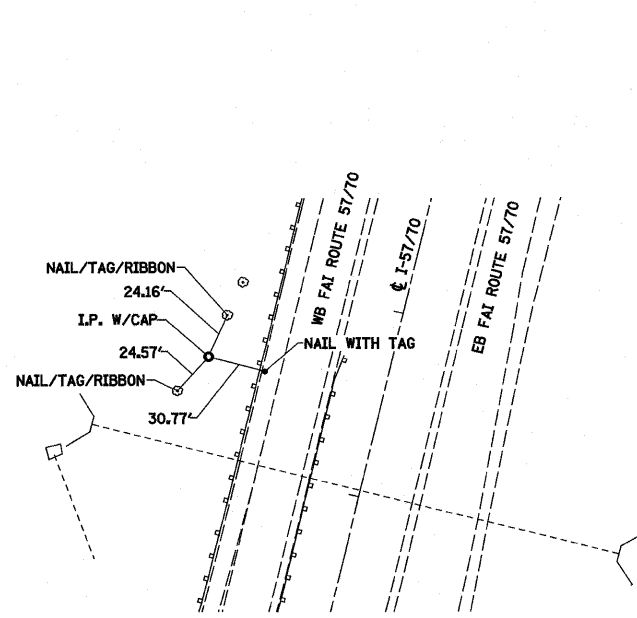

TRAVERSE/P.O.T. NUMBER 6112  
 STA 2162+53.24

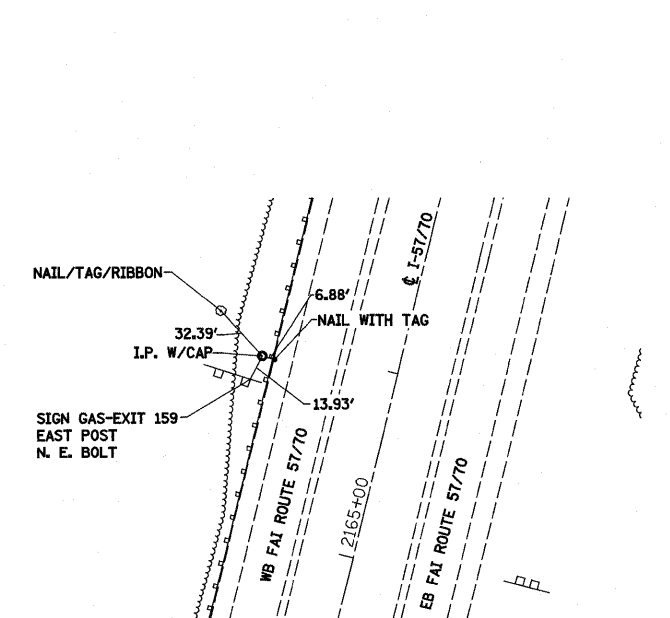

TRAVERSE/P.O.T. NUMBER 5800  
 STA 2165+92.17

FILE NAME = S:\projects\807257-70.dwg

USER NAME = lrcda  
 PLOT SCALE = 200.0000' / IN.  
 PLOT DATE = 3/17/2011

DESIGNED - JWS  
 DRAWN - PDB  
 CHECKED - BRM  
 DATE - 1-27-09

REVISED -  
 REVISED -  
 REVISED -  
 REVISED -

STATE OF ILLINOIS  
 DEPARTMENT OF TRANSPORTATION

TIE POINTS, FAI ROUTES 57/70

SCALE: 1"=100' SHEET NO. 11 OF 13 SHEETS STA TO STA

FAI RTE.	SECTION	COUNTY	TOTAL SHEETS	SHEET NO.
57/70	(25-3,4)R	EFFINGHAM	1098	50
FED. ROAD DIST. NO. ILLINOIS FED. AID PROJECT			CONTRACT NO. 74299	