

TYPICAL TRAFFIC PATTERN FOR PRE-STAGE 2A

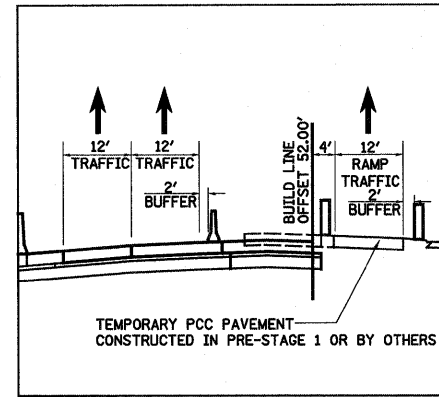

DETAIL A-A

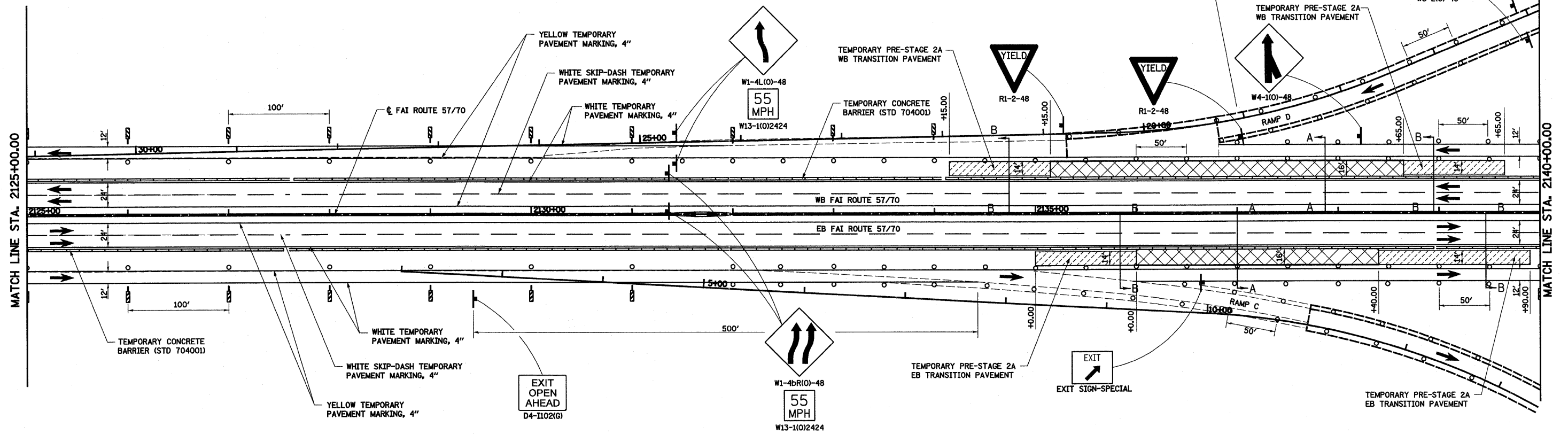

MATCH LINE STA. 2125+00.00

MATCH LINE STA. 2140+00.00

LEGEND

- TEMPORARY PCC PAVEMENT
- CONSTRUCTION THIS STAGE
- SIGN
- DIRECTION OF TRAFFIC
- TYPE II BARRICADES OR DRUMS WITH MONO-DIRECTIONAL STEADY BURNING LIGHTS
- VERTICAL PANEL
- TYPE III BARRICADE WITH FLASHING LIGHTS
- ARROW BOARD

NOTES: PRE-STAGE 2A

- SHIFT ALL TRAFFIC EXITING AT FAYETTE AVE OR IL 32 & IL 33 TO FAR RIGHT LANE. SHIFT REMAINING THROUGH FAI 57/70 TRAFFIC TO NEWLY CONSTRUCTED INSIDE SHOULDER AND PAVEMENT.
- CONSTRUCT PAVEMENT AND TEMPORARY PAVEMENT AT EACH RAMP TERMINAL AS INDICATED.

NOTES: EB TRANSITION PAVEMENT

- REMOVE EXISTING PAVEMENT FROM STA 2135+00.00 TO STA 2139+90.00.
- CONSTRUCT PROPOSED PAVEMENT ACCORDING TO 57/70 PROFILE FROM STA 2136+00.00 TO STA 2138+40.00.
- CONSTRUCT TEMPORARY TRANSITION PAVEMENT ACCORDING TO PROFILE ON SHEET 12 OF 14 FROM STA 2135+00.00 TO STA 2136+00.00 AND STA 2138+40.00 TO STA 2139+90.00.

NOTES: WB TRANSITION PAVEMENT

- REMOVE EXISTING PAVEMENT FROM STA 2134+15.00 TO STA 2139+65.00.
- CONSTRUCT PROPOSED PAVEMENT ACCORDING TO 57/70 PROFILE FROM STA 2135+15.00 TO STA 2138+65.00.
- CONSTRUCT TEMPORARY TRANSITION PAVEMENT ACCORDING TO PROFILE ON SHEET 12 OF 14 FROM STA 2134+15.00 TO STA 2135+15.00 AND STA 2138+65.00 TO STA 2139+65.00.

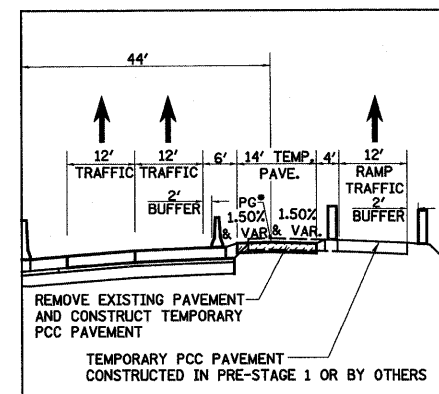

DETAIL B-B

FOR PROFILE DETAILS, SEE SHEET 12 OF 14

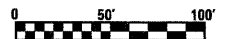

| | | | | | | | | | | | |
|--|--------------------|-----------------|-----------|---|--|---|-----------|-------------|--------------|-----------|--|
| FILE NAME = | USER NAME = bwsbel | DESIGNED - ESW | REVISED - | STATE OF ILLINOIS DEPARTMENT OF TRANSPORTATION | MAINTENANCE OF TRAFFIC, PRE-STAGE 2A, FAI ROUTE 57/70 | F.A.I. RTE. | SECTION | COUNTY | TOTAL SHEETS | SHEET NO. | |
| S:\Projects\403-00072-57-70\cgr\ML_keller\mot_P52a.dwg | | DRAWN - PDB | REVISED - | | | 57/70 | (25-3,4)R | EFFENINGHAM | 1098 | 112 | |
| PLOT SCALE = 1/8"=1'-0" | | CHECKED - BRM | REVISED - | | | CONTRACT NO. 74299 | | | | | |
| PLOT DATE = 3/18/2011 | | DATE - 05-07-08 | REVISED - | | | FED. ROAD DIST. NO. ILLINOIS FED. AID PROJECT | | | | | |