

**NOTES: EB TRANSITION PAVEMENT**

1. REMOVE EXISTING PAVEMENT FROM STA 2208+65.00 TO STA 2215+00.00.
2. CONSTRUCT PROPOSED PAVEMENT ACCORDING TO 57/70 PROFILE FROM STA 2209+65.00 TO STA 2214+50.00.
3. CONSTRUCT TEMPORARY TRANSITION PAVEMENT ACCORDING TO PROFILE ON SHEET 13 OF 14 FROM STA 2208+65.00 TO STA 2209+65.00 AND STA 2214+50.00 TO STA 2215+00.00.

**NOTES: WB TRANSITION PAVEMENT**

1. REMOVE EXISTING PAVEMENT FROM STA 2211+35.00 TO STA 2217+40.00.
2. CONSTRUCT PROPOSED PAVEMENT ACCORDING TO 57/70 PROFILE FROM STA 2213+35.00 TO STA 2215+90.00.
3. CONSTRUCT TEMPORARY TRANSITION PAVEMENT ACCORDING TO PROFILE ON SHEET 13 OF 14 FROM STA 2211+35.00 TO STA 2213+35.00 AND STA 2215+90.00 TO STA 2217+40.00.

**NOTES: PRE-STAGE 2A**

1. SHIFT ALL TRAFFIC EXITING AT FAYETTE AVE OR IL 32 & IL 33 TO FAR RIGHT LANE. SHIFT REMAINING THROUGH FAI 57/70 TRAFFIC TO NEWLY CONSTRUCTED INSIDE SHOULDER AND PAVEMENT.
2. CONSTRUCT PAVEMENT AND TEMPORARY PAVEMENT AT EACH RAMP TERMINAL AS INDICATED.

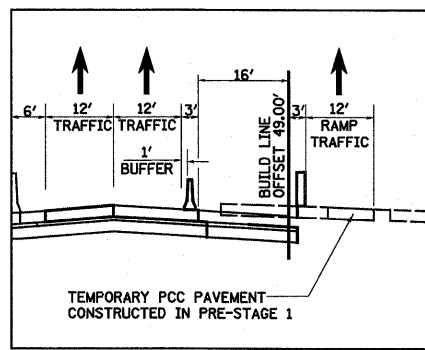
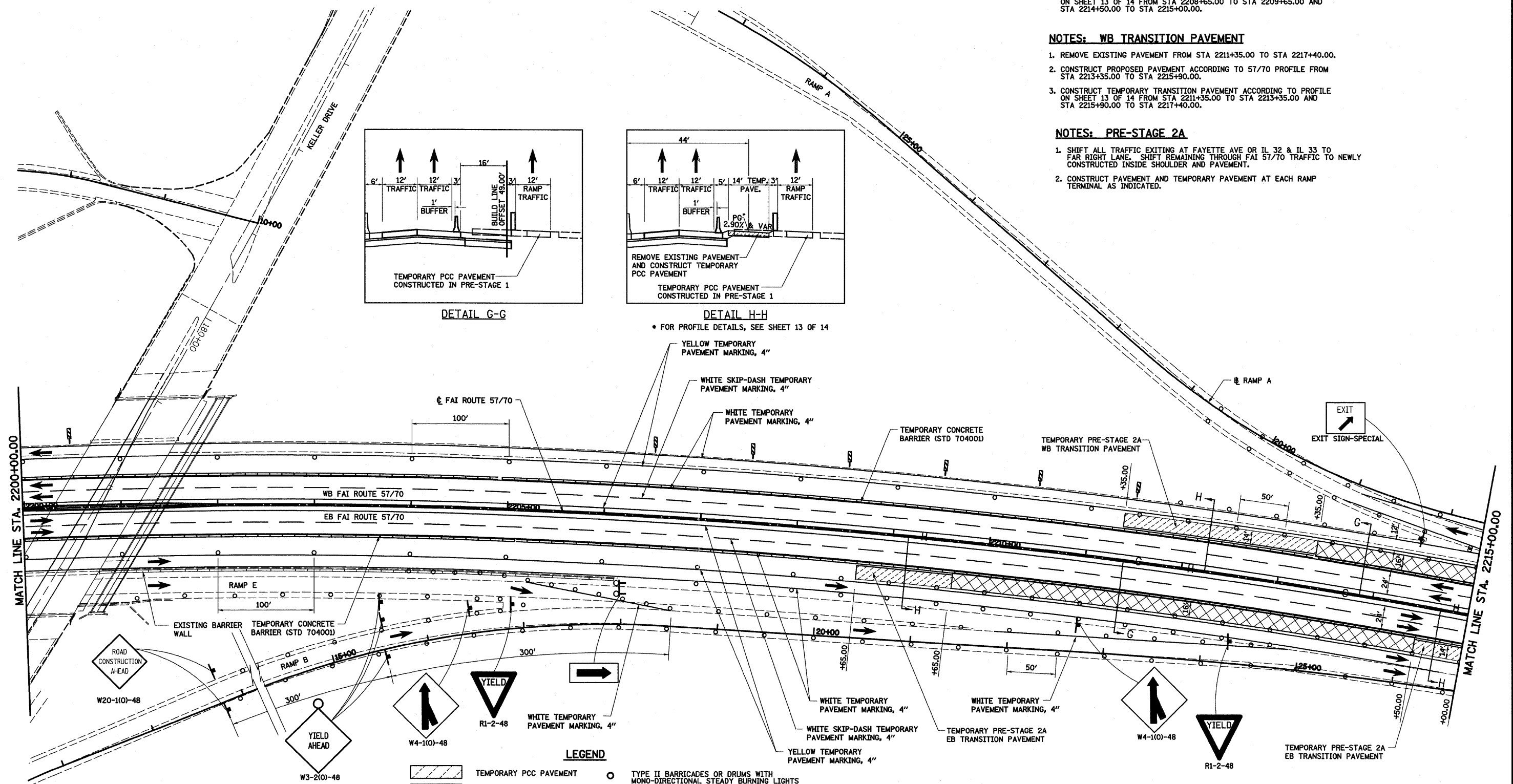

DETAIL G-G

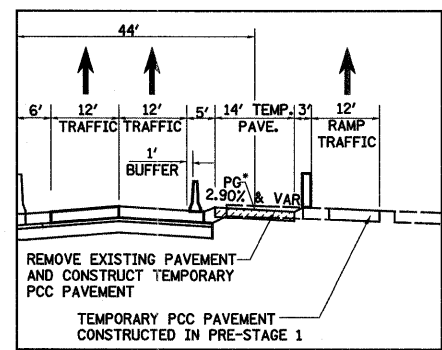

DETAIL H-H

• FOR PROFILE DETAILS, SEE SHEET 13 OF 14

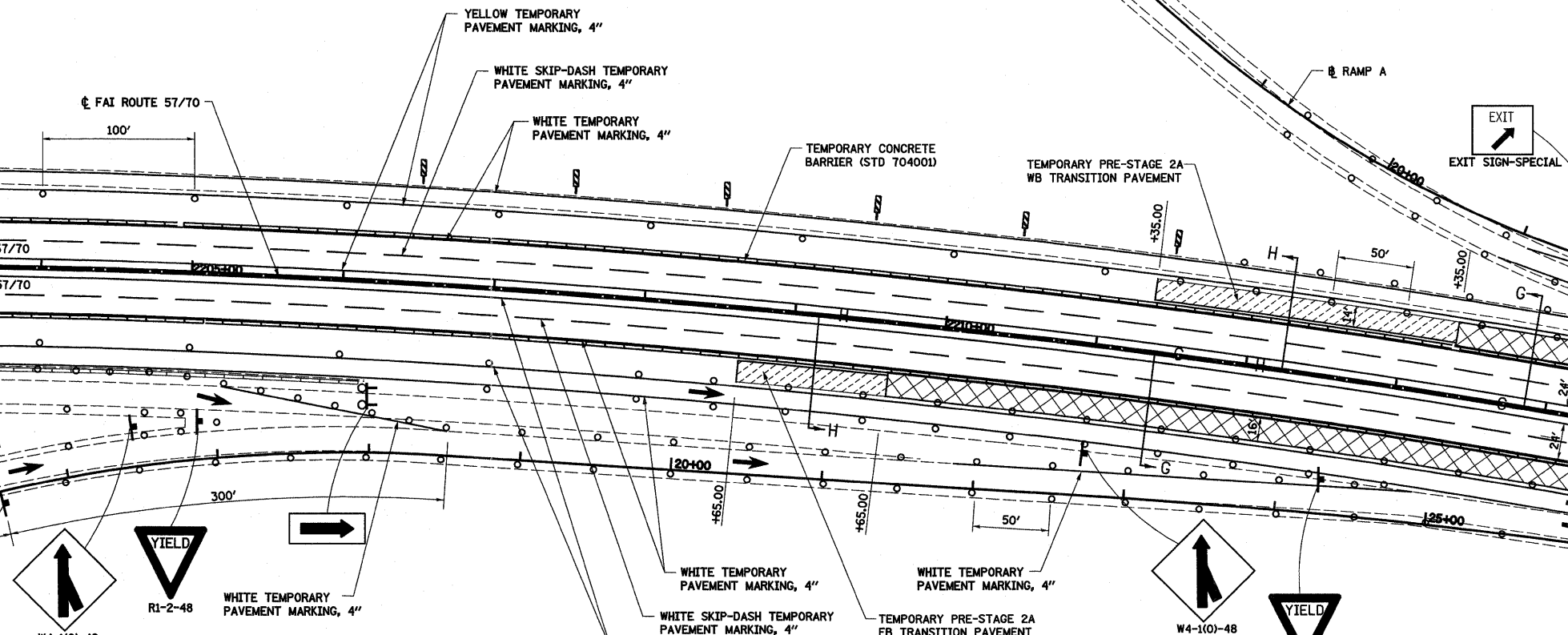

**LEGEND**

FILE NAME =	USER NAME = linda	DESIGNED - ESW	REVISED -	<b>STATE OF ILLINOIS DEPARTMENT OF TRANSPORTATION</b>	<b>MAINTENANCE OF TRAFFIC, PRE-STAGE 2A, FAI ROUTE 57/70</b>	F.A.I. RTE.	SECTION	COUNTY	TOTAL SHEETS	SHEET NO.	
S:\Projects\403-00072-57-70\dgn\ML_Keller\mof_2a.dwg	PLOT SCALE = 100,0000' / IN.	DRAWN - PDB	REVISED -			57/70	(25-3,4)R	EFFINGHAM	1098	117	
PLOT DATE = 3/16/2011	DATE - 5-07-08	CHECKED - BRM	REVISED -			CONTRACT NO. 74299					
		DATE - 5-07-08	REVISED -			FED. ROAD DIST. NO. ILLINOIS FED. AID PROJECT					