

TYPICAL TRAFFIC PATTERN FOR PRE-STAGE 2B

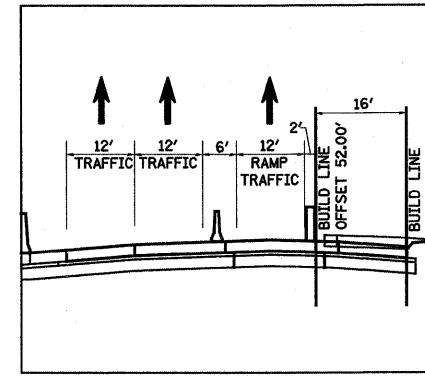

DETAIL A-A

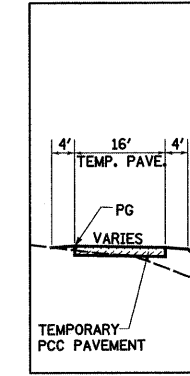

DETAIL I-I

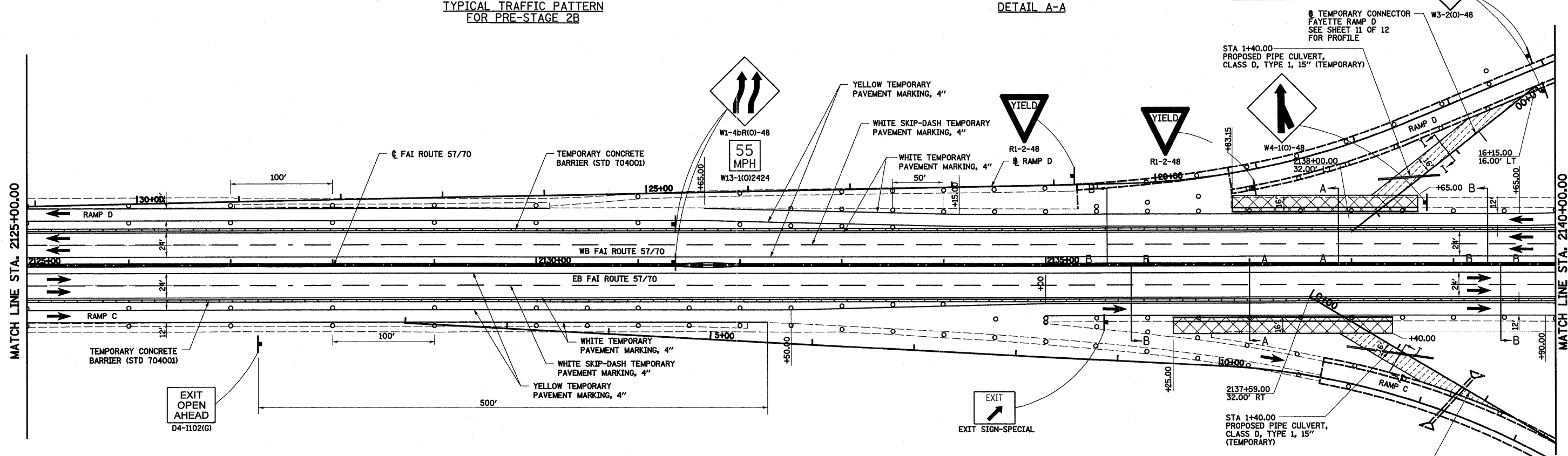

**LEGEND**

- TEMPORARY PCC PAVEMENT
- CONSTRUCTION THIS STAGE
- SIGN
- DIRECTION OF TRAFFIC
- TYPE II BARRICADES OR DRUMS WITH MONO-DIRECTIONAL STEADY BURNING LIGHTS
- VERTICAL PANEL
- TYPE III BARRICADE WITH FLASHING LIGHTS
- ARROW BOARD

**NOTES: EB TRANSITION PAVEMENT**

- REMOVE EXISTING PAVEMENT FROM STA 2136+25.00 TO STA 2138+40.00.
- CONSTRUCT PROPOSED PAVEMENT ACCORDING TO 57/70 PROFILE FROM STA 2136+25.00 TO STA 2138+40.00.
- CONSTRUCT TEMPORARY CONNECTOR PAVEMENT FOR FAYETTE RAMP C ACCORDING TO PROFILE ON SHEET 11 OF 12

**NOTES: WB TRANSITION PAVEMENT**

- REMOVE EXISTING PAVEMENT FROM STA 2136+83.15 TO STA 2138+65.00.
- CONSTRUCT PROPOSED PAVEMENT ACCORDING TO 57/70 PROFILE FROM STA 2136+83.15 TO STA 2138+65.00.
- CONSTRUCT TEMPORARY CONNECTOR PAVEMENT FOR FAYETTE RAMP D ACCORDING TO PROFILE ON SHEET 11 OF 12

**NOTES: PRE-STAGE 2B**

- SHIFT ALL TRAFFIC EXITING AT FAYETTE AVE OR IL 32 & IL 33 TO FAR RIGHT LANE. SHIFT REMAINING THROUGH 57/70 TRAFFIC TO INSIDE SHOULDER PAVEMENT.
- CONSTRUCT PAVEMENT, PROPOSED PAVEMENT AND SHOULDER AND TEMPORARY RAMP CONNECTOR AT EACH RAMP TERMINAL. CONSTRUCT WIDENING ON KELLER RAMPS.

**TEMPORARY CONNECTOR FAYETTE RAMP C**

DESCRIPTION	COORDINATE	
	NORTHING	EASTING
POT STA 0+00.00	892800.05	917328.24
POT STA 3+12.78	893022.52	917548.10

**TEMPORARY CONNECTOR FAYETTE RAMP D**

DESCRIPTION	COORDINATE	
	NORTHING	EASTING
POT STA 0+00.00	893065.29	917179.91
POT STA 2+31.02	892855.15	917275.88

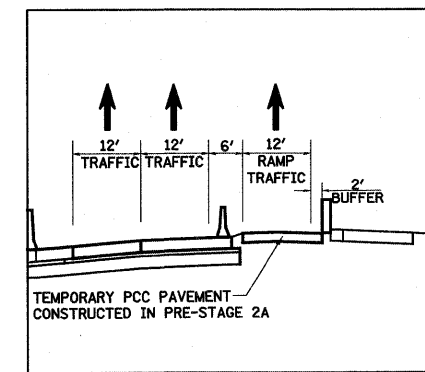

DETAIL B-B

