

**TEMPORARY CONNECTOR
FAYETTE RAMP A**

DESCRIPTION	COORDINATE	
	NORTHING	EASTING
POT STA 0+00.00	894589.09	917702.13
POT STA 3+34.34	894371.24	917448.51

**TEMPORARY CONNECTOR
FAYETTE RAMP B**

DESCRIPTION	COORDINATE	
	NORTHING	EASTING
POT STA 0+00.00	893897.15	917872.47
POT STA 3+07.42	894138.40	917681.93

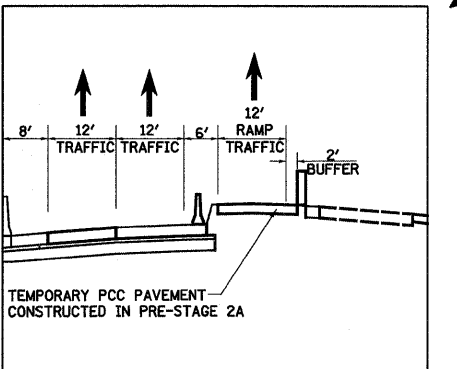
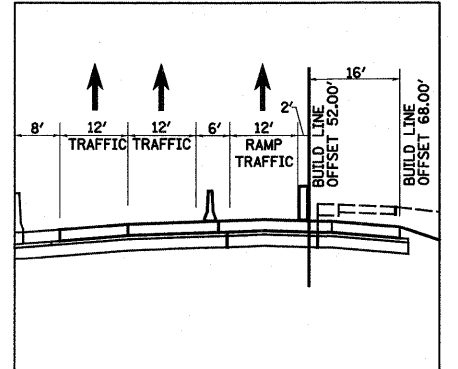
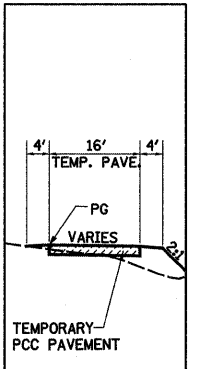

LEGEND

- TEMPORARY PCC PAVEMENT
- CONSTRUCTION THIS STAGE
- SIGN
- DIRECTION OF TRAFFIC
- TYPE II BARRICADES OR DRUMS WITH MONO-DIRECTIONAL STEADY BURNING LIGHTS
- VERTICAL PANEL
- TYPE III BARRICADE WITH FLASHING LIGHTS
- ARROW BOARD

NOTES: PRE-STAGE 2B

- SHIFT ALL TRAFFIC EXITING AT FAYETTE AVE OR IL 32 & IL 33 TO FAR RIGHT LANE. SHIFT REMAINING THROUGH 57/70 TRAFFIC TO INSIDE SHOULDER PAVEMENT.
- CONSTRUCT PAVEMENT, PROPOSED PAVEMENT AND SHOULDER AND TEMPORARY RAMP CONNECTOR AT EACH RAMP TERMINAL. CONSTRUCT WIDENING ON KELLER RAMPS.

NOTES: EB TRANSITION PAVEMENT

- REMOVE EXISTING PAVEMENT FROM STA 2151+10.00 TO STA 2154+50.00.
- CONSTRUCT PROPOSED PAVEMENT ACCORDING TO 57/70 PROFILE FROM STA 2151+10.00 TO STA 2154+50.00.
- CONSTRUCT TEMPORARY CONNECTOR PAVEMENT FOR FAYETTE RAMP B ACCORDING TO PROFILE ON SHEET 11 OF 12

NOTES: WB TRANSITION PAVEMENT

- REMOVE EXISTING PAVEMENT FROM STA 2155+15.00 TO STA 2157+09.99.
- CONSTRUCT PROPOSED PAVEMENT ACCORDING TO 57/70 PROFILE FROM STA 2155+15.00 TO STA 2157+09.99.
- CONSTRUCT TEMPORARY CONNECTOR PAVEMENT FOR FAYETTE RAMP A ACCORDING TO PROFILE ON SHEET 11 OF 12

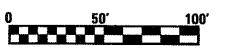

FILE NAME =	USER NAME = bseibal	DESIGNED - JWS	REVISED -	STATE OF ILLINOIS DEPARTMENT OF TRANSPORTATION	MAINTENANCE OF TRAFFIC, PRE-STAGE 2B, FAI ROUTE 57/70	F.A.I. RTE. 57/70	SECTION (25-3.4)R	COUNTY EFFINGHAM	TOTAL SHEETS 1098	SHEET NO. 127		
PLOT SCALE = 1/8"=50' / IN.	DRAWN - PDB	REVISED -	SCALE: 1"=50'			SHEET NO. 3 OF 12 SHEETS	STA. 2140+00.00 TO STA. 2155+00.00	FED. ROAD DIST. NO.	ILLINOIS FED. AID PROJECT	CONTRACT NO. 74299		
PLOT DATE = 3/18/2011	CHECKED - BRM	REVISED -										
	DATE - 5-07-08	REVISED -										