

THIS SHEET
FOR INFORMATION ONLY

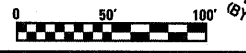
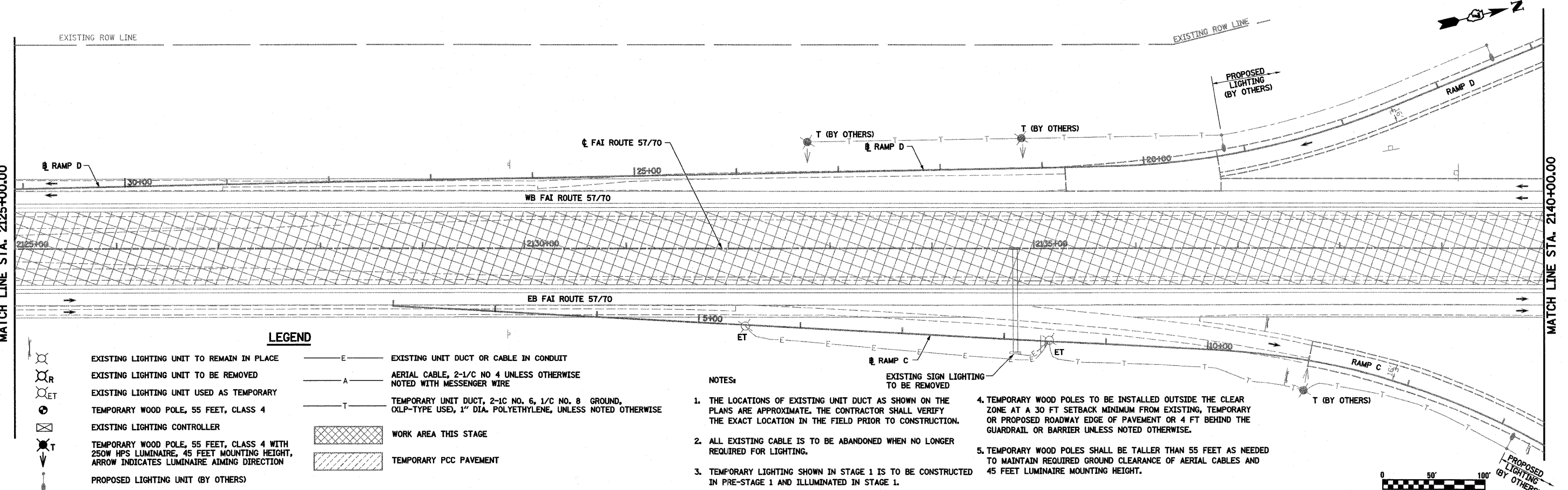
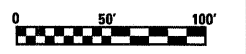
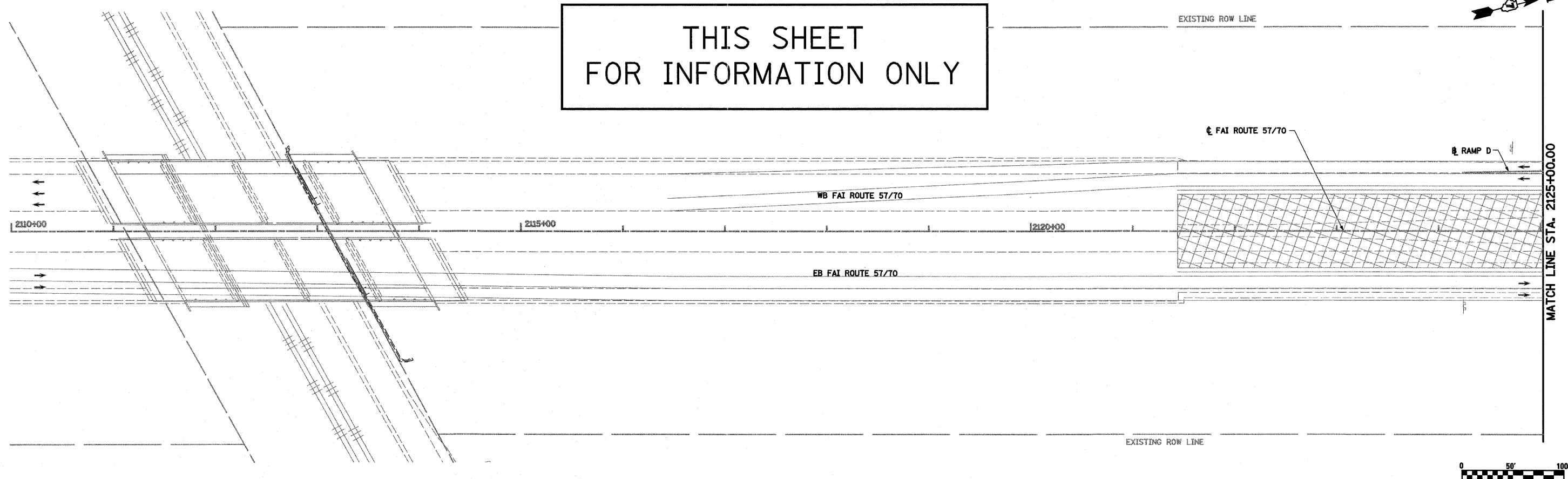

LEGEND

- | | | | |
|--|--|--|--|
| | EXISTING LIGHTING UNIT TO REMAIN IN PLACE | | EXISTING UNIT DUCT OR CABLE IN CONDUIT |
| | EXISTING LIGHTING UNIT TO BE REMOVED | | AERIAL CABLE, 2-1/2" NO 4 UNLESS OTHERWISE NOTED WITH MESSENGER WIRE |
| | EXISTING LIGHTING UNIT USED AS TEMPORARY | | TEMPORARY UNIT DUCT, 2-1/2" NO. 6, 1/2" NO. 8 GROUND, OXP-TYPE USE, 1" DIA. POLYETHYLENE, UNLESS NOTED OTHERWISE |
| | TEMPORARY WOOD POLE, 55 FEET, CLASS 4 | | WORK AREA THIS STAGE |
| | EXISTING LIGHTING CONTROLLER | | TEMPORARY PCC PAVEMENT |
| | TEMPORARY WOOD POLE, 55 FEET, CLASS 4 WITH 250W HPS LUMINAIRE, 45 FEET MOUNTING HEIGHT, ARROW INDICATES LUMINAIRE AIMING DIRECTION | | |
| | PROPOSED LIGHTING UNIT (BY OTHERS) | | |

NOTES:

1. THE LOCATIONS OF EXISTING UNIT DUCT AS SHOWN ON THE PLANS ARE APPROXIMATE. THE CONTRACTOR SHALL VERIFY THE EXACT LOCATION IN THE FIELD PRIOR TO CONSTRUCTION.
2. ALL EXISTING CABLE IS TO BE ABANDONED WHEN NO LONGER REQUIRED FOR LIGHTING.
3. TEMPORARY LIGHTING SHOWN IN STAGE 1 IS TO BE CONSTRUCTED IN PRE-STAGE 1 AND ILLUMINATED IN STAGE 1.
4. TEMPORARY WOOD POLES TO BE INSTALLED OUTSIDE THE CLEAR ZONE AT A 30 FT SETBACK MINIMUM FROM EXISTING, TEMPORARY OR PROPOSED ROADWAY EDGE OF PAVEMENT OR 4 FT BEHIND THE GUARDRAIL OR BARRIER UNLESS NOTED OTHERWISE.
5. TEMPORARY WOOD POLES SHALL BE TALLER THAN 55 FEET AS NEEDED TO MAINTAIN REQUIRED GROUND CLEARANCE OF AERIAL CABLES AND 45 FEET LUMINAIRE MOUNTING HEIGHT.

FILE NAME =	USER NAME = paul	DESIGNED - VG	REVISED -	STATE OF ILLINOIS DEPARTMENT OF TRANSPORTATION	EXISTING LIGHTING REMOVAL AND TEMPORARY LIGHTING FAI ROUTE 57/70, STAGE 1	F.A.I. RTE. 57/70	SECTION (25-3,4)R	COUNTY EFFINGHAM	TOTAL SHEETS 1098	SHEET NO. 300
PLOT SCALE = 100.0000' / IN. PLOT DATE = 3/18/2011				SCALE: 1"=50' SHEET NO. 2 OF 34 SHEETS STA. 2121+44.00 TO STA. 2125+00.00		CONTRACT NO. 74299 FED. ROAD DIST. NO. ILLINOIS FED. AID PROJECT				