

DATE	
BY	
FINAL SURVEY	SURVEYED
NOTE BOOK NO.	PLOTTED
	TEMPLATE
	AREAS CHECKED

DATE	
BY	
ORIGINAL SURVEY	SURVEYED
NOTE BOOK NO.	PLOTTED
	TEMPLATE
	AREAS CHECKED

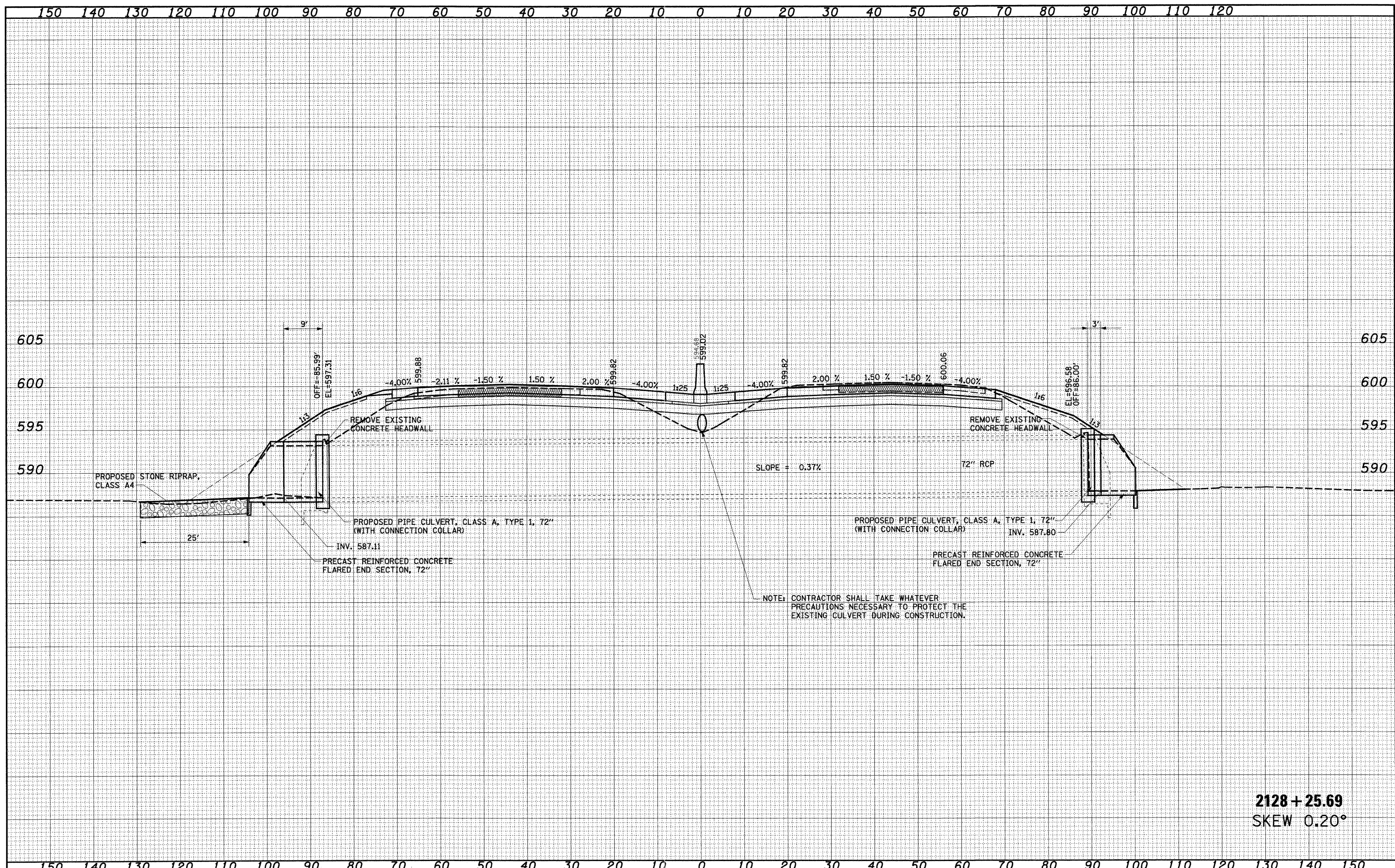

NOTE: CONTRACTOR SHALL TAKE WHATEVER PRECAUTIONS NECESSARY TO PROTECT THE EXISTING CULVERT DURING CONSTRUCTION.

2128 + 25.69
SKEW 0.20°

FILE NAME =	USER NAME = *USER*	DESIGNED - JWS	REVISED -	STATE OF ILLINOIS DEPARTMENT OF TRANSPORTATION	CULVERT PROFILES, FAI ROUTE 57/70		F.A.I. RTE. 57/70	SECTION (25-3,4)R	COUNTY EFFINGHAM	TOTAL SHEETS 1098	SHEET NO. 416
#164	PLOT SCALE = *SCALE*	DRAWN - LEC	REVISED -		SCALE: 1"=10'	SHEET NO. 1 OF 11 SHEETS	STA. 2128+25.69 TO STA. 2128+25.69	FED. ROAD DIST. NO.	ILLINOIS FED. AID PROJECT	CONTRACT NO. 74299	
	PLOT DATE = *DATE*	CHECKED - BRM	REVISED -								
		DATE - 4-01-08	REVISED -								