

DATE	
BY	
FINAL SURVEY	
SHAWED	
PLOTTED	
TEMPLATE	
NOTE BOOK	
NO.	
AREAS CHECKED	

DATE	
BY	
ORIGINAL SURVEY	
SHAWED	
PLOTTED	
TEMPLATE	
NOTE BOOK	
NO.	
AREAS CHECKED	

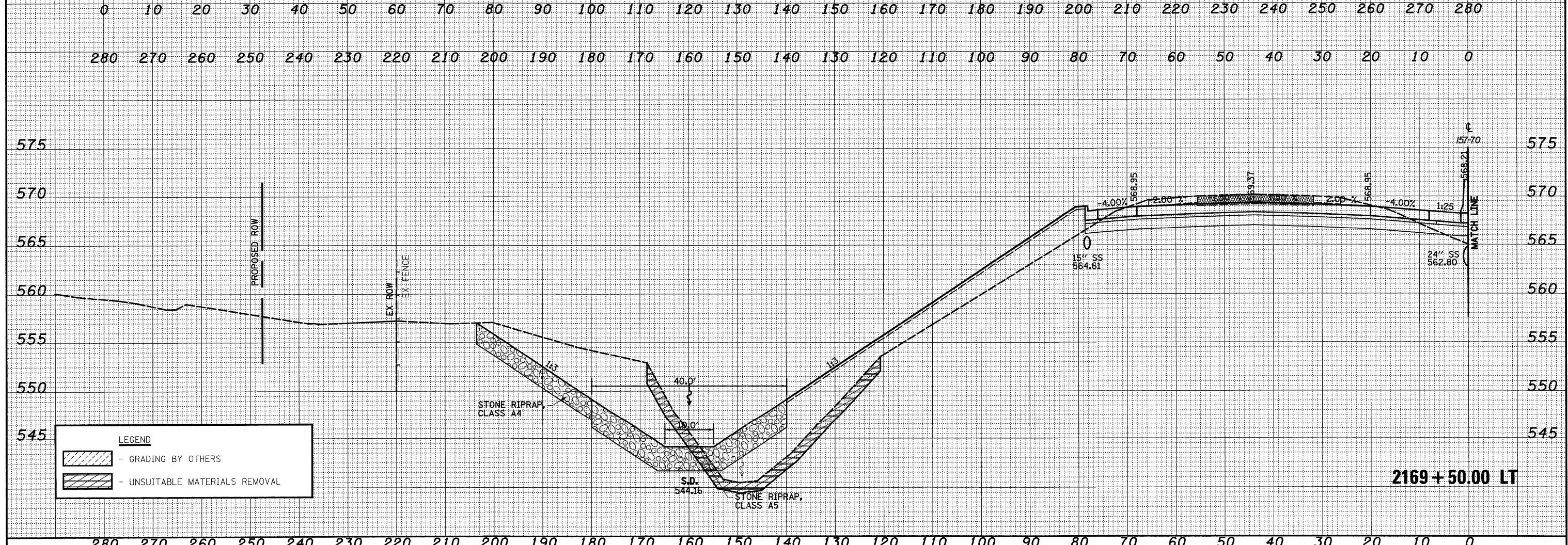

LEGEND	
	- GRADING BY OTHERS
	- UNSUITABLE MATERIALS REMOVAL

FILE NAME =	USER NAME = John	DESIGNED - JWS	REVISED -	<b>STATE OF ILLINOIS</b> <b>DEPARTMENT OF TRANSPORTATION</b>	<b>CROSS SECTIONS FAI 57/70</b>	F.A.I. RTE. 57/70	SECTION (25-3,4)R	COUNTY EFFINGHAM	TOTAL SHEETS 1098	SHEET NO. 507		
PROJECT NO. 08072.57-70	PLOT SCALE = 20.0000' / IN.	DRAWN - LEC	REVISED -			SCALE: 1"=10'	SHEET NO. 81 OF 199 SHEETS	STA. 2169+50.00 TO STA. 2169+50.00	CONTRACT NO. 74299			
PLOT DATE = 3/20/2011	DATE - 4-01-08	CHECKED - BRM	REVISED -			FED. ROAD DIST. NO. ILLINOIS FED. AID PROJECT						
		DATE - 4-01-08	REVISED -									