

DATE	
BY	
FINAL SURVEY	SURVEYED
NOTE BOOK	PLOTTED
NO.	TEMPLATE
	AREAS CHECKED
	AREAS CHECKED

DATE	
BY	
ORIGINAL SURVEY	SURVEYED
NOTE BOOK	PLOTTED
NO.	TEMPLATE
	AREAS CHECKED
	AREAS CHECKED

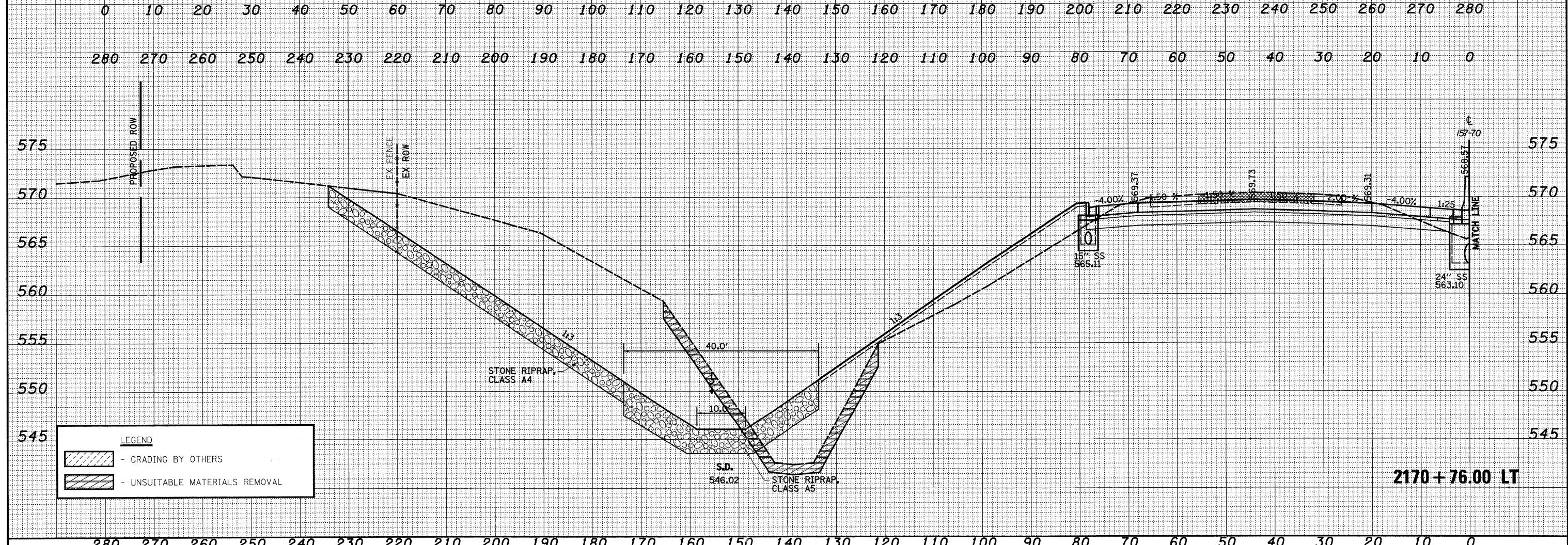
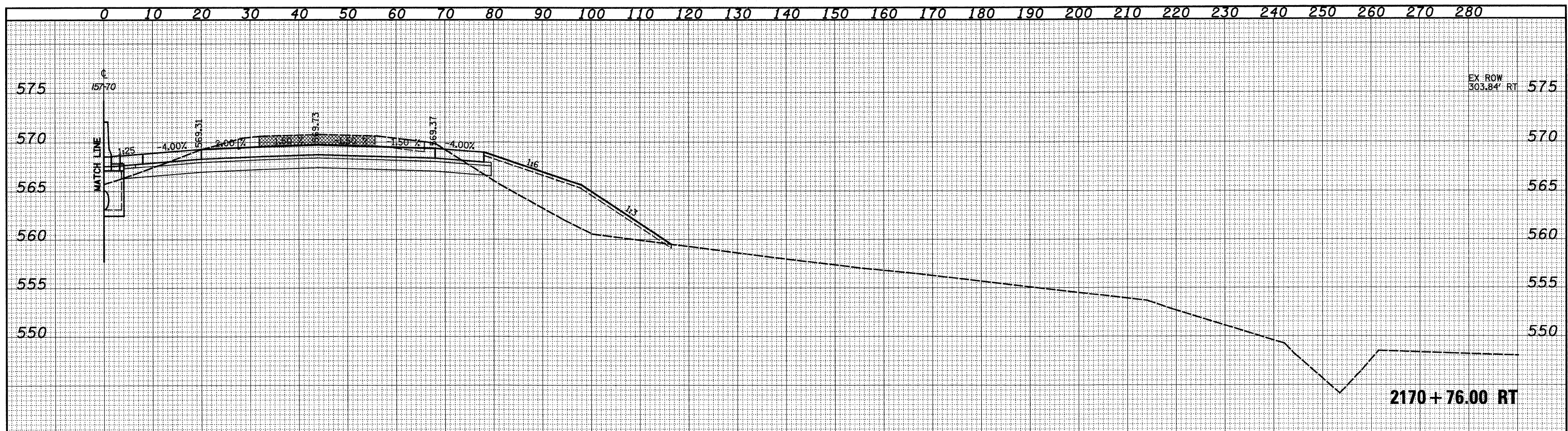

LEGEND	
	- GRADING BY OTHERS
	- UNSUITABLE MATERIALS REMOVAL

FILE NAME =	USER NAME = John	DESIGNED - JWS	REVISOR -	STATE OF ILLINOIS DEPARTMENT OF TRANSPORTATION	CROSS SECTIONS FAI 57/70	FAI	SECTION	COUNTY	TOTAL SHEETS	SHEET NO.
S:\projects\MD\007257\pdr\ML_keller\ash\han_keller.dwg		DRAWN - LEC	REVISOR -			57/70	(25-3,4)R	EFFINGHAM	1098	510
PLOT SCALE = 20.0000' / IN.		CHECKED - BRM	REVISOR -			SCALE: 1"=10'		CONTRACT NO. 74299		
PLOT DATE = 3/20/2011		DATE - 4-01-08	REVISOR -			SHEET NO. 84 OF 199 SHEETS		FED. ROAD DIST. NO. ILLINOIS FED. AID PROJECT		
				STA. 2170+76.00 TO STA. 2170+76.00						