

DATE	
BY	
FINAL SURVEY	SURVEYED
NOTE BOOK NO.	PLOTTED
	TEMPLATE
	AREAS CHECKED

DATE	
BY	
ORIGINAL SURVEY	SURVEYED
NOTE BOOK NO.	PLOTTED
	TEMPLATE
	AREAS CHECKED

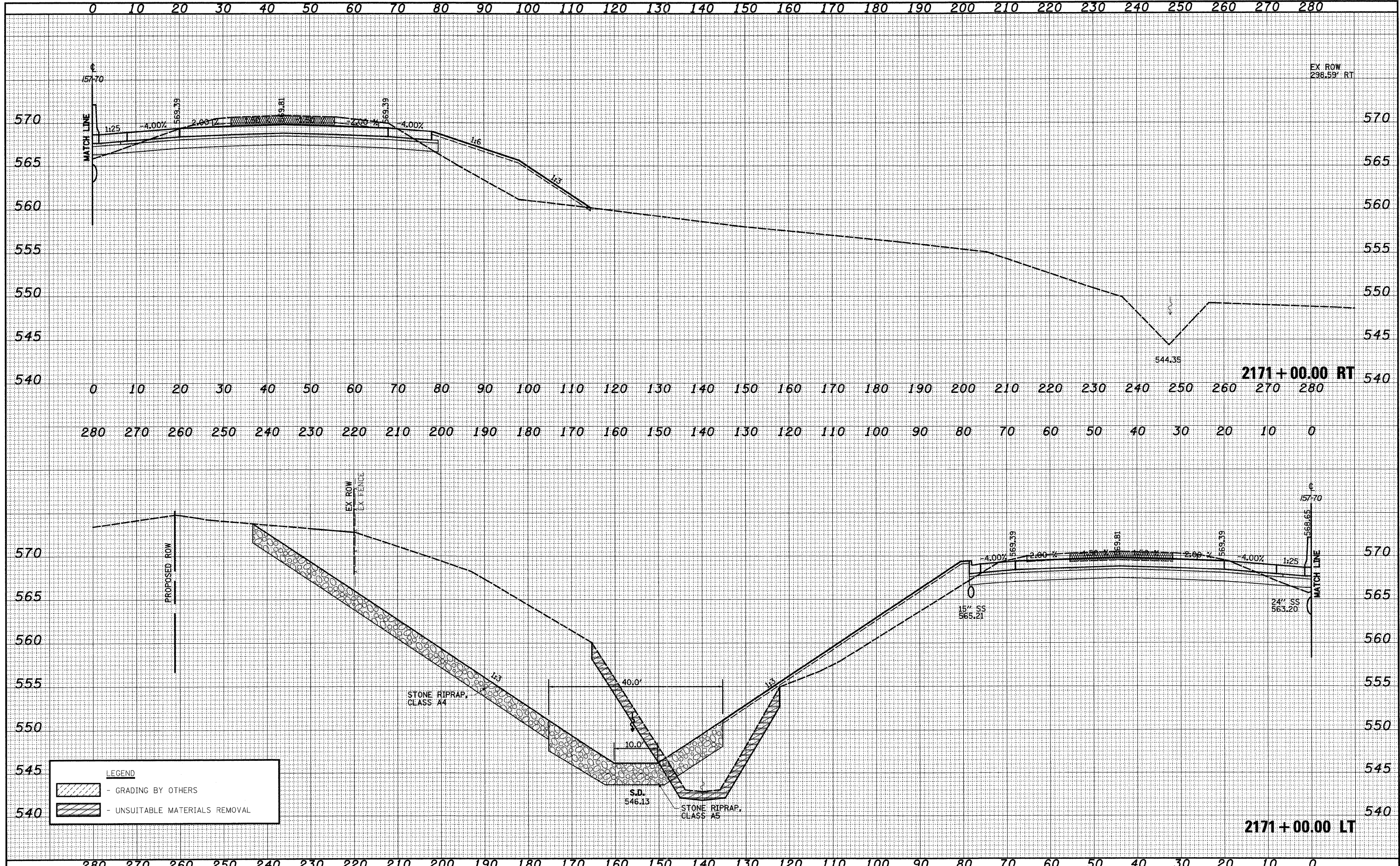

FILE NAME =	USER NAME = John	DESIGNED - JWS	REVISED -	STATE OF ILLINOIS DEPARTMENT OF TRANSPORTATION	CROSS SECTIONS FAI 57/70	F.A.I. RTE. 57/70	SECTION (25-3,4)R	COUNTY EFFINGHAM	TOTAL SHEETS 1098	SHEET NO. 511	
S:\Projects\MD\007257\70dgn\ML_John\csh\plan\5770.dgn	PLOT SCALE = 20.00000' / IN.	DRAWN - LEC	REVISED -			SCALE: 1"=10'	SHEET NO. 85 OF 199 SHEETS	STA. 2171+00.00 TO STA. 2171+00.00	FED. ROAD DIST. NO.	ILLINOIS FED. AID PROJECT	CONTRACT NO. 74299
	PLOT DATE = 3/20/2011	CHECKED - BRM	REVISED -								
		DATE - 4-01-08	REVISED -								