

DATE	
BY	
FINAL SURVEY	SURVEYED
NOTE BOOK NO.	PLOTTED
	TEMPLATE
	AREAS CHECKED

DATE	
BY	
ORIGINAL SURVEY	SURVEYED
NOTE BOOK NO.	PLOTTED
	TEMPLATE
	AREAS CHECKED

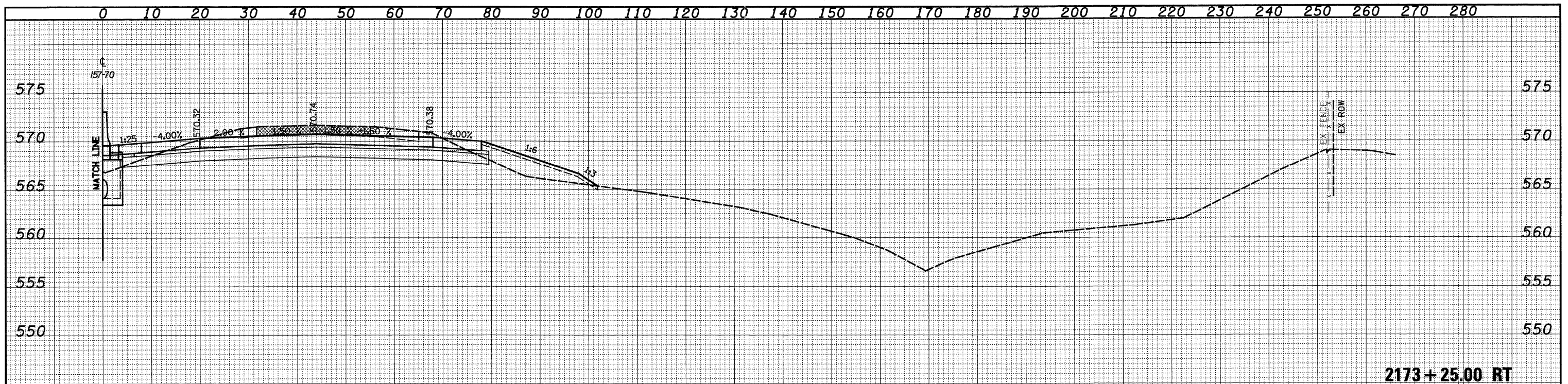

2173+25.00 RT

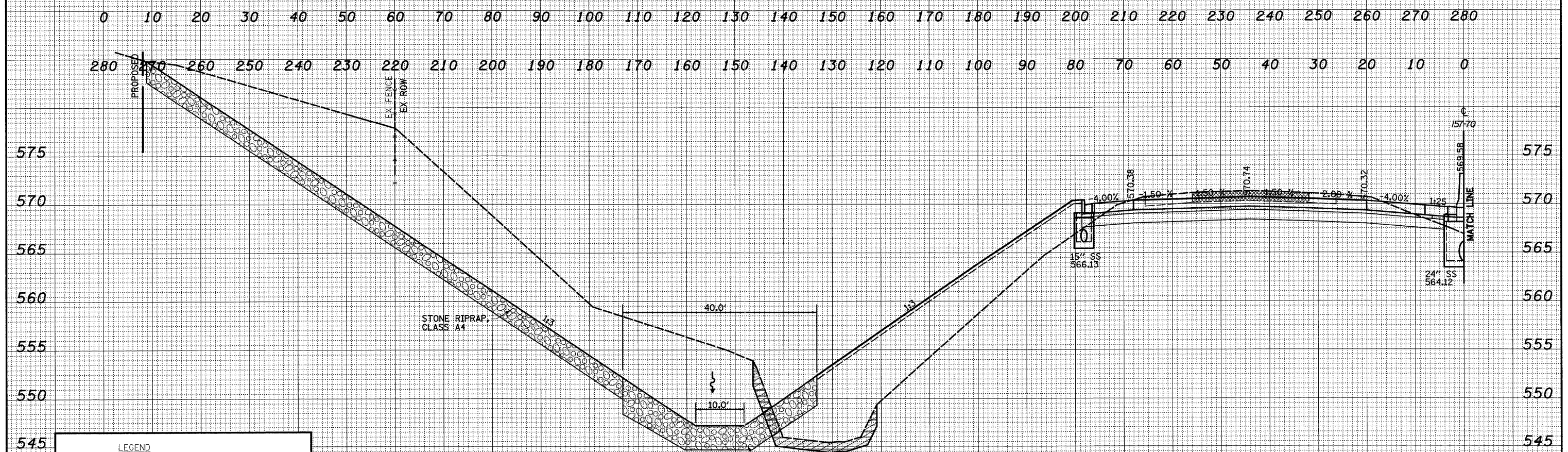

2173+25.00 LT

LEGEND	
	- GRADING BY OTHERS
	- UNSUITABLE MATERIALS REMOVAL

FILE NAME =	USER NAME = John	DESIGNED - JWS	REVISED -	<b>STATE OF ILLINOIS DEPARTMENT OF TRANSPORTATION</b>	<b>CROSS SECTIONS FAI 57/70</b>		F.A.I. RTE. 57/70	SECTION (25-3,4)R	COUNTY EFFINGHAM	TOTAL SHEETS 1098	SHEET NO. 516	
S:\Projects\1007257-70\dy\ML_Keller\work\Plan_Keller.dwg	PLOT SCALE = 20.00000' / IN.	DRAWN - LEC	REVISED -		SCALE: 1"=10'	SHEET NO. 90 OF 199 SHEETS	STA. 2173+25.00 TO STA. 2173+25.00	FED. ROAD DIST. NO.	ILLINOIS FED. AID PROJECT	CONTRACT NO. 74299		
	PLOT DATE = 3/20/2011	CHECKED - BRM	REVISED -									
		DATE - 4-01-08	REVISED -									