

BY	DATE
FINAL SURVEY	SURVEYED
NOTE BOOK	PLOTTED
NO.	TEMPLATE
	AREAS CHECKED

BY	DATE
ORIGINAL SURVEY	SURVEYED
NOTE BOOK	PLOTTED
NO.	TEMPLATE
	AREAS CHECKED

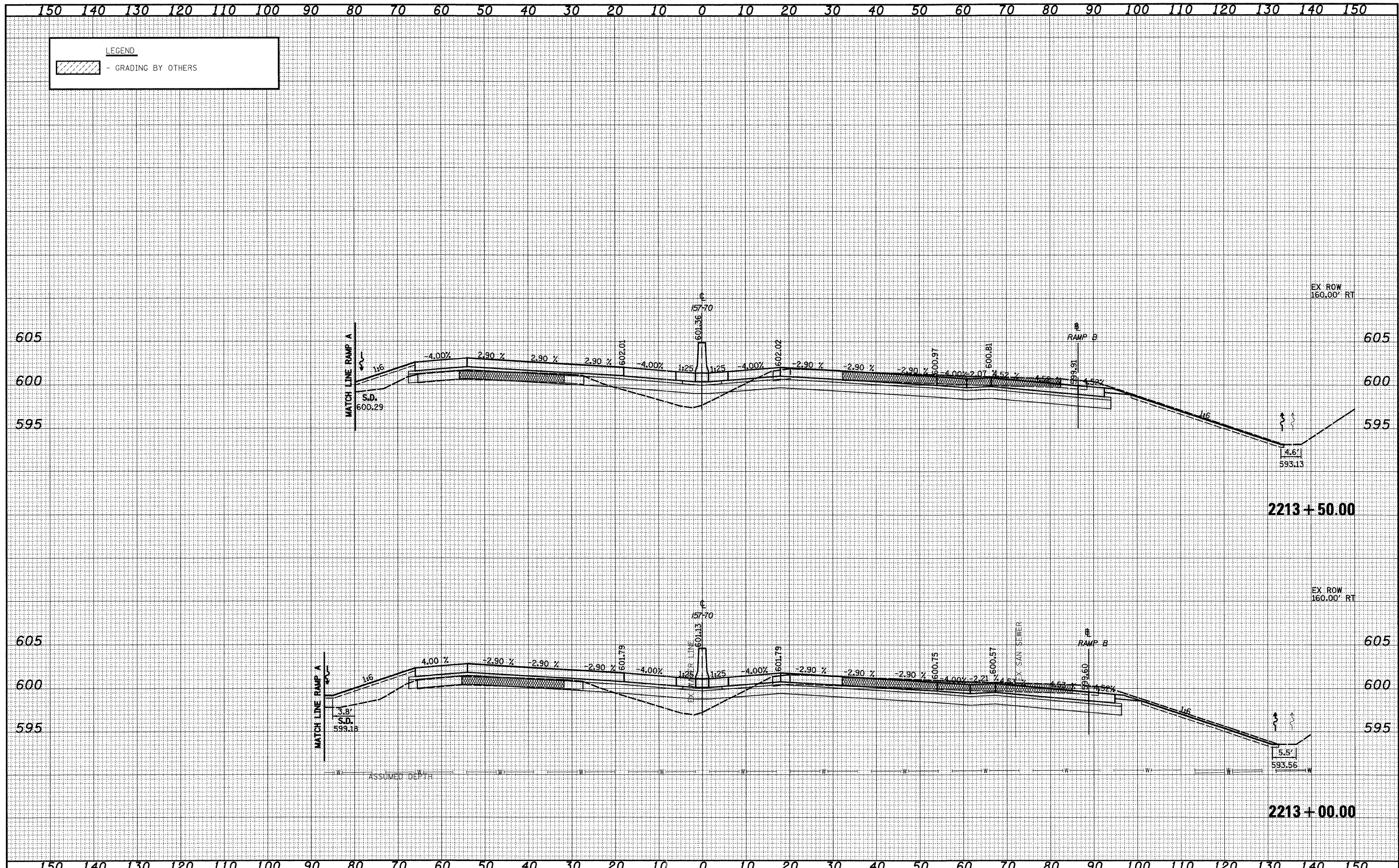

FILE NAME =	USER NAME = #USER#	DESIGNED - JWS	REVISED -	STATE OF ILLINOIS DEPARTMENT OF TRANSPORTATION	CROSS SECTIONS FAI 57/70	F.A.I. RTE.	SECTION	COUNTY	TOTAL SHEETS	SHEET NO.	
#109		DRAWN - LEC	REVISED -			57/70	(25-3,4R)	EFFINGHAM	1098	567	
		CHECKED - BRM	REVISED -			SCALE: 1"=10'	SHEET NO. 141 OF 199 SHEETS	STA. 2213+00.00 TO STA. 2213+50.00	CONTRACT NO. 74299		
		DATE - 4-01-08	REVISED -			FED. ROAD DIST. NO. (ILLINOIS) FED. AID PROJECT					