

DATE	
BY	
SURVEYED	
PLOTTED	
TEMPLATE	
NOTE BOOK	
AREAS CHECKED	
NO.	

DATE	
BY	
SURVEYED	
PLOTTED	
TEMPLATE	
NOTE BOOK	
AREAS CHECKED	
NO.	

LEGEND

- TEMPORARY PCC PAVEMENT
- REMOVAL
- DRUM
- TEMPORARY CONCRETE BARRIER
- DIRECTION OF TRAFFIC

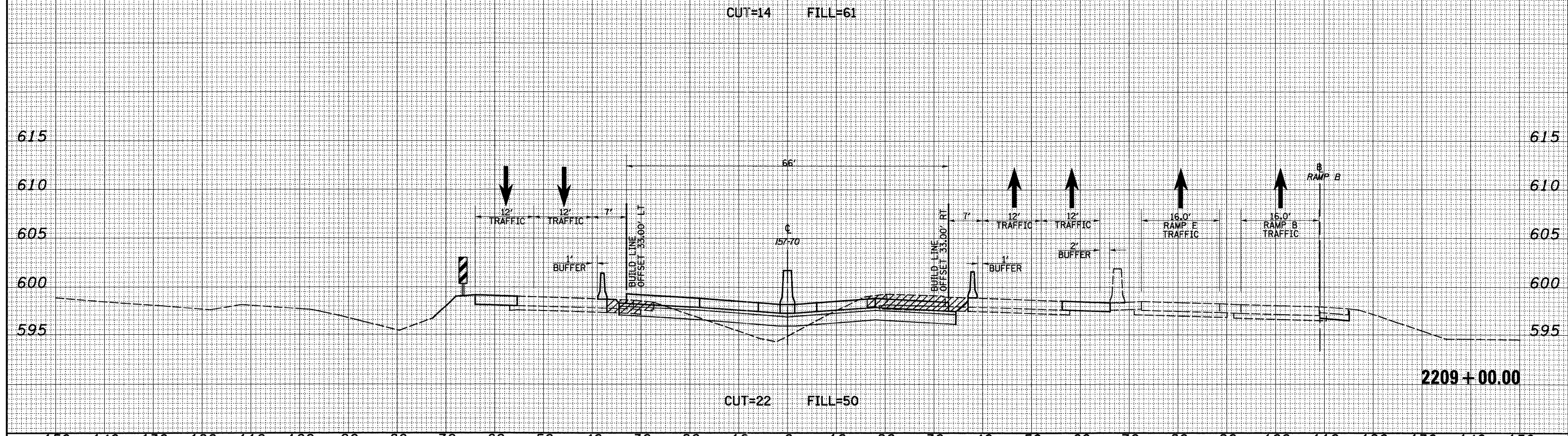
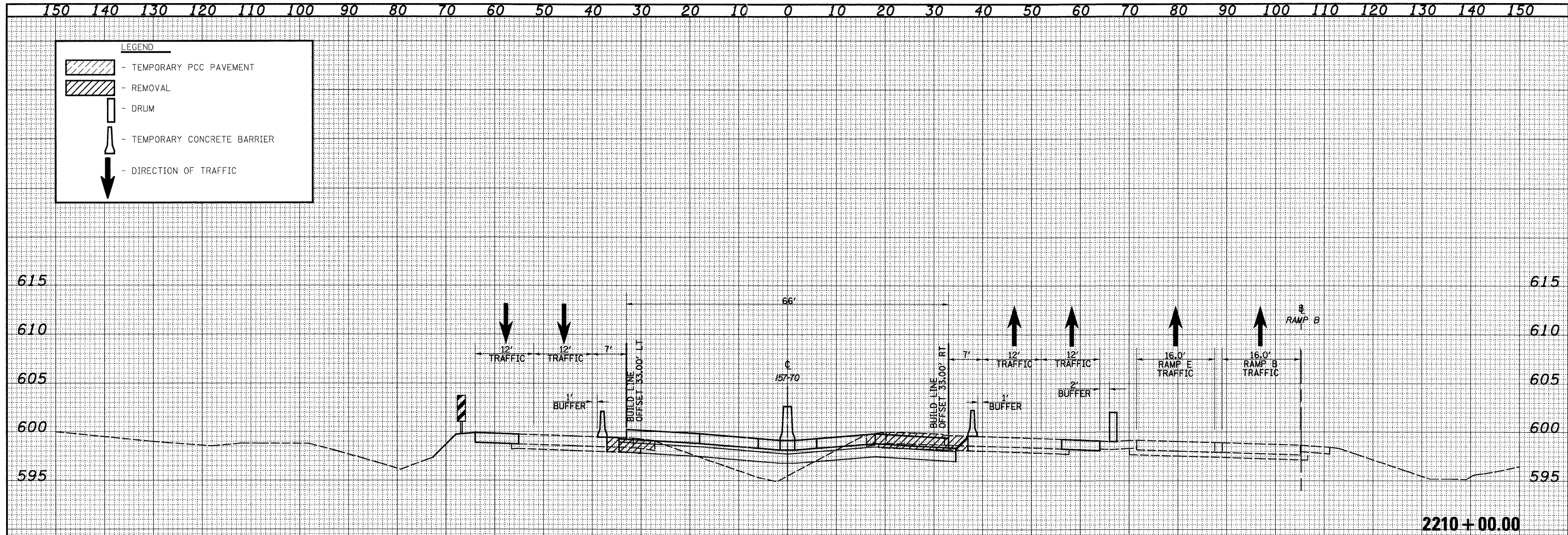

FILE NAME =	USER NAME = bseibej	DESIGNED - JWS	REVISED -	STATE OF ILLINOIS DEPARTMENT OF TRANSPORTATION	MAINTENANCE OF TRAFFIC - I57/70 (STAGE 1)		F.A.I. RTE. 57/70	SECTION (25-3,4)R	COUNTY EFFINGHAM	TOTAL SHEETS 1098	SHEET NO. 859
S:\Projects\403-00072-57-70\dgn\ML_keller\asht_molm07_Sldgn		DRAWN - LEC	REVISED -		SCALE: 1"=10'	SHEET NO. 55 OF 91 SHEETS	STA. 2209+00.00 TO STA. 2210+00.00	FED. ROAD DIST. NO.	ILLINOIS FED. AID PROJECT	CONTRACT NO. 74299	
		CHECKED - BRM	REVISED -								
		DATE - 4-01-08	REVISED -								