

STATE OF ILLINOIS
DEPARTMENT OF TRANSPORTATION

ROUTE NO.	SECTION	COUNTY	SHEET NO.	TOTAL SHEETS
17-B-3	17-B-3	WAYNE	32	6
SHEET NO. 1				
23 SHEETS				

Bench Mark: Elev. 124.264 West bearing seat North Abutment of existing structure.

Existing Structure: SN 096-0001. Built as F.A. Route 16, Section 17-B3 at Station 28+164.434 in 1958.
The structure is a three span continuous R.C. deck on wide flange beams, with a length of 43.764 m Bk. to Bk. of Abutments and 0. to 0. width of 10.535 m. Supported on pile bent abutments and solid piers on spread footings. The existing deck shall be removed and replaced with a wider deck, add new beams, and widen the substructure.
Stage construction shall be utilized.
No salvage

Note: All dimensions are in millimeters (mm) except as noted.

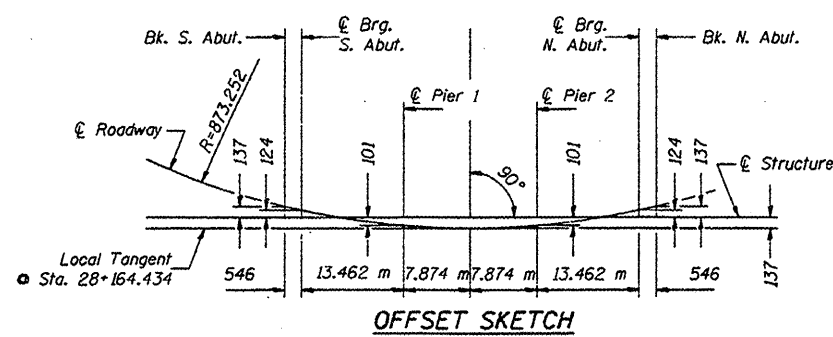

CURVE DATA
P.I. Sta. = 27+895.906
 $\Delta = 61^{\circ}33'30''$
R = 873.252 m
T = 520.129 m
L = 938.150 m
E = 143.168 m
S.E. = 3.2%

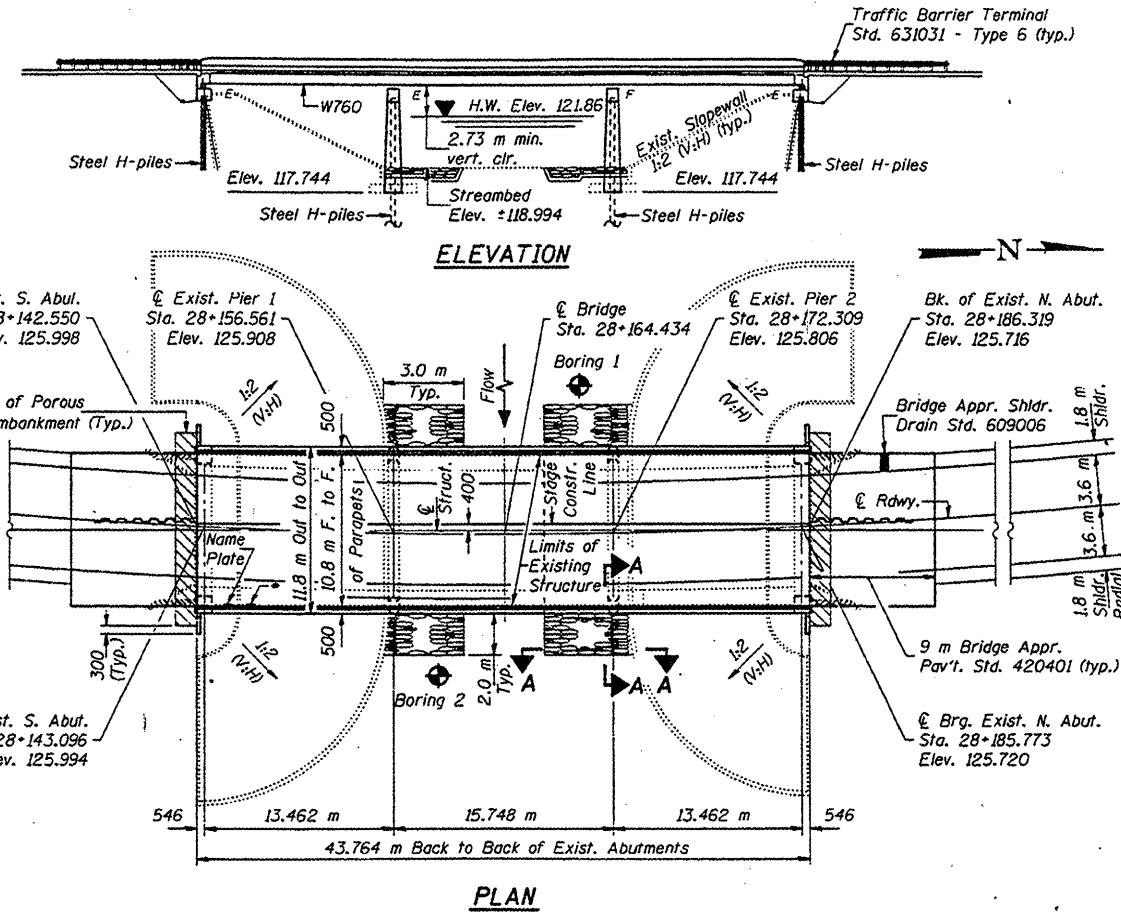
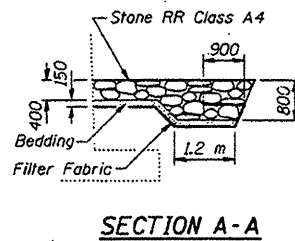
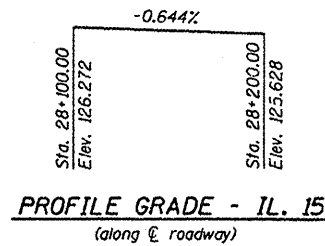

* Existing name plate to be cleaned and relocated. Cost is included with "Name Plates".

STATION 28+164.434
REBUILT BY
STATE OF ILLINOIS
F.A.P. RT. 821 SEC. 17-B-3
PROJECT BHF-821(31)
LOADING MS18
STR. NO. 096-0001
NAME PLATE
See Std. 515001

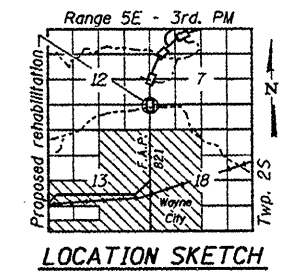

LOADING MS18
Allow 1.2 kN/m² for future wearing surface.

DESIGN SPECIFICATIONS
1992 AASHTO with 1993, 1994, and 1995 Interims
Seismic Retrofitting Manual for Highway Bridges
(May 1995) FHWA-RD-94-052

DESIGN STRESSES
FIELD UNITS
f_c = 24 MPa
f_y = 400 MPa (reinforcement)
f_s = 124 MPa (exist. steel)
f_s = 138 MPa (M270 Grade 250 New steel)

SEISMIC DATA
Seismic Performance Category (SPC) = B
Bedrock Acceleration Coefficient (A) = 0.094g
Site Coefficient (S) = L5

WATERWAY INFORMATION

Drainage Area = 20.46 km² Low Grade Elev. 124.84 @ Sta. 29+108.400

Flood	Freq. Yr.	Q m ³ /s	Opening m ²		Nat. Head - m		Headwater El.	
			Exist.	Prop.	H.W.E. Exist.	Prop.	Exist.	Prop.
Design	50	75.6	50.7	-	121.86	0.07	-	121.93
Base	100	87.2	56.4	-	122.07	0.07	-	122.14
Overtopping	-	-	-	-	-	-	-	-
Max. Calc.	500	114.6	72.8	-	122.63	0.13	-	122.77

DESIGNED: James E. [Signature]
CHECKED: Steven [Signature]
DRAWN: r.b. carbonell
CHECKED: JFS

EXAMINED: [Signature]
PASSED: [Signature]



EXPIRES 11-30-98

GENERAL PLAN
ILLINOIS ROUTE 15 OVER
SHOE CREEK
F.A.P. ROUTE 821 - SECTION 17-B-3
WAYNE COUNTY
STATION 28+164.434
STRUCTURE NO. 096-0001

LOCATION 1

3 of 16
74529