

STAGE 1A TRAFFIC CONTROL ITEMS

TEMPORARY PAVEMENT MARKING - 4" LINE MARKING	WORK ZONE PAVEMENT MARKING REMOVAL
FOOT	SQ FT
8,500	2,500

PRIOR TO STAGE 1A, REMOVE APPROXIMATELY 1355 LINEAR FEET OF TEMPORARY CONCRETE BARRIER ASSOCIATED WITH STRUCTURES 082-0167/-0168. ALSO PRIOR TO STAGE 1A, REMOVE TEMPORARY IMPACT ATTENUATORS PLACED AT STATIONS 240+45.57 AND 252+08.86 WITH STAGE 1. ALL OTHER BARRIERS AND ATTENUATORS PLACED IN STAGE 1 SHALL REMAIN.

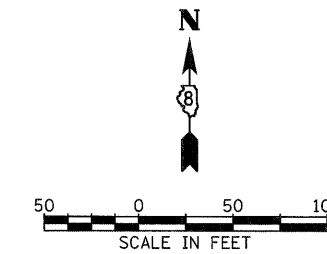

ALL TEMPORARY PAVEMENT MARKINGS AND BARRICADES PLACED IN STAGE 1 WEST OF STATION 229+02.67 SHALL REMAIN. SIGNS AND DEVICES ASSOCIATED WITH EASTBOUND LEFT LANE CLOSURE SHALL BE REMOVED.

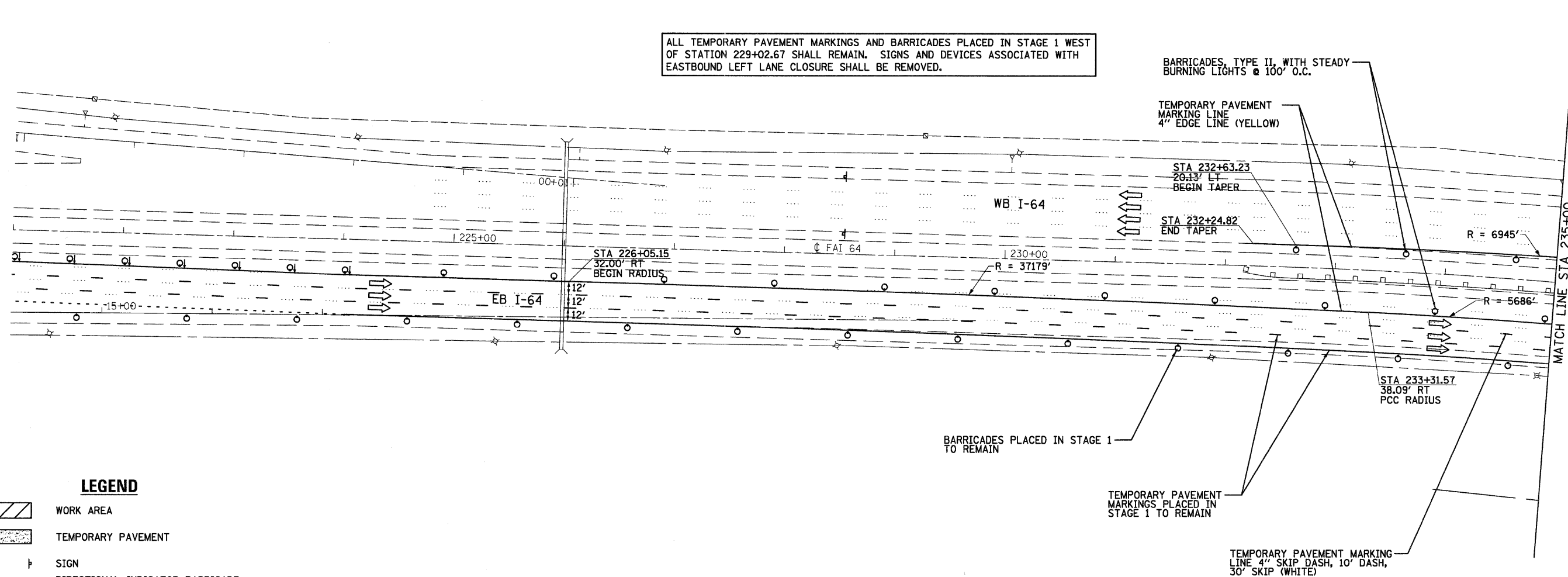

LEGEND

- WORK AREA
- TEMPORARY PAVEMENT
- SIGN
- DIRECTIONAL INDICATOR BARRICADE WITH STEADY BURNING LIGHTS
- TYPE II BARRICADES, DRUMS, OR VERTICAL BARRICADES WITH STEADY BURNING LIGHTS
- TYPE III BARRICADE
- TEMPORARY IMPACT ATTENUATOR
- TEMPORARY CONCRETE BARRIER
- PROPOSED PAVEMENT MARKING
- EXISTING PAVEMENT MARKING
- DIRECTIONAL ARROW (FOR INFORMATIONAL PURPOSES ONLY, DO NOT PAINT ON ROADWAY)

FILE NAME = D876415-sh1-Staging1A-01.dgn

USER NAME = tbonnell	DESIGNED -	REVISED -
PLLOT SCALE = 50.0000' / in.	DRAWN -	REVISED -
PLLOT DATE = 11/18/2011	CHECKED -	REVISED -
	DATE -	REVISED -

STATE OF ILLINOIS
DEPARTMENT OF TRANSPORTATION

SUGGESTED STAGES OF CONSTRUCTION AND TRAFFIC CONTROL - STAGE 1A

SCALE: 1"=50' SHEET NO. 1 OF 3 SHEETS STA. 221+00 TO STA. 235+00

F.A.I. RTE.	SECTION	COUNTY	TOTAL SHEETS	SHEET NO.
64	82-(3,4)RS	ST. CLAIR	167	42
CONTRACT NO. 76415				
FED. ROAD DISTRICT 8 ILLINOIS FED. AID PROJECT				