

EXISTING CROSS SECTION
 (Looking East @ \odot of Bridge)
 (All roadway dimensions are given radially)

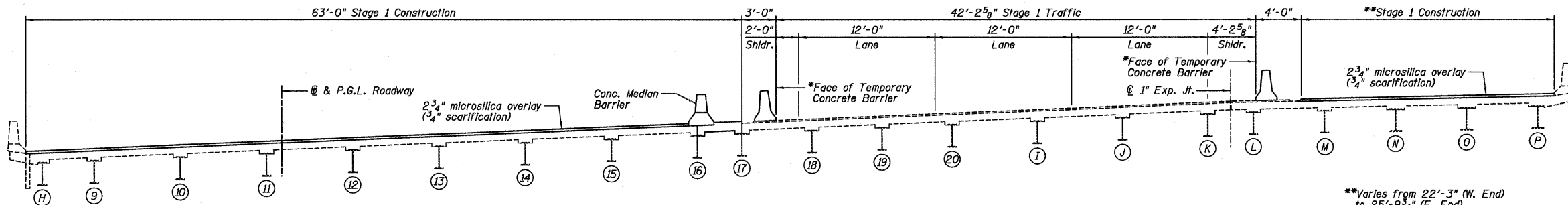

STAGE 1 CONSTRUCTION
 (Looking East @ \odot of Bridge)
 *Temporary Concrete Barrier, See Std. 704001

**Varies from 22'-3" (W. End) to 25'-9³/₄" (E. End)

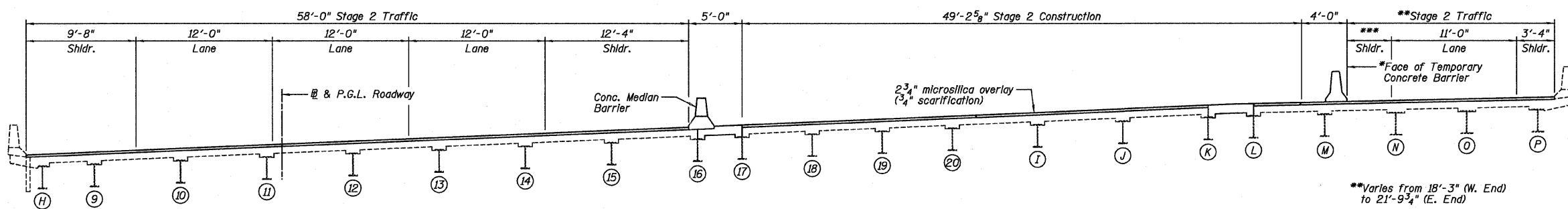

STAGE 2 CONSTRUCTION
 (Looking East @ \odot of Bridge)
 *Temporary Concrete Barrier, See Std. 704001

**Varies from 18'-3" (W. End) to 21'-9³/₄" (E. End)

***Varies from 3'-11" (W. End) to 7'-5³/₄" (E. End)

NOTE:
 See Roadway Plans for Temporary Concrete Barrier quantities.

Farnsworth
 GROUP, INC.
 2709 McGraw Drive
 Bloomington, Illinois 61704
 309/863-8435, 309/863-1571 fax

DESIGNED - JCZ
 CHECKED - JML
 DRAWN - DJM/JWK
 DATE - 12/05/11

REVISED
 REVISED
 REVISED
 REVISED

STATE OF ILLINOIS
DEPARTMENT OF TRANSPORTATION

STAGE CONSTRUCTION, EASTBOUND ROADWAY
STRUCTURE NO. 082-0169 (E.B.)
STRUCTURE NO. 082-0170 (W.B.)

SHEET NO. B3 OF 34 SHEETS

F.A.I. RTE.	SECTION	COUNTY	TOTAL SHEETS	SHEET NO.
64	B2-(3,4)RS	ST. CLAIR	167	124
				CONTRACT NO. 76415
ILLINOIS FED. AID PROJECT				