

MAINTENANCE OF TRAFFIC LEGEND

- WORK ZONE
- TRAFFIC FLOW
- EXISTING SIGN
- PROPOSED SIGN
- BARRICADE, TYPE III
- BARRELS/DRUMS (SPACED AT 25' CENTERS)

NOTE:
THE CONTRACTOR SHALL LIMIT THE LENGTH OF TIME THAT THE SIDEWALK IS CLOSED TO 14 CONTIGUOUS CALENDAR DAYS, OR AS APPROVED BY THE ENGINEER. THE CONTRACTOR SHALL PROVIDE THE VILLAGE OF FAIRMONT CITY FIRE AND POLICE DEPARTMENT WITH A 2 WEEK WRITTEN AND PHONE NOTICE PRIOR TO THE TEMPORARY CLOSURE OF THIS SIDEWALK.

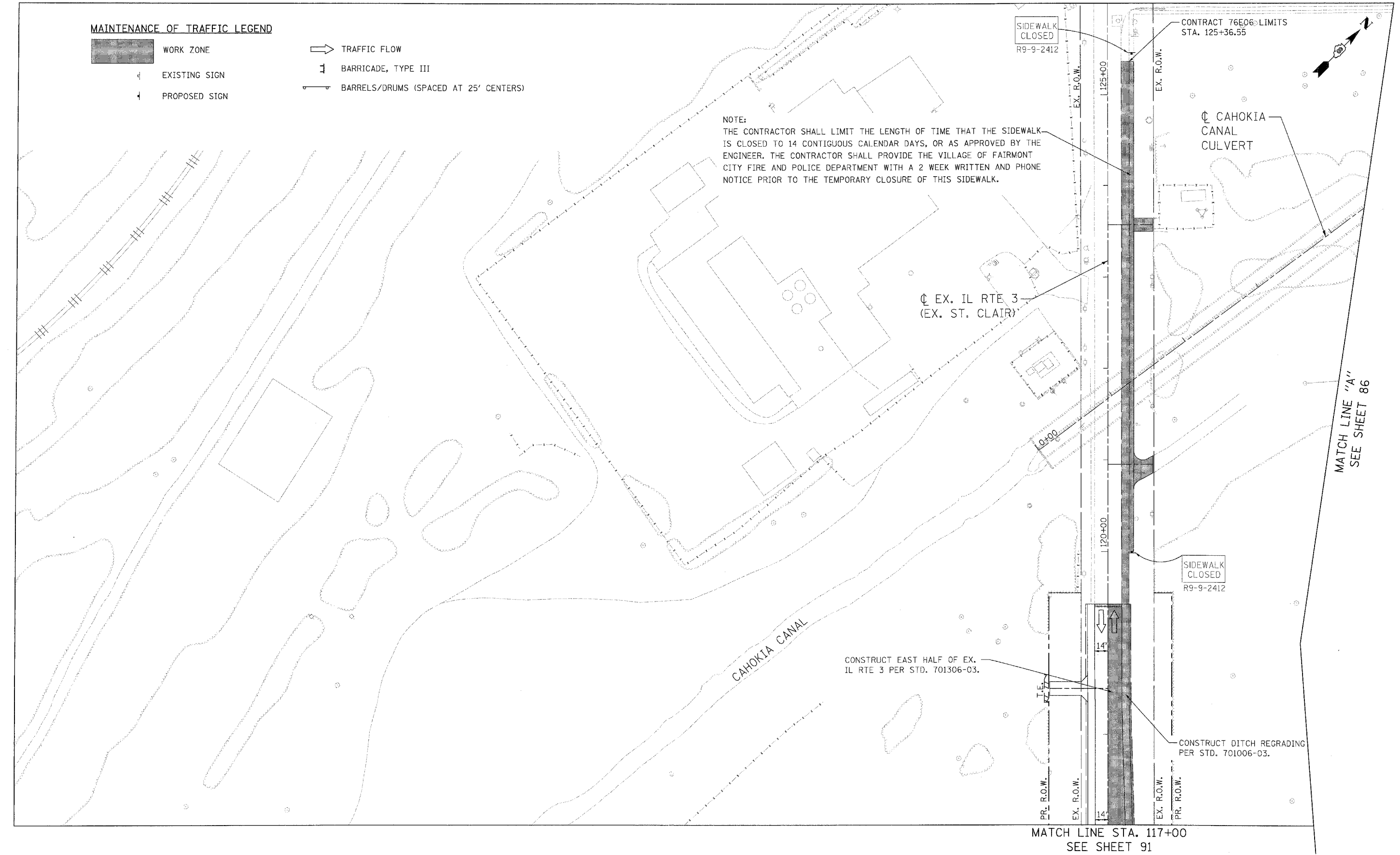

MATCH LINE "A"
SEE SHEET 86

MATCH LINE STA. 117+00
SEE SHEET 91

LE LIN ENGINEERING, LTD. Consulting Engineers <small>Chatham, Illinois Westmont, Illinois</small>	USER NAME = Plotted by Scott Wilkinson	DESIGNED - SEW	REVISED -	STATE OF ILLINOIS DEPARTMENT OF TRANSPORTATION				EX. IL RTE. 3 (ST. CLAIR AVE.) MAINTENANCE OF TRAFFIC - STAGE 2 STA. 117 + 00 TO 126 + 00				F.A.P. RTE. 998	SECTION 82-2-1K	COUNTY ST. CLAIR	TOTAL SHEETS 353	SHEET NO. 90
	PLOT SCALE = 50.0000' / IN.	DRAWN - RK	REVISED -					CHECKED - ST	REVISED -	PROPOSED RELOCATED ILLINOIS ROUTE 3 INTERCHANGE				SCALE: 1"=50'	SHEET NO. 11 OF 15 SHEETS	STA. _____ TO STA. _____
	PLOT DATE = 10/18/2011	DATE - 10/21/11	REVISED -									ILLINOIS FED. AID PROJECT				