

LEGEND

- EX. INLET
- EX. CATCH BASIN
- ⊙ EX. MANHOLE
- EX. STORM SEWER
- EX. UNDERDRAIN
- EX. SANITARY SEWER
- COMBINED STORM SEWER
- EX. GAS MAIN
- EX. WATER MAIN
- UNK. — UNKNOWN TYPE
- ▷ EX. END SECTION
- ▢ EX. CONCRETE HEADWALL
- ~ EX. DITCH
- EX. SWALE
- PIPE REMOVAL
- Ⓜ UTILITY STRUCTURE REMOVAL
- Ⓜ ADJ MANHOLES TO BE ADJUSTED
- Ⓜ VA VALVE VAULTS TO BE ADJUSTED

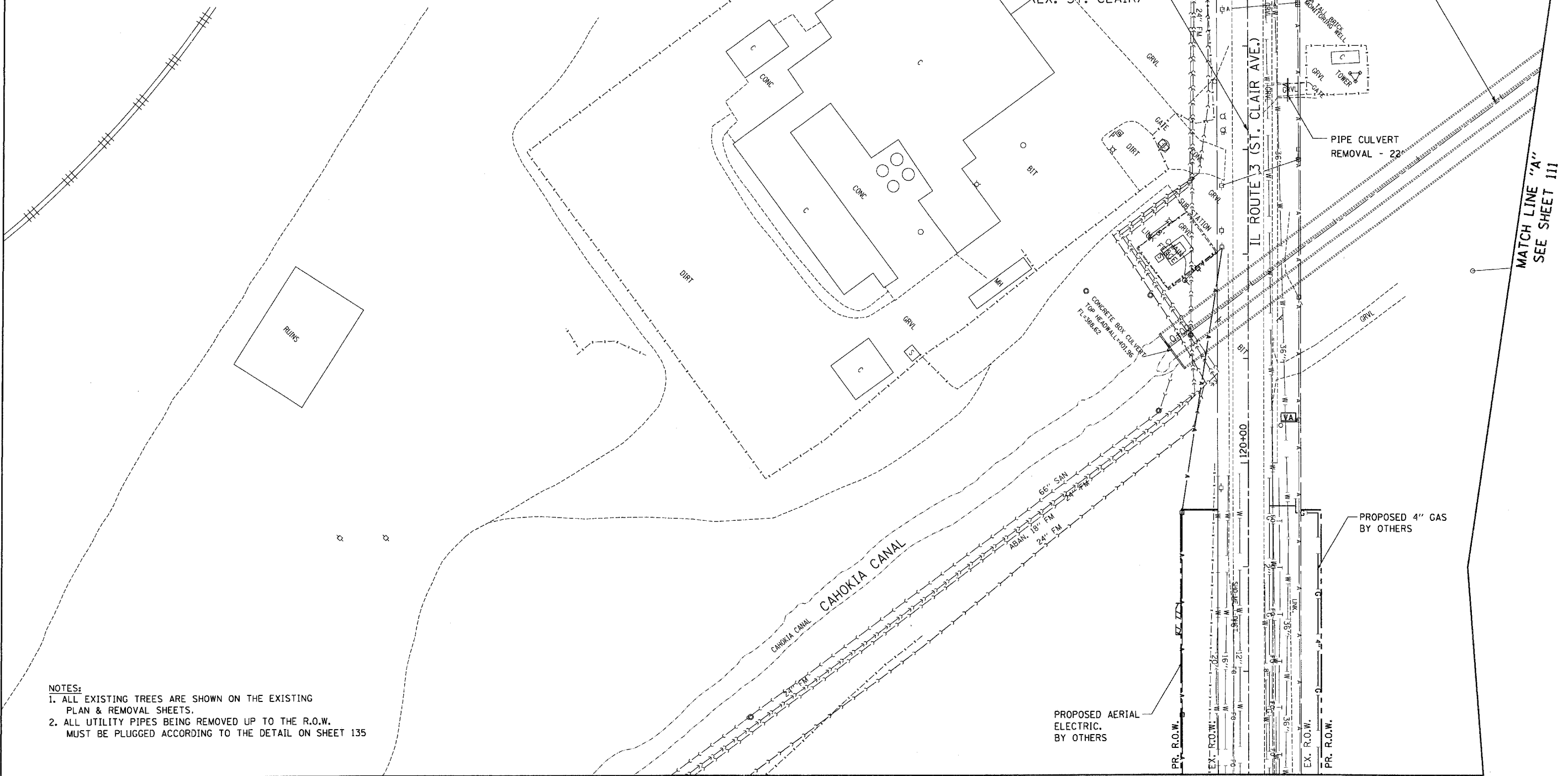

- NOTES:**
1. ALL EXISTING TREES ARE SHOWN ON THE EXISTING PLAN & REMOVAL SHEETS.
 2. ALL UTILITY PIPES BEING REMOVED UP TO THE R.O.W. MUST BE PLUGGED ACCORDING TO THE DETAIL ON SHEET 135

\D:\CONTRACTS\99-MOTIF.LDGN, \D:\CONTRACTS\11-LEGEND.LDGN, \D:\CONTRACTS\11-LAYOUT.LDGN, \D:\CONTRACTS\11-PLAN & REMOVAL SHEETS, \D:\CONTRACTS\11-SHT-DRN\112-11786.LDGN
 18-19-2011, 15:04:43
 BONDHOLD \S:\S:\04\AMV\VAULT.D, TRANS. 87, 2282, 2885B-081\CIVIL\CAO\99, ALL CONTRACTS\CONNS\SHEETS, CONTRACT 11, \D:\CONTRACTS\11-SHT-DRN\112-11786.LDGN

FILE NAME = #FILE#	USER NAME = #USER#	DESIGNED - JB DRAWN - JB CHECKED - ACL DATE - 10/21/11	REVISED - REVISED - REVISED - REVISED -	STATE OF ILLINOIS DEPARTMENT OF TRANSPORTATION PROPOSED RELOCATED IL ROUTE 3 INTERCHANGE	EXISTING ST. CLAIR AVENUE EXISTING DRAINAGE & UTILITIES STA. 117+00 TO 126+00	F.A.P. RTE. 998 SECTION 82-2-1K COUNTY ST. CLAIR ILLINOIS FED. AID PROJECT	TOTAL SHEETS 353 SHEET NO. 115 CONTRACT NO. 76E06
SCALE: 1"=50'				SHEET NO. 5 OF 7 SHEETS		STA. TO STA.	