

MATCH LINE STA. 109+00
SEE SHEET 194

MATCH LINE STA. 22+50
SEE SHEET 194

MATCH LINE STA. 1679+30
SEE SHEET 189

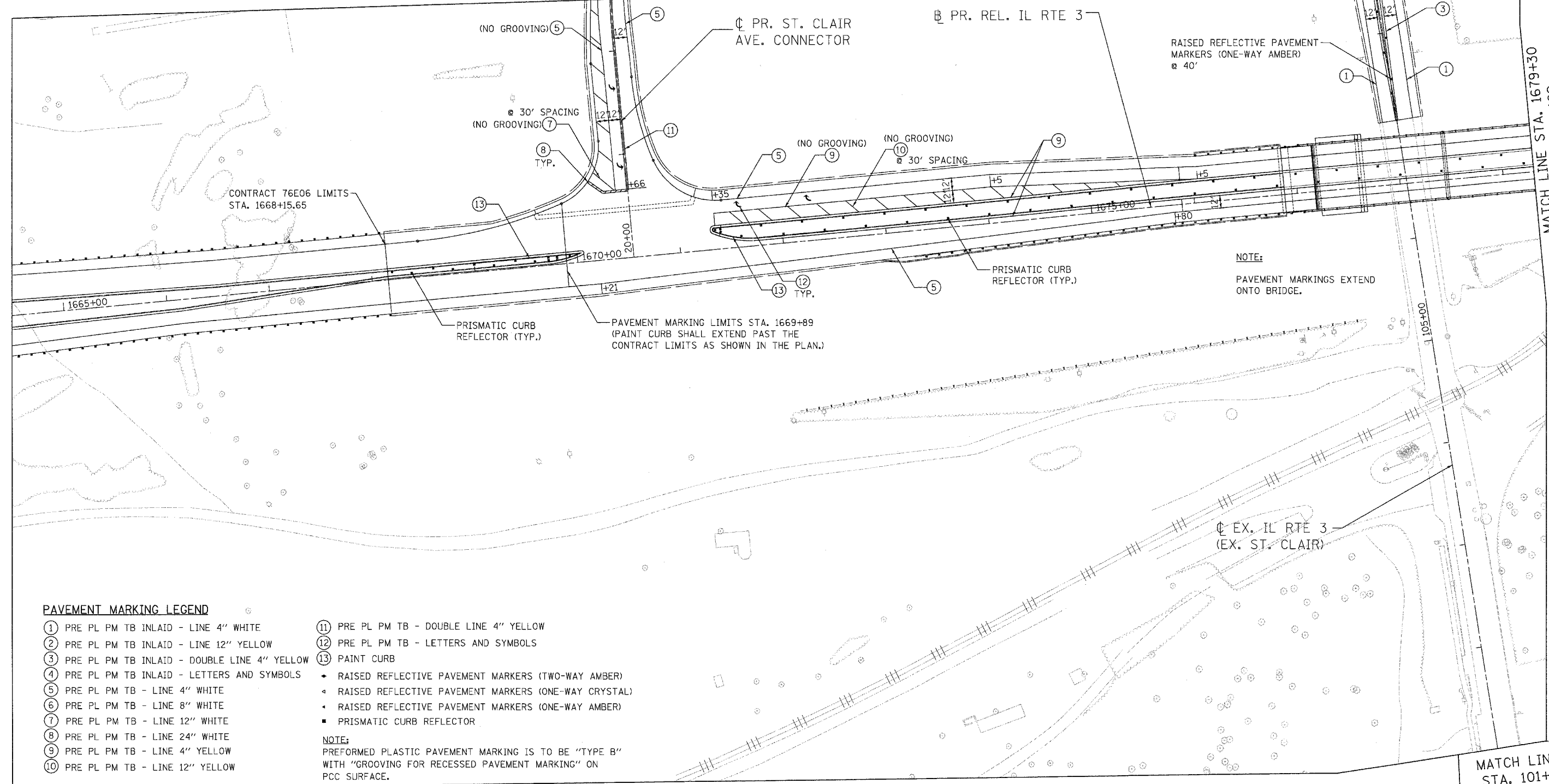

PAVEMENT MARKING LEGEND

- | | |
|---|--|
| ① PRE PL PM TB INLAID - LINE 4" WHITE | ⑪ PRE PL PM TB - DOUBLE LINE 4" YELLOW |
| ② PRE PL PM TB INLAID - LINE 12" YELLOW | ⑫ PRE PL PM TB - LETTERS AND SYMBOLS |
| ③ PRE PL PM TB INLAID - DOUBLE LINE 4" YELLOW | ⑬ PAINT CURB |
| ④ PRE PL PM TB INLAID - LETTERS AND SYMBOLS | • RAISED REFLECTIVE PAVEMENT MARKERS (TWO-WAY AMBER) |
| ⑤ PRE PL PM TB - LINE 4" WHITE | • RAISED REFLECTIVE PAVEMENT MARKERS (ONE-WAY CRYSTAL) |
| ⑥ PRE PL PM TB - LINE 8" WHITE | • RAISED REFLECTIVE PAVEMENT MARKERS (ONE-WAY AMBER) |
| ⑦ PRE PL PM TB - LINE 12" WHITE | ▪ PRISMATIC CURB REFLECTOR |
| ⑧ PRE PL PM TB - LINE 24" WHITE | |
| ⑨ PRE PL PM TB - LINE 4" YELLOW | |
| ⑩ PRE PL PM TB - LINE 12" YELLOW | |
- NOTE:**
PREFORMED PLASTIC PAVEMENT MARKING IS TO BE "TYPE B" WITH "GROOVING FOR RECESSED PAVEMENT MARKING" ON PCC SURFACE.

MATCH LINE STA. 101+00
SEE SHEET 190

LIN ENGINEERING, LTD.
Consulting Engineers
Channah, Illinois
Westmont, Illinois

| | | |
|--|-----------------|-----------|
| USER NAME = Plotted by Scott Wilkinson | DESIGNED - AS | REVISED - |
| PLOT SCALE = 50.0000' / IN. | DRAWN - AS | REVISED - |
| PLOT DATE = 10/17/2011 | CHECKED - ST | REVISED - |
| | DATE - 10/21/11 | REVISED - |

STATE OF ILLINOIS
DEPARTMENT OF TRANSPORTATION
PROPOSED RELOCATED ILLINOIS ROUTE 3 INTERCHANGE

PR. REL. IL RTE. 3, PR. ST. CLAIR AVE. CONNECTOR AND EX. IL RTE. 3
PAVEMENT MARKING PLANS
STA. 1665+00 TO STA. 1679+30
SCALE: 1"=50' SHEET NO. 8 OF 8 SHEETS STA. TO STA.

| F.A.P. RTE. | SECTION | COUNTY | TOTAL SHEETS | SHEET NO. |
|---|---------|-----------|--------------------|-----------|
| 998 | 82-2-1K | ST. CLAIR | 353 | 195 |
| FED. ROAD DIST. NO. ILLINOIS FED. AID PROJECT | | | CONTRACT NO. 76E06 | |