

**SECTION**

- NOTES:**
- CENTERLINE JOINT REMAINS IN THE CENTER WHEN RAMP TRANSITIONS TO TWO (2) LANES AT 12' EACH.
  - ALL BARS TO BE EPOXY COATED.

\* THE 15' DIMENSION SHALL BE ADJUSTED TO 12' MIN. TO 18' MAX. WHEN PLACED ADJACENT TO EXISTING PCC PAVEMENT STRUCTURE SO THAT JOINTS ARE IN PROLONGATION.

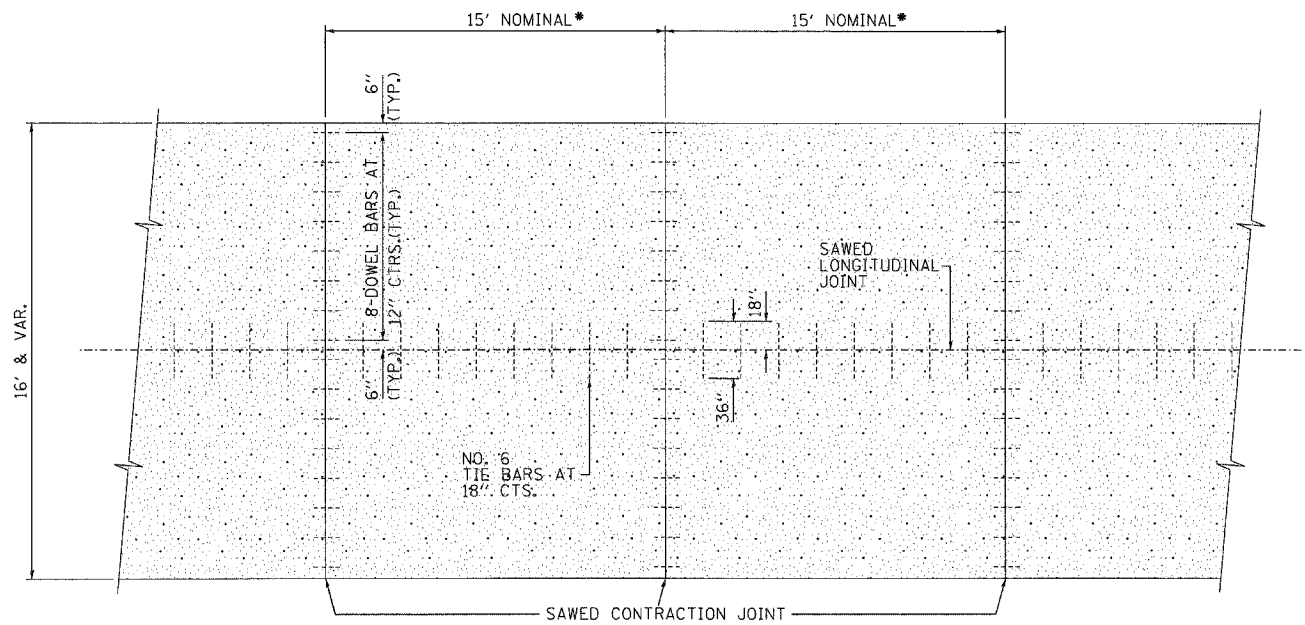

**PLAN**

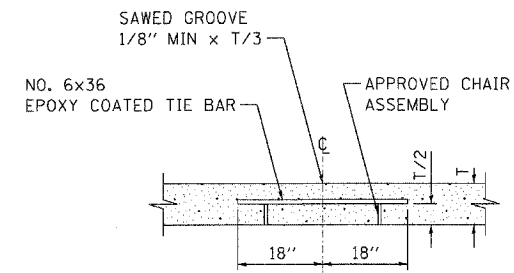

**SAWED LONGITUDINAL JOINT**

\\BDCDN-99-4017\F1.DGN ... \BDCDN-11-BORDER.DGN  
 \\BDCDN-99-4017\F2.DGN ... \BDCDN-11-BORDER.DGN  
 \\BDCDN-99-4017\F3.DGN ... \BDCDN-11-BORDER.DGN  
 \\BDCDN-99-4017\F4.DGN ... \BDCDN-11-BORDER.DGN  
 \\BDCDN-99-4017\F5.DGN ... \BDCDN-11-BORDER.DGN  
 \\BDCDN-99-4017\F6.DGN ... \BDCDN-11-BORDER.DGN  
 \\BDCDN-99-4017\F7.DGN ... \BDCDN-11-BORDER.DGN  
 \\BDCDN-99-4017\F8.DGN ... \BDCDN-11-BORDER.DGN  
 \\BDCDN-99-4017\F9.DGN ... \BDCDN-11-BORDER.DGN  
 \\BDCDN-99-4017\F10.DGN ... \BDCDN-11-BORDER.DGN  
 \\BDCDN-99-4017\F11.DGN ... \BDCDN-11-BORDER.DGN  
 \\BDCDN-99-4017\F12.DGN ... \BDCDN-11-BORDER.DGN  
 \\BDCDN-99-4017\F13.DGN ... \BDCDN-11-BORDER.DGN  
 \\BDCDN-99-4017\F14.DGN ... \BDCDN-11-BORDER.DGN  
 \\BDCDN-99-4017\F15.DGN ... \BDCDN-11-BORDER.DGN  
 \\BDCDN-99-4017\F16.DGN ... \BDCDN-11-BORDER.DGN  
 \\BDCDN-99-4017\F17.DGN ... \BDCDN-11-BORDER.DGN  
 \\BDCDN-99-4017\F18.DGN ... \BDCDN-11-BORDER.DGN  
 \\BDCDN-99-4017\F19.DGN ... \BDCDN-11-BORDER.DGN  
 \\BDCDN-99-4017\F20.DGN ... \BDCDN-11-BORDER.DGN  
 \\BDCDN-99-4017\F21.DGN ... \BDCDN-11-BORDER.DGN  
 \\BDCDN-99-4017\F22.DGN ... \BDCDN-11-BORDER.DGN  
 \\BDCDN-99-4017\F23.DGN ... \BDCDN-11-BORDER.DGN  
 \\BDCDN-99-4017\F24.DGN ... \BDCDN-11-BORDER.DGN  
 \\BDCDN-99-4017\F25.DGN ... \BDCDN-11-BORDER.DGN  
 \\BDCDN-99-4017\F26.DGN ... \BDCDN-11-BORDER.DGN  
 \\BDCDN-99-4017\F27.DGN ... \BDCDN-11-BORDER.DGN  
 \\BDCDN-99-4017\F28.DGN ... \BDCDN-11-BORDER.DGN  
 \\BDCDN-99-4017\F29.DGN ... \BDCDN-11-BORDER.DGN  
 \\BDCDN-99-4017\F30.DGN ... \BDCDN-11-BORDER.DGN  
 \\BDCDN-99-4017\F31.DGN ... \BDCDN-11-BORDER.DGN  
 \\BDCDN-99-4017\F32.DGN ... \BDCDN-11-BORDER.DGN  
 \\BDCDN-99-4017\F33.DGN ... \BDCDN-11-BORDER.DGN  
 \\BDCDN-99-4017\F34.DGN ... \BDCDN-11-BORDER.DGN  
 \\BDCDN-99-4017\F35.DGN ... \BDCDN-11-BORDER.DGN  
 \\BDCDN-99-4017\F36.DGN ... \BDCDN-11-BORDER.DGN  
 \\BDCDN-99-4017\F37.DGN ... \BDCDN-11-BORDER.DGN  
 \\BDCDN-99-4017\F38.DGN ... \BDCDN-11-BORDER.DGN  
 \\BDCDN-99-4017\F39.DGN ... \BDCDN-11-BORDER.DGN  
 \\BDCDN-99-4017\F40.DGN ... \BDCDN-11-BORDER.DGN  
 \\BDCDN-99-4017\F41.DGN ... \BDCDN-11-BORDER.DGN  
 \\BDCDN-99-4017\F42.DGN ... \BDCDN-11-BORDER.DGN  
 \\BDCDN-99-4017\F43.DGN ... \BDCDN-11-BORDER.DGN  
 \\BDCDN-99-4017\F44.DGN ... \BDCDN-11-BORDER.DGN  
 \\BDCDN-99-4017\F45.DGN ... \BDCDN-11-BORDER.DGN  
 \\BDCDN-99-4017\F46.DGN ... \BDCDN-11-BORDER.DGN  
 \\BDCDN-99-4017\F47.DGN ... \BDCDN-11-BORDER.DGN  
 \\BDCDN-99-4017\F48.DGN ... \BDCDN-11-BORDER.DGN  
 \\BDCDN-99-4017\F49.DGN ... \BDCDN-11-BORDER.DGN  
 \\BDCDN-99-4017\F50.DGN ... \BDCDN-11-BORDER.DGN  
 \\BDCDN-99-4017\F51.DGN ... \BDCDN-11-BORDER.DGN  
 \\BDCDN-99-4017\F52.DGN ... \BDCDN-11-BORDER.DGN  
 \\BDCDN-99-4017\F53.DGN ... \BDCDN-11-BORDER.DGN  
 \\BDCDN-99-4017\F54.DGN ... \BDCDN-11-BORDER.DGN  
 \\BDCDN-99-4017\F55.DGN ... \BDCDN-11-BORDER.DGN  
 \\BDCDN-99-4017\F56.DGN ... \BDCDN-11-BORDER.DGN  
 \\BDCDN-99-4017\F57.DGN ... \BDCDN-11-BORDER.DGN  
 \\BDCDN-99-4017\F58.DGN ... \BDCDN-11-BORDER.DGN  
 \\BDCDN-99-4017\F59.DGN ... \BDCDN-11-BORDER.DGN  
 \\BDCDN-99-4017\F60.DGN ... \BDCDN-11-BORDER.DGN  
 \\BDCDN-99-4017\F61.DGN ... \BDCDN-11-BORDER.DGN  
 \\BDCDN-99-4017\F62.DGN ... \BDCDN-11-BORDER.DGN  
 \\BDCDN-99-4017\F63.DGN ... \BDCDN-11-BORDER.DGN  
 \\BDCDN-99-4017\F64.DGN ... \BDCDN-11-BORDER.DGN  
 \\BDCDN-99-4017\F65.DGN ... \BDCDN-11-BORDER.DGN  
 \\BDCDN-99-4017\F66.DGN ... \BDCDN-11-BORDER.DGN  
 \\BDCDN-99-4017\F67.DGN ... \BDCDN-11-BORDER.DGN  
 \\BDCDN-99-4017\F68.DGN ... \BDCDN-11-BORDER.DGN  
 \\BDCDN-99-4017\F69.DGN ... \BDCDN-11-BORDER.DGN  
 \\BDCDN-99-4017\F70.DGN ... \BDCDN-11-BORDER.DGN  
 \\BDCDN-99-4017\F71.DGN ... \BDCDN-11-BORDER.DGN  
 \\BDCDN-99-4017\F72.DGN ... \BDCDN-11-BORDER.DGN  
 \\BDCDN-99-4017\F73.DGN ... \BDCDN-11-BORDER.DGN  
 \\BDCDN-99-4017\F74.DGN ... \BDCDN-11-BORDER.DGN  
 \\BDCDN-99-4017\F75.DGN ... \BDCDN-11-BORDER.DGN  
 \\BDCDN-99-4017\F76.DGN ... \BDCDN-11-BORDER.DGN  
 \\BDCDN-99-4017\F77.DGN ... \BDCDN-11-BORDER.DGN  
 \\BDCDN-99-4017\F78.DGN ... \BDCDN-11-BORDER.DGN  
 \\BDCDN-99-4017\F79.DGN ... \BDCDN-11-BORDER.DGN  
 \\BDCDN-99-4017\F80.DGN ... \BDCDN-11-BORDER.DGN  
 \\BDCDN-99-4017\F81.DGN ... \BDCDN-11-BORDER.DGN  
 \\BDCDN-99-4017\F82.DGN ... \BDCDN-11-BORDER.DGN  
 \\BDCDN-99-4017\F83.DGN ... \BDCDN-11-BORDER.DGN  
 \\BDCDN-99-4017\F84.DGN ... \BDCDN-11-BORDER.DGN  
 \\BDCDN-99-4017\F85.DGN ... \BDCDN-11-BORDER.DGN  
 \\BDCDN-99-4017\F86.DGN ... \BDCDN-11-BORDER.DGN  
 \\BDCDN-99-4017\F87.DGN ... \BDCDN-11-BORDER.DGN  
 \\BDCDN-99-4017\F88.DGN ... \BDCDN-11-BORDER.DGN  
 \\BDCDN-99-4017\F89.DGN ... \BDCDN-11-BORDER.DGN  
 \\BDCDN-99-4017\F90.DGN ... \BDCDN-11-BORDER.DGN  
 \\BDCDN-99-4017\F91.DGN ... \BDCDN-11-BORDER.DGN  
 \\BDCDN-99-4017\F92.DGN ... \BDCDN-11-BORDER.DGN  
 \\BDCDN-99-4017\F93.DGN ... \BDCDN-11-BORDER.DGN  
 \\BDCDN-99-4017\F94.DGN ... \BDCDN-11-BORDER.DGN  
 \\BDCDN-99-4017\F95.DGN ... \BDCDN-11-BORDER.DGN  
 \\BDCDN-99-4017\F96.DGN ... \BDCDN-11-BORDER.DGN  
 \\BDCDN-99-4017\F97.DGN ... \BDCDN-11-BORDER.DGN  
 \\BDCDN-99-4017\F98.DGN ... \BDCDN-11-BORDER.DGN  
 \\BDCDN-99-4017\F99.DGN ... \BDCDN-11-BORDER.DGN  
 \\BDCDN-99-4017\F100.DGN ... \BDCDN-11-BORDER.DGN

**TENG**  
 TENG & ASSOCIATES, INC.  
 ENGINEERS/ARCHITECTS/PLANNERS  
 CHICAGO, ILLINOIS

FILE NAME =	USER NAME = #USER#	DESIGNED - JB	REVISED -
#FILE#		DRAWN - JFS	REVISED -
		CHECKED - ACL	REVISED -
		DATE - 10/21/11	REVISED -
PLOT SCALE = #SCALE#			
PLOT DATE = #DATE#			

**STATE OF ILLINOIS**  
**DEPARTMENT OF TRANSPORTATION**  
 PROPOSED RELOCATED IL ROUTE 3 INTERCHANGE

DETAIL FOR CENTERLINE SAW CUT 16' & VARIABLE JOINTED PCC PAVEMENT FOR RAMPS			
SCALE: N.T.S.	SHEET NO. OF	SHEETS	STA. TO STA.

F.A.P. RTE.	SECTION	COUNTY	TOTAL SHEETS	SHEET NO.
998	82-2-1K	ST. CLAIR	353	227
FED. ROAD DIST. NO.			ILLINOIS FED. AID PROJECT	
			CONTRACT NO. 76E06	