

BILL OF MATERIAL

Bar	No.	Size	Length	Shape	
a(E)	50	#4	32'-1"	—	
a ₁ (E)	92	#5	33'-2"	—	
a ₂ (E)	32	#4	3'-6"	┘	
a ₃ (E)	33	#5	3'-6"	—	
a ₄ (E)	62	#5	1'-10"	┘	
b(E)	50	#4	29'-8"	—	
b ₁ (E)	149	#9	29'-9"	┘	
b ₂ (E)	6	#4	19'-2"	—	
b ₃ (E)	5	#5	31'-0"	—	
t(E)	130	#4	9'-8"	—	
w(E)	80	#5	33'-2"	—	
Concrete Structures				Cu Yd	19.8
Concrete Superstructure				Cu Yd	101.3
Bridge Deck Grooving				Sq Yd	181
Protective Coat				Sq Yd	216
Reinforcement Bars, Epoxy Coated				Pound	24,480

* Tilt #9 b₁(E) bars as required to maintain clearance.
 *** Cost included with Concrete Superstructure.

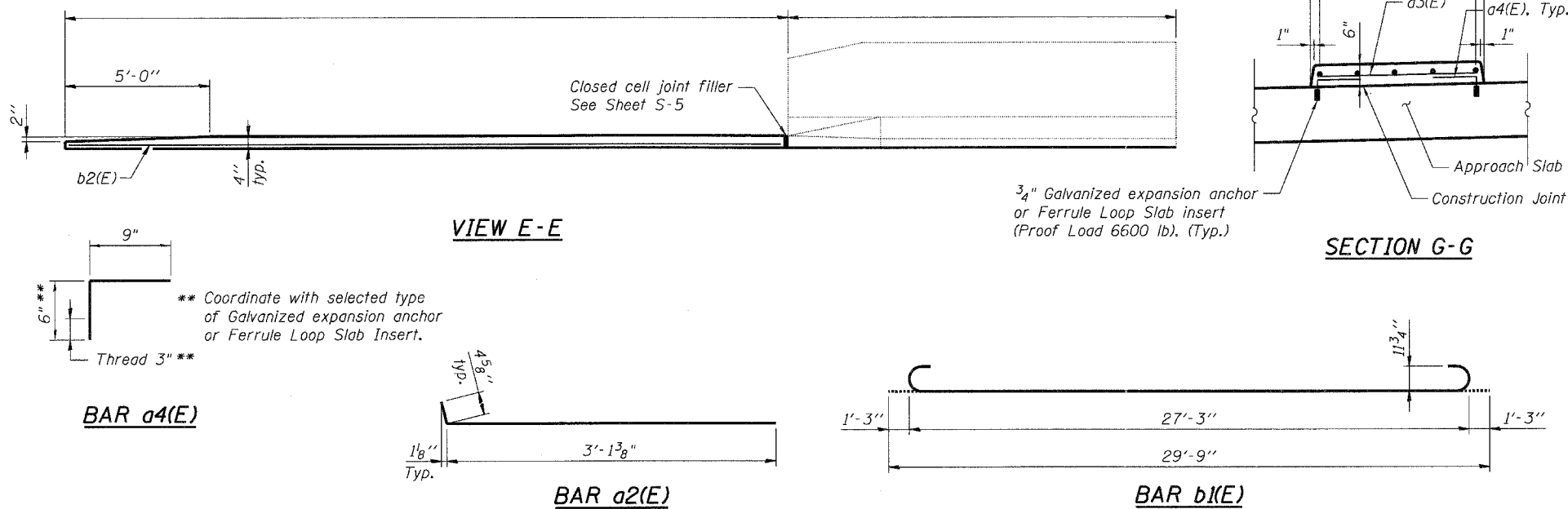

NOTES:

- See sheet S-1 for Detail A and View F-F.
- Approach slab and curb concrete shall be paid for as Concrete Superstructure.
- Approach footing concrete shall be paid for as Concrete Structures.
- Reinforcement shall be paid for as Reinforcement Bars, Epoxy Coated.
- Bar splicers (E) and v(E) bars supplied by others (contract 76D05).
- The approach footing maximum applied service bearing pressure (Q_{max}) = 2.0 ksf.
- Cost of excavation for approach footing included with Concrete Structures.
- Cost of expansion anchors/inserts included with Reinforcement Bars, Epoxy Coated.

0820328 CONN-05-001 HDJDN... 0820328 CONN-11-001 AP JDN...
 0820328 CONN-05-001 HDJDN... 0820328 CONN-11-001 AP JDN...
 0820328 CONN-05-001 HDJDN... 0820328 CONN-11-001 AP JDN...
 0820328 CONN-05-001 HDJDN... 0820328 CONN-11-001 AP JDN...

FILE NAME =	USER NAME = #USER#	DESIGNED - TCG	REVISED -	STATE OF ILLINOIS DEPARTMENT OF TRANSPORTATION IL 3 OVER I-70	BRIDGE APPROACH SLAB DETAILS		F.A.P. RTE.	SECTION	COUNTY	TOTAL SHEETS	SHEET NO.
#FILE#		DRAWN - TCG	REVISED -		998	82-2-1HB-1	ST. CLAIR	353	273		
PLOT SCALE = #SCALE#		CHECKED - JLR	REVISED -		SN 082-0328				CONTRACT NO. 76E06		
PLOT DATE = #DATE#		DATE - 10/21/11	REVISED -		SCALE:	SHEET NO. S-3 OF S-6	STA. 1683+43.17 TO STA.	FED. ROAD DIST. NO.	ILLINOIS FED. AID PROJECT		

