

FINAL SURVEY	DATE
SURVEYED	BY
PLOTTED	
NOTE BOOK	
AREAS CHECKED	
NO.	

ORIGINAL SURVEY	DATE
SURVEYED	BY
PLOTTED	
NOTE BOOK	
AREAS CHECKED	
NO.	

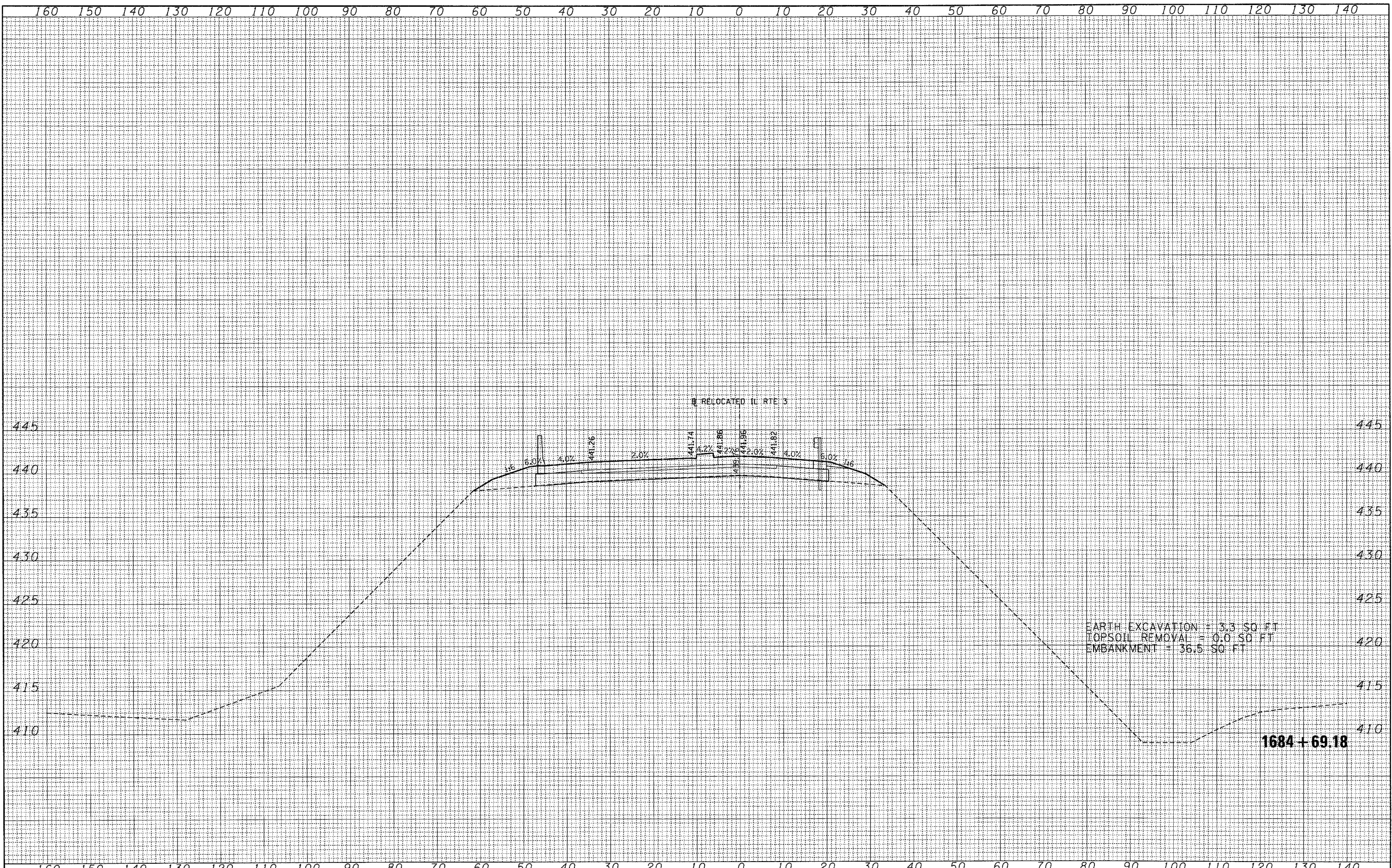

EARTH EXCAVATION = 3.3 SQ FT
 TOPSOIL REMOVAL = 0.0 SQ FT
 EMBANKMENT = 36.5 SQ FT

1684 + 69.18

FILE NAME =	USER NAME = #USER#	DESIGNED - JB	REVISED -	STATE OF ILLINOIS DEPARTMENT OF TRANSPORTATION	CROSS SECTIONS RELOCATED IL ROUTE 3			F.A. RTE.	SECTION	COUNTY	TOTAL SHEETS	SHEET NO.
#FILEL#		DRAWN - AG	REVISED -		998	82-2-1K	ST. CLAIR	353	304			
		CHECKED - ACL	REVISED -		SCALE: SHEET NO. OF SHEETS STA. 1684+69.18 TO STA. 1684+69.18			CONTRACT NO. 76E06				
		DATE - 10/21/11	REVISED -		ILLINOIS FED. AID PROJECT							