

160 150 140 130 120 110 100 90 80 70 60 50 40 30 20 10 0 10 20 30 40 50 60 70 80 90 100 110 120 130 140

FINAL SURVEY	DATE
SURVEYED	BY
PLOTTED	
NOTE BOOK	
AREAS CHECKED	
NO.	

ORIGINAL SURVEY	DATE
SURVEYED	BY
PLOTTED	
NOTE BOOK	
AREAS CHECKED	
NO.	

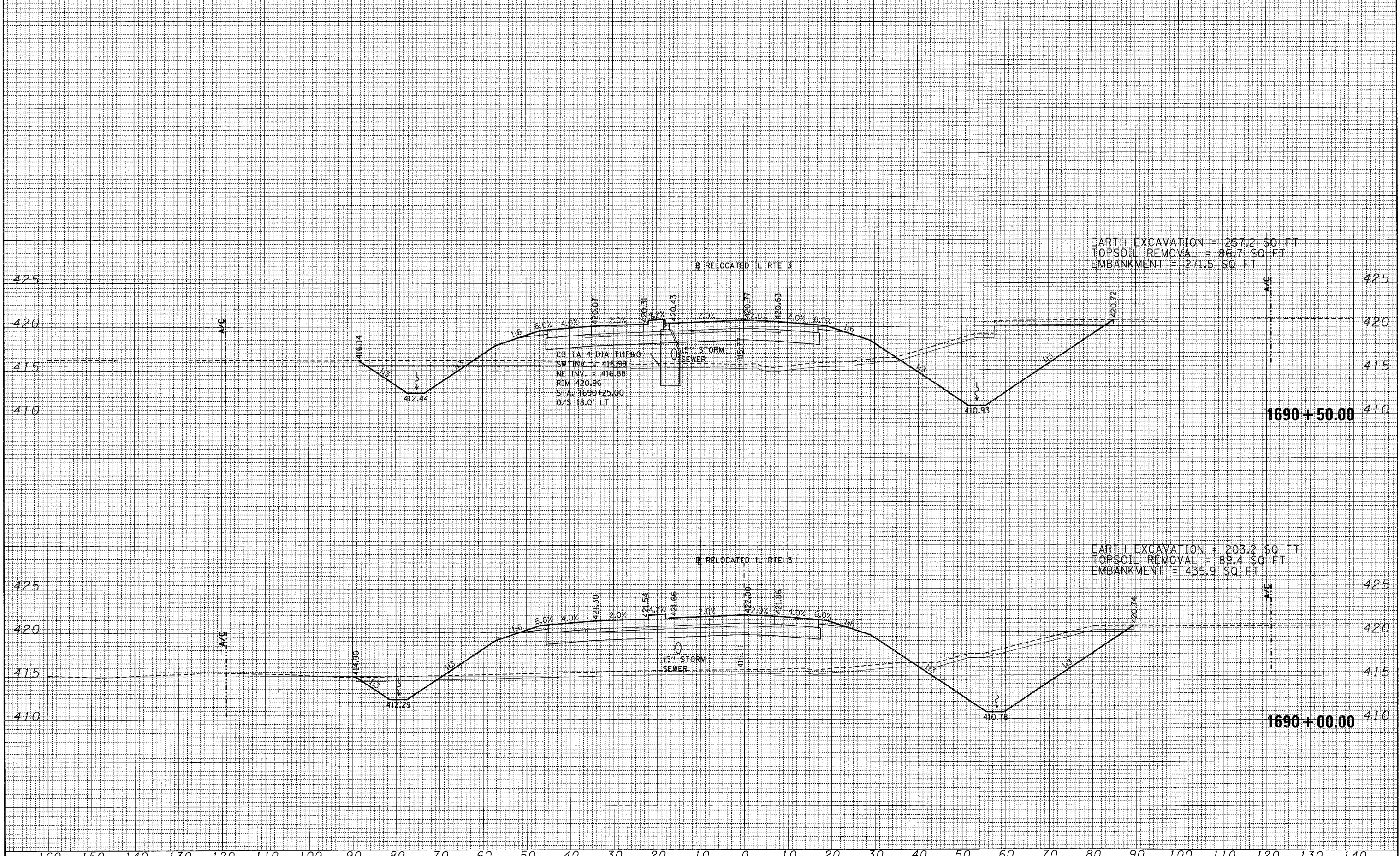

EARTH EXCAVATION = 257.2 SQ FT
 TOPSOIL REMOVAL = 86.7 SQ FT
 EMBANKMENT = 271.5 SQ FT

EARTH EXCAVATION = 203.2 SQ FT
 TOPSOIL REMOVAL = 89.4 SQ FT
 EMBANKMENT = 435.9 SQ FT

FILE NAME =	USER NAME = #USER#	DESIGNED - JB	REVISED -	STATE OF ILLINOIS DEPARTMENT OF TRANSPORTATION	CROSS SECTIONS RELOCATED IL ROUTE 3			F.A. RTE.	SECTION	COUNTY	TOTAL SHEETS	SHEET NO.
#FILE#	PLOT SCALE = #SCALE#	DRAWN - AG	REVISED -		998	82-2-1K	ST. CLAIR	353	311			
	PLOT DATE = #DATE#	CHECKED - ACL	REVISED -		SCALE: SHEET NO. OF SHEETS STA. 1690+00.00 TO STA. 1690+50.00			CONTRACT NO. 76E06				
		DATE - 10/21/11	REVISED -		ILLINOIS FED. AID PROJECT							