

PROJECT NO.	SECTION	SHEET NO.
FAZ-70	82-10M	35
COUNTY: ST. CLAIR		
DATE: 11-23-11		

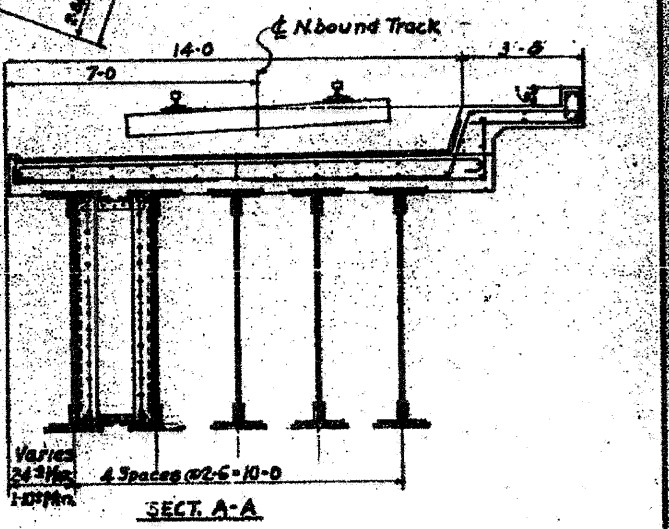
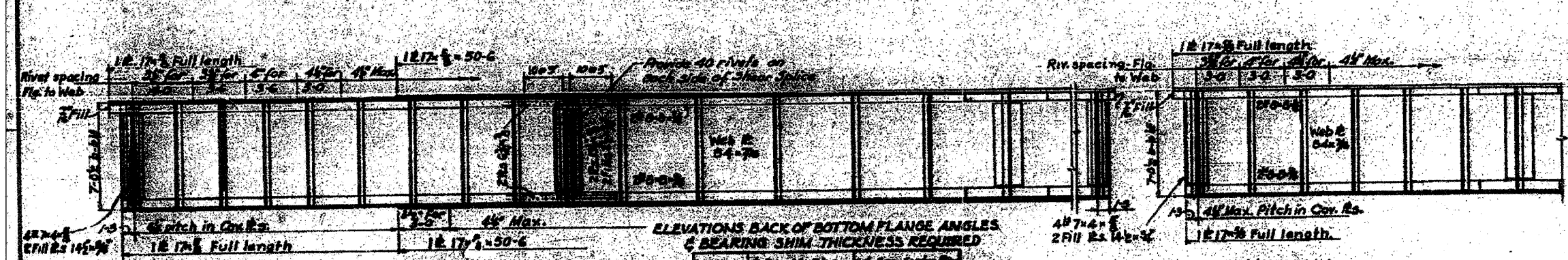
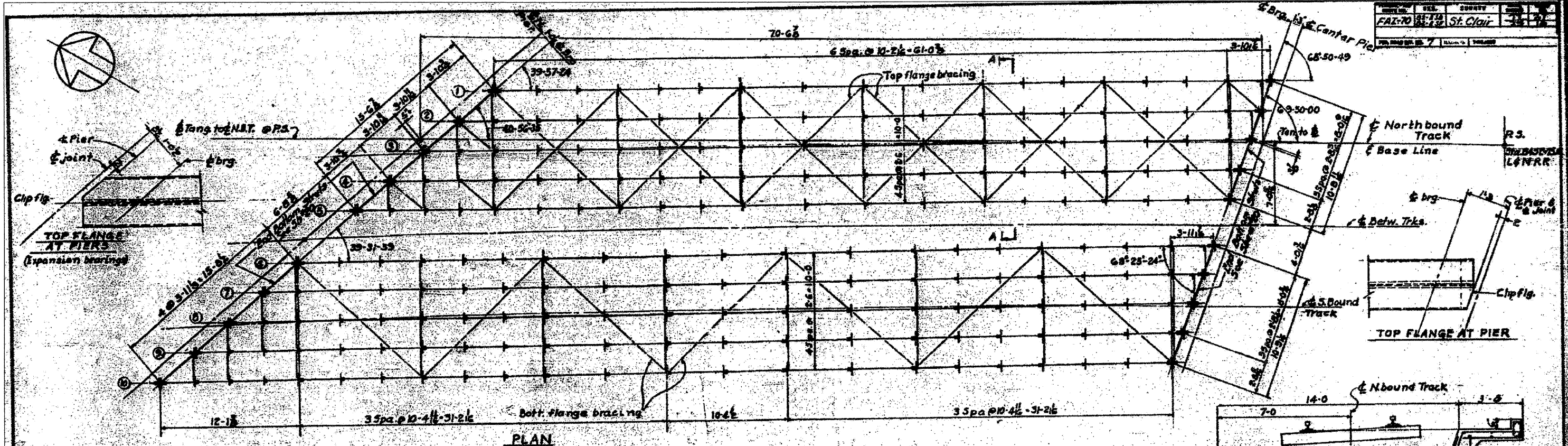

Order	Elav	Shim	Elav	Shim
1	406.08	1/4"	407.07	3/8"
2	406.08	1/4"	407.07	3/8"
3	406.07	1/4"	407.05	3/8"
4	406.06	1/4"	407.05	1/2"
5	406.05	1/4"	407.05	1/2"
6	406.11	3/8"	407.20	3/8"
7	406.12	1"	407.09	3/4"
8	406.13	1/4"	407.08	3/8"
9	406.14	1/4"	407.08	3/8"
10	406.15	1/4"	407.20	3/8"

Span lengths (C-C bearings)	Elav	Shim
1	66-10 1/2"	7/8"
2	66-11"	7/8"
3	68-11 1/2"	1"
4	70-11"	1"
5	72-11 1/2"	1"
6	76-8"	1 1/4"
7	78-8 1/2"	1 1/4"
8	80-9"	1 1/4"
9	82-9 1/2"	1 1/4"
10	84-10"	1 1/4"

Girder No.	No. 8	No. 9	No. 10	No. 11	No. 12	
D.L.	95.8	67.6	62.5	58.3	54.5	67.5
L.L.	94.6	90.9	66.7	63.2	79.1	75.2
Imp	61.8	60.4	59.1	57.8	54.9	53.7
C.F.	0.0	0.0	32.5	0.0	0.0	33.0
Total	251.8	218.9	247.6	193.1	182.5	229.4

Category	Value
Ballast, Ties & Rail	2.73
Slab, Waterproof & Walk	3.00
Total	5.73
D.L. Girder	1.25
D.L. Sp. Girder	1.50
D.L. Steel	35
Total	2.82

Girders	Gross	Net
Girders C-10	4.60"	4.60"
Girders I-5	28.28"	28.28"
Total	32.88"	32.88"

Girder No.	No. 8	No. 9	No. 10	No. 11	No. 12	
D.L.	2003.0	1587.0	1806.0	1079.0	940.0	1103.0
L.L.	1752.0	1608.0	1454.0	1337.0	1211.0	1099.0
Imp.	1148.0	1022.0	956.0	926.0	834.0	799.0
C.F.	0.0	0.0	550.0	0.0	0.0	406.0
Total	4903.0	4217.0	4716.0	3346.0	2975.0	3507.0

ADDITIONAL MATERIAL

- Web 84x7x36 36.75'
- End stiff 4x7x4 1/2'
- Use 16 Rivets per pair
- 2 End Fills 14x14 (see elev)
- Inter. Stiff 2x6x3 1/2 on fills at Diaphragms, 2x6x3 1/2 on fills at all other
- End Diaphragm Stiff 2x6x4 1/2 on 3x7x1/2

Category	Gross	Net
Gross I-5	133.00	133.00
Net I-5	126.00	126.00
Total	133.00	126.00

Notes:

- For details of diaphragms, lateral bracing & connections, see Sh. 20.
- For details of bearings see Sh. 21.
- For Notes see Sh. 1.

Max. distance c.c. rivets on outside gage line of cover plates shall be 3d.
In bottom cover plate near & span on account of net section Min. pitch 3d.

STATE OF ILLINOIS
DEPARTMENT OF PUBLIC WORKS & BLDGS.
DIVISION OF HIGHWAYS
&
CITY OF EAST ST. LOUIS
EAST ST. LOUIS EXPRESSWAY
L. & N. R.R. OVER WEST BOUND EXPWAY,
RAMP "L", EAST BOUND EXPWAY AND RAMP "M"

H.W. LOCHNER, INC.
ENGINEERS
CHICAGO, ILLINOIS