

W1-4cR
STA. 1511+50

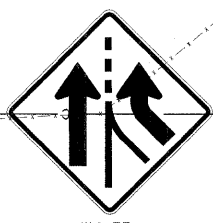

W4-3R
STA. 1519+50

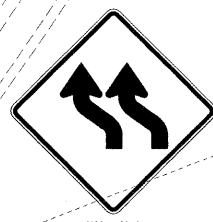

W1-4bL
STA. 1525+00

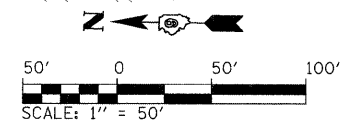
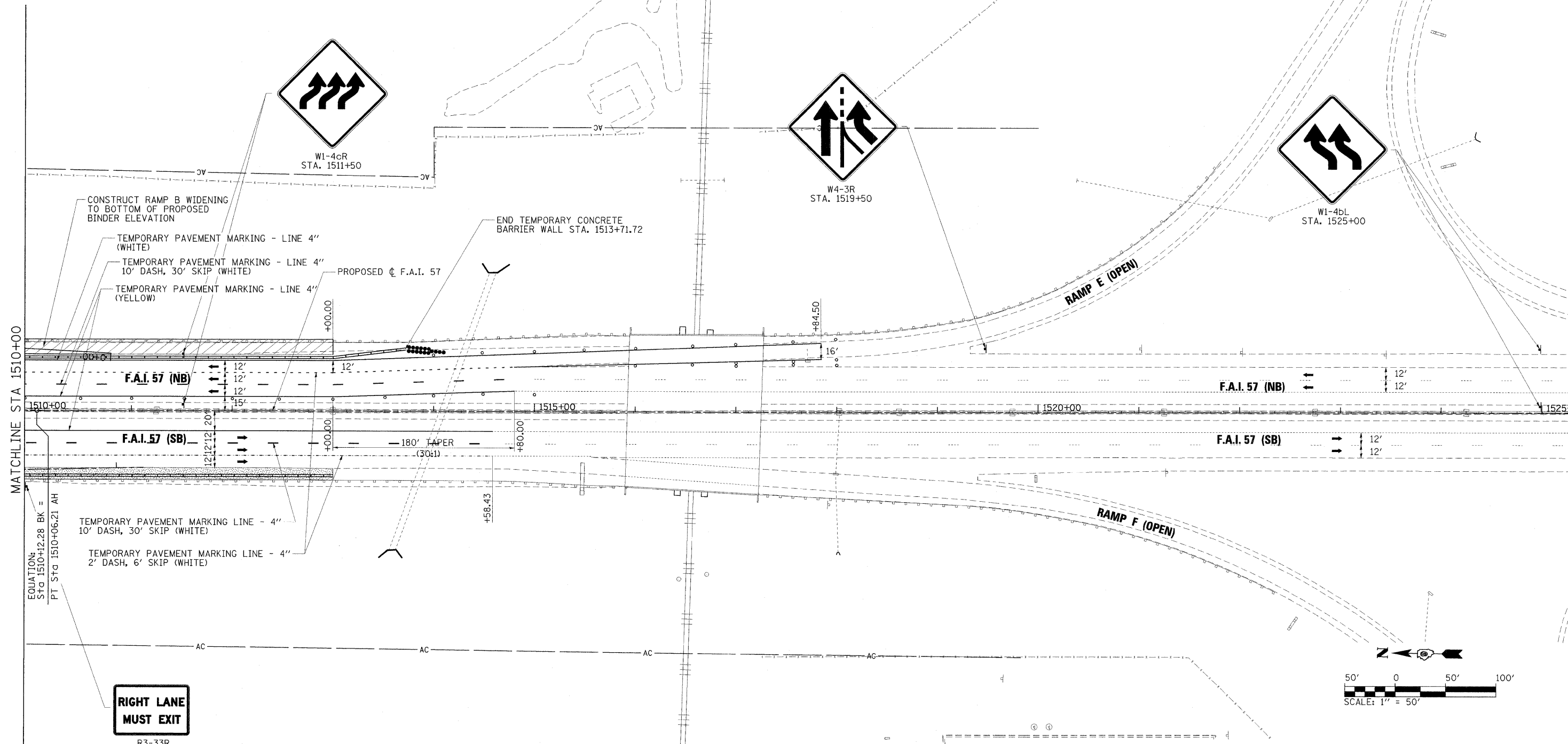

LEGEND

- WORK ZONE
- COMPLETED PAVEMENT
- TEMPORARY PAVEMENT - FULL DEPTH (CONSTRUCTED THIS STAGE)
- TEMPORARY PAVEMENT - FULL DEPTH (CONSTRUCTED PREVIOUS STAGE)
- TEMPORARY RAMP
- MILL/OVERLAY
- TEMPORARY CONCRETE BARRIER WALL
- IMPACT ATTENUATORS, TEMPORARY (FULLY REDIRECTIVE, NARROW)
- IMPACT ATTENUATORS, TEMPORARY (NON-REDIRECTIVE)
- DRUM WITH STEADY BURNING LIGHT
- TYPE II BARRICADE WITH STEADY BURNING LIGHT
- TYPE III BARRICADE WITH FLASHING LIGHTS
- DIRECTION OF TRAFFIC FLOW

FILE NAME = ...\\D978182-sht-stagingPreB-157_007.dgn	USER NAME = Brad Downen	DESIGNED - RMM/EMM	REVISED -
		DRAWN - RJE	REVISED -
	PLOT SCALE = 50.0000' / IN.	CHECKED - BJD	REVISED -
	PLOT DATE = 10/12/2011	DATE - 10/07/11	REVISED -

**STATE OF ILLINOIS
DEPARTMENT OF TRANSPORTATION**

**MAINTENANCE OF TRAFFIC PLAN - F.A.I. 57
PRE-STAGE B**

SCALE: 1" = 50' SHEET NO. OF SHEETS STA. 1510+00 TO STA.

F.A. RTE.	SECTION	COUNTY	TOTAL SHEETS	SHEET NO.
*	(X1-6-2)HBK-2, HB-1,2; (X1-1R-1	WILLIAMSON	968	167
* F.A.I. 57 AND F.A.P. 331		CONTRACT NO. 78182		

ILLINOIS FED. AID PROJECT