

PROPOSED ϕ F.A.I. 57 SOUTH CROSSOVER
 PROP. CURVE TMPXOS-1
 PI STA. = 2+56.24
 $\Delta = 9^\circ 41' 30''$ (LT)
 $D = 2^\circ 51' 53''$
 $R = 2,000.00'$
 $T = 169.56'$
 $L = 338.31'$
 $E = 7.17'$
 P.C. STA. = 0+86.68
 P.R.C. STA. = 4+24.98

PROP. CURVE TMPXOS-2
 PI STA. = 5+42.71
 $\Delta = 6^\circ 44' 16''$ (RT)
 $D = 2^\circ 51' 53''$
 $R = 2,000.00'$
 $T = 117.73'$
 $L = 235.19'$
 $E = 3.46'$
 P.R.C. STA. = 4+24.98
 P.T. STA. = 6+60.17

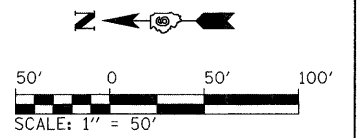

PLAN	SURVEYED	DATE
	PLOTTED	
	CHECKED	
	BY	
	NO.	
	FILE NAME	

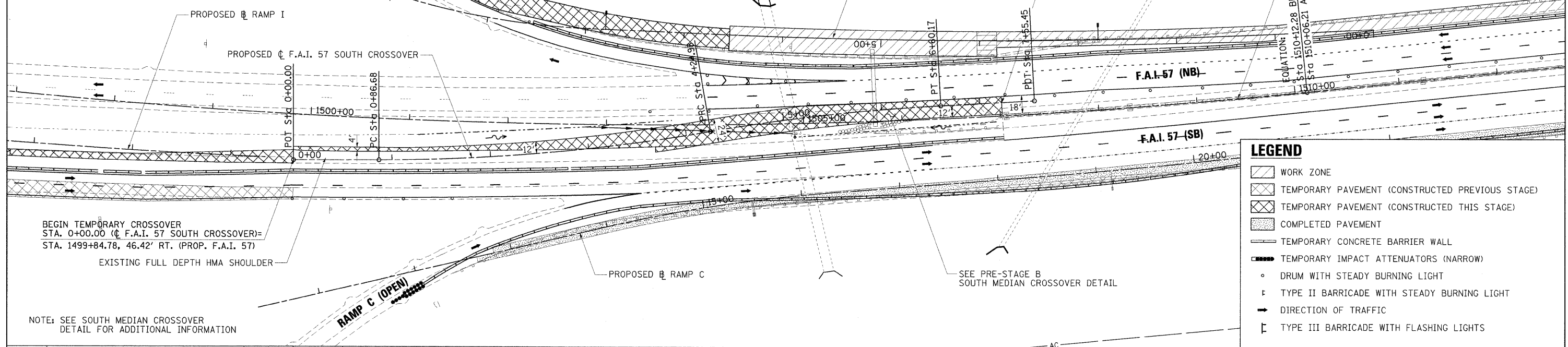

LEGEND

- WORK ZONE
- TEMPORARY PAVEMENT (CONSTRUCTED PREVIOUS STAGE)
- TEMPORARY PAVEMENT (CONSTRUCTED THIS STAGE)
- COMPLETED PAVEMENT
- TEMPORARY CONCRETE BARRIER WALL
- TEMPORARY IMPACT ATTENUATORS (NARROW)
- DRUM WITH STEADY BURNING LIGHT
- TYPE II BARRICADE WITH STEADY BURNING LIGHT
- DIRECTION OF TRAFFIC
- TYPE III BARRICADE WITH FLASHING LIGHTS

NOTE: SEE SOUTH MEDIAN CROSSOVER DETAIL FOR ADDITIONAL INFORMATION

TEMP. CROSSOVER COORDINATE DATA

475	P.O.T. STA. 0+00.00 N=390727.689 E=803373.773
470	P.C. STA. 0+86.68 N=390641.325 E=803366.397
465	P.R.C. STA. 4+24.98 N=390303.423 E=803366.185
460	P.T. STA. 6+60.17 N=390068.444 E=803372.096
455	P.O.T. STA. 7+55.45 N=389973.223 E=803368.891

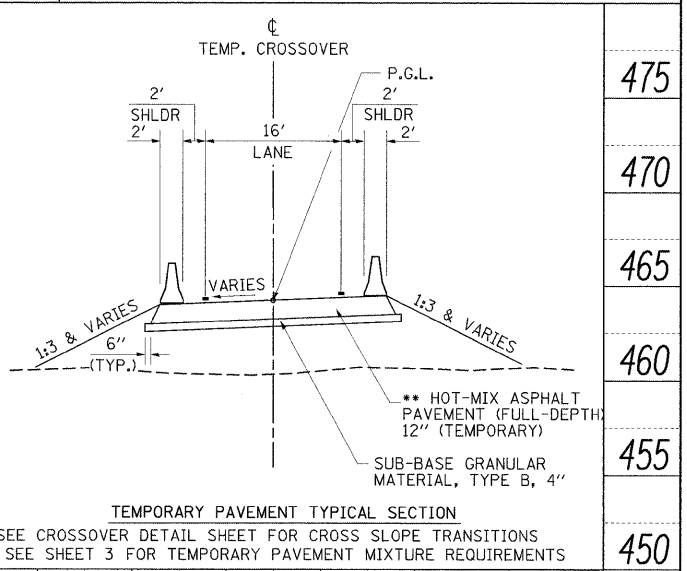
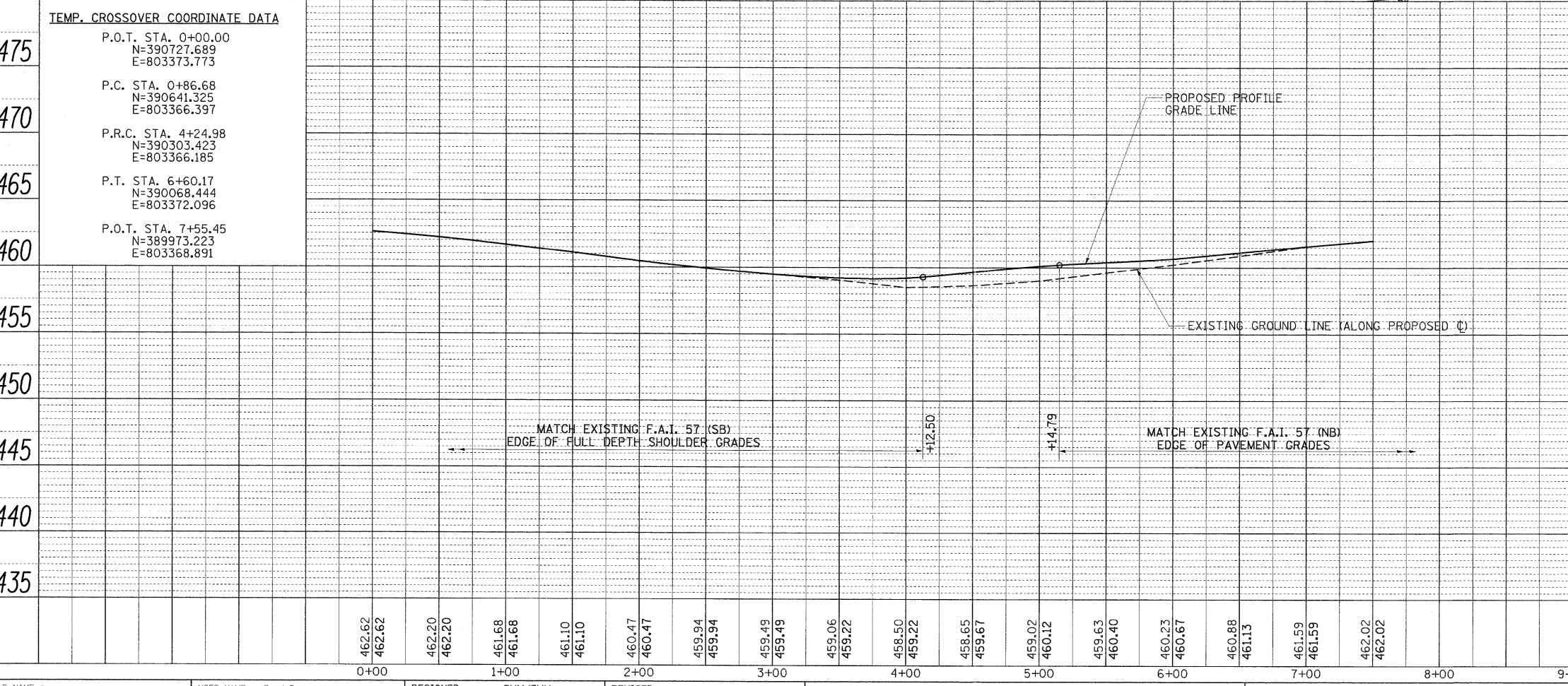

FILE NAME = ...10978:82-shr-StagingPreB-157XOVER2.PNP.dgn	USER NAME = Brad Downen	DESIGNED - RMM/EMM	REVISED -	STATE OF ILLINOIS DEPARTMENT OF TRANSPORTATION	PLAN AND PROFILE- F.A.I. 57 SOUTH MEDIAN CROSSOVER PRE-STAGE B	F.A. RTE.	SECTION	COUNTY	TOTAL SHEETS	SHEET NO.
PLOT SCALE = 50,0000' / IN.	DRAWN - RJE	CHECKED - BJD	REVISED -			• (X1-6-2)HBK-2, HB-1,2; (IX-1R-1	WILLIAMSON	968	169	
PLOT DATE = 10/12/2011	DATE - 10/07/11	REVISED -	REVISED -			• F.A.I. 57 AND F.A.P. 331	CONTRACT NO. 78182	ILLINOIS FED. AID PROJECT		
SCALE: 1" = 50'		SHEET NO. OF SHEETS STA. TO STA.								