

NOTES:

1. STATION OF IMPROVEMENTS ARE BASED ON THE BASELINE OF IL 13.
2. TEMPORARY SIGNALS TO BE INSTALLED AT THE BEGINNING OF PRE-STAGE B. CONSTRUCTION AND REMOVED AT THE END OF STAGE 3 CONSTRUCTION.
3. TEMPORARY LIGHTING LUMINAIRES SHALL BE FED FROM A CIRCUIT BREAKER IN THE TRAFFIC SIGNAL CONTROLLER.
4. ADD GUYS AND ANCHORS AS NEEDED TO SUPPORT THE POLE AGAINST CABLE LOADS. THE COST SHALL BE INCLUDED IN THE COST OF TEMPORARY TRAFFIC SIGNAL INSTALLATION.
5. ATTACH AERIAL CABLE FOR LIGHTING AT THE TOP OF THE POLE.
6. INSTALL A STEEL U-GUARD AT THE BOTTOM OF THE WOOD POLE TO PROTECT THE UNIT DUCT FROM PHYSICAL DAMAGE.

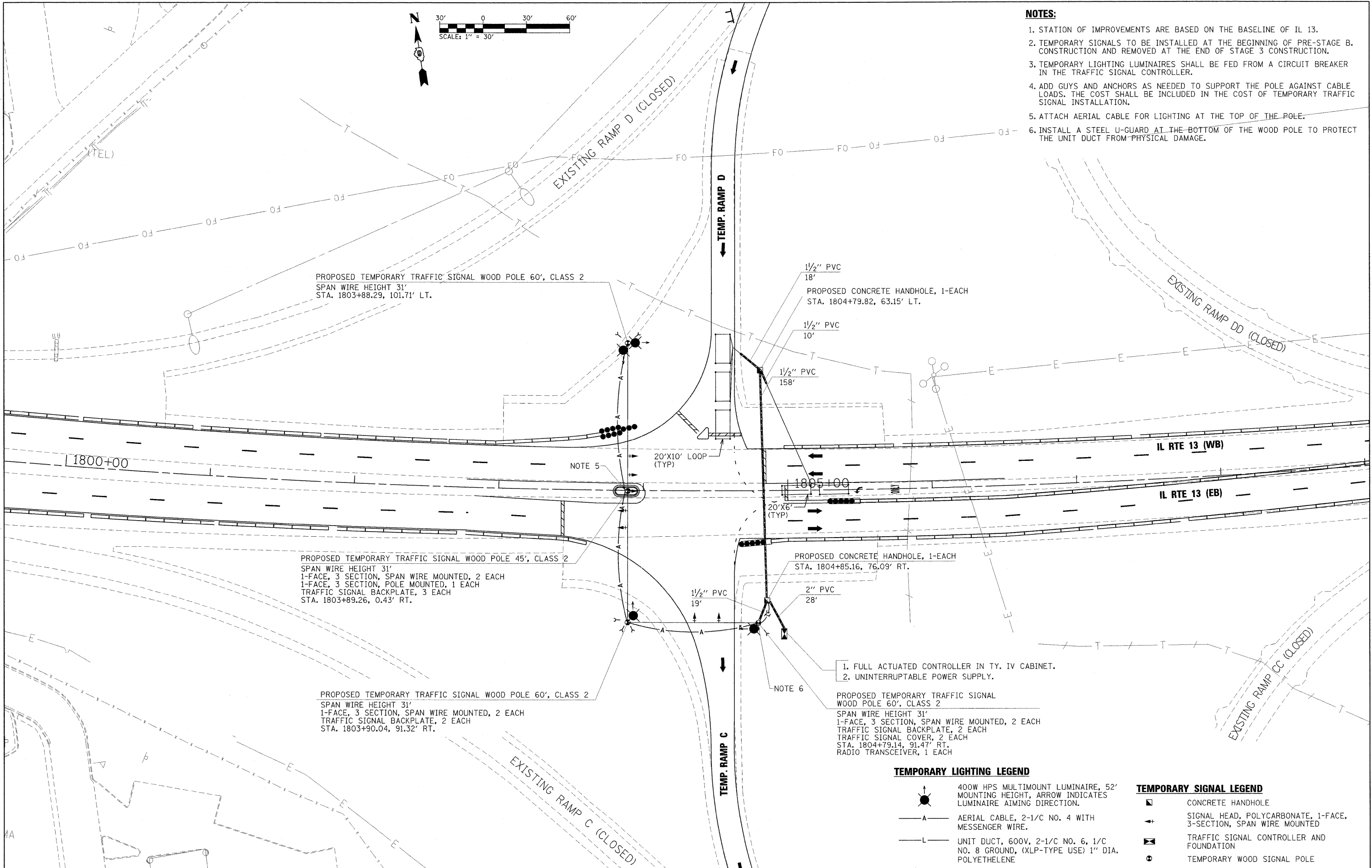

PROPOSED TEMPORARY TRAFFIC SIGNAL WOOD POLE 60', CLASS 2
SPAN WIRE HEIGHT 31'
STA. 1803+88.29, 101.71' LT.

1/2" PVC 18'
PROPOSED CONCRETE HANDHOLE, 1-EACH
STA. 1804+79.82, 63.15' LT.

1/2" PVC 10'

1/2" PVC 158'

PROPOSED TEMPORARY TRAFFIC SIGNAL WOOD POLE 45', CLASS 2
SPAN WIRE HEIGHT 31'
1-FACE, 3 SECTION, SPAN WIRE MOUNTED, 2 EACH
1-FACE, 3 SECTION, POLE MOUNTED, 1 EACH
TRAFFIC SIGNAL BACKPLATE, 3 EACH
STA. 1803+89.26, 0.43' RT.

PROPOSED CONCRETE HANDHOLE, 1-EACH
STA. 1804+85.16, 76.09' RT.

1/2" PVC 19'

2" PVC 28'

PROPOSED TEMPORARY TRAFFIC SIGNAL WOOD POLE 60', CLASS 2
SPAN WIRE HEIGHT 31'
1-FACE, 3 SECTION, SPAN WIRE MOUNTED, 2 EACH
TRAFFIC SIGNAL BACKPLATE, 2 EACH
STA. 1803+90.04, 91.32' RT.

- NOTE 6
1. FULL ACTUATED CONTROLLER IN TY. IV CABINET.
 2. UNINTERRUPTABLE POWER SUPPLY.

PROPOSED TEMPORARY TRAFFIC SIGNAL WOOD POLE 60', CLASS 2
SPAN WIRE HEIGHT 31'
1-FACE, 3 SECTION, SPAN WIRE MOUNTED, 2 EACH
TRAFFIC SIGNAL BACKPLATE, 2 EACH
TRAFFIC SIGNAL COVER, 2 EACH
STA. 1804+79.14, 91.47' RT.
RADIO TRANSCEIVER, 1 EACH

TEMPORARY LIGHTING LEGEND

- 400W HPS MULTIMOUNT LUMINAIRE, 52' MOUNTING HEIGHT, ARROW INDICATES LUMINAIRE AIMING DIRECTION.
- AERIAL CABLE, 2-1/2" NO. 4 WITH MESSENGER WIRE.
- UNIT DUCT, 600V, 2-1/2" NO. 6, 1/2" NO. 8 GROUND, (XLP-TYPE USE) 1" DIA. POLYETHYLENE

TEMPORARY SIGNAL LEGEND

- CONCRETE HANDHOLE
- SIGNAL HEAD, POLYCARBONATE, 1-FACE, 3-SECTION, SPAN WIRE MOUNTED
- TRAFFIC SIGNAL CONTROLLER AND FOUNDATION
- TEMPORARY WOOD SIGNAL POLE

FILE NAME = ...D978182-snt-temp.sig004.dgn	USER NAME = Brod Downen	DESIGNED - BSE	REVISED -
		DRAWN - GLD	REVISED -
		CHECKED - SPH	REVISED -
		DATE - 10/7/2011	REVISED -

**STATE OF ILLINOIS
DEPARTMENT OF TRANSPORTATION**

**TEMPORARY SIGNAL & LIGHTING PLAN - PRE-STAGE B
TEMPORARY RAMP C & D**

SCALE: 1" = 30' | SHEET NO. OF SHEETS | STA. TO STA.

F.A. RTE.	SECTION	COUNTY	TOTAL SHEETS	SHEET NO.
*	0X1-6-2H8K-2, HB-1,2; 0X-1R-1	WILLIAMSON	968	185
*	F.A.I. 57 AND F.A.P. 331			CONTRACT NO. 78182
ILLINOIS FED. AID PROJECT				