

SCHEDULE OF SIGNAL QUANTITIES

- 197 FOOT UNDERGROUND CONDUIT, 1 1/2" DIA., PVC
- 28 FOOT UNDERGROUND CONDUIT, 2" DIA., PVC
- 2 EACH CONCRETE HANDHOLE
- 1 EACH FULL-ACTUATED CONTROLLER AND TYPE IV CABINET
- 436 FOOT ELECTRICAL CABLE, SIGNAL NO. 14 2C
- 1053 FOOT ELECTRICAL CABLE, SIGNAL NO. 14 5C
- 400 FOOT ELECTRICAL CABLE, SERVICE NO. 6 2C
- 6 EACH SIGNAL HEAD, 1 FACE, 3-SECTION, SPAN WIRE MOUNTED
- 1 EACH SIGNAL HEAD, 1 FACE, 3-SECTION, BRACKET MOUNTED
- 7 EACH TRAFFIC SIGNAL BACKPLATE
- 2 EACH INDUCTION LOOP DETECTOR AMPLIFIER WITH SYSTEM OUTPUT
- 519 FOOT DETECTOR LOOP, TYPE 1
- 1 EACH UNINTERRUPTABLE POWER SUPPLY
- 3 EACH TEMPORARY TRAFFIC SIGNAL WOOD POLE 60', CLASS 2
- 1 EACH ELECTRIC SERVICE INSTALLATION
- 1 EACH TEMPORARY TRAFFIC SIGNAL WOOD POLE 45', CLASS 2
- 1 EACH SPAN WIRE ACCESSORIES
- 1 EACH RADIO TRANSCEIVER

NOTE: ALL QUANTITIES ARE APPROXIMATE AND FOR INFORMATION ONLY. THE CONTRACTOR SHALL BE REQUIRED TO CONSTRUCT THE TEMPORARY TRAFFIC SIGNALS AS DETAILED ON THE PLANS IN ORDER TO PROVIDE A COMPLETE AND OPERATIONAL SYSTEM. ALL WORK AND MATERIAL NECESSARY SHALL BE INCLUDED IN THE CONTRACT PRICE PER EACH FOR TEMPORARY TRAFFIC SIGNAL INSTALLATION.

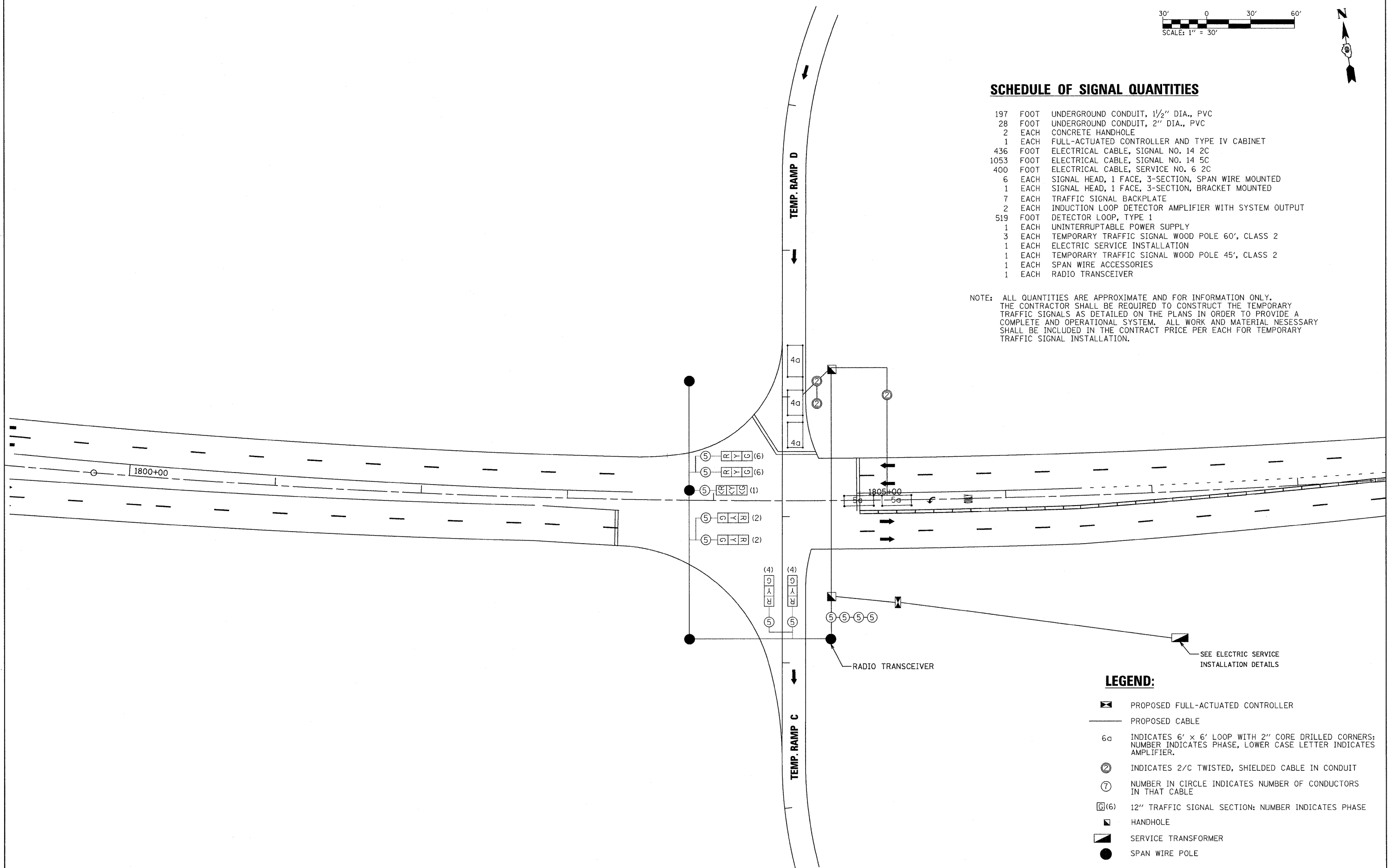

LEGEND:

- PROPOSED FULL-ACTUATED CONTROLLER
- PROPOSED CABLE
- 6a INDICATES 6' x 6' LOOP WITH 2" CORE DRILLED CORNERS; NUMBER INDICATES PHASE, LOWER CASE LETTER INDICATES AMPLIFIER.
- INDICATES 2/C TWISTED, SHIELDED CABLE IN CONDUIT
- NUMBER IN CIRCLE INDICATES NUMBER OF CONDUCTORS IN THAT CABLE
- 12" TRAFFIC SIGNAL SECTION: NUMBER INDICATES PHASE
- HANDHOLE
- SERVICE TRANSFORMER
- SPAN WIRE POLE

FILE NAME = ...D978182-shr-temp.sig085.dgn	USER NAME = Brad Downen	DESIGNED - BSE	REVISED -	STATE OF ILLINOIS DEPARTMENT OF TRANSPORTATION	TEMPORARY SIGNAL CABLE PLAN-PRE-STAGE B TEMPORARY RAMP C & D	F.A. RTE.	SECTION	COUNTY	TOTAL SHEETS	SHEET NO.	
		DRAWN - BSE	REVISED -		SCALE: N.T.S.	SHEET NO. OF SHEETS	STA.	TO STA.	WILLIAMSON	968	186
		CHECKED - SPH	REVISED -						CONTRACT NO. 78182		
		DATE - 10/07/11	REVISED -					ILLINOIS FED. AID PROJECT			