

WESTBOUND EASTBOUND  
 IL 13 - STAGE 1A TYPICAL #6  
 STA. 1823+77.60 TO STA. 832+40.00

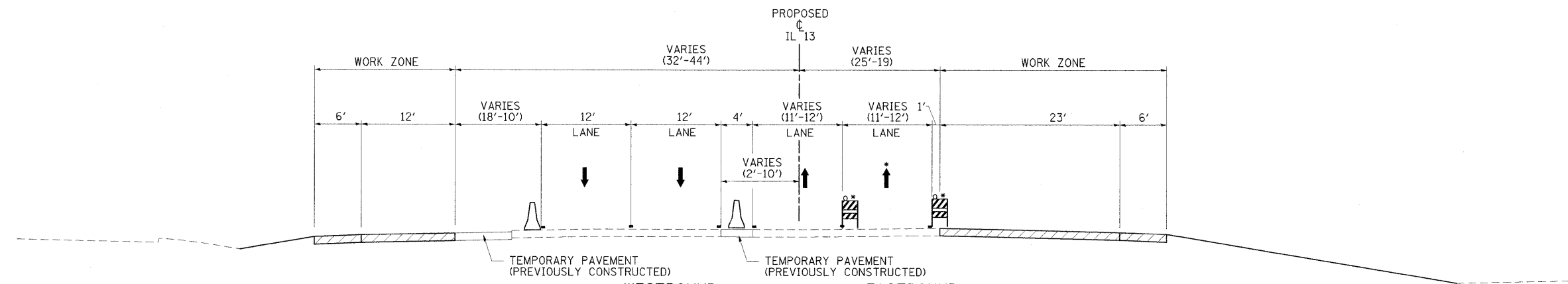

WESTBOUND EASTBOUND  
 IL 13 - STAGE 1A TYPICAL #7  
 STA. 832+40.00 TO STA. 836+64.57

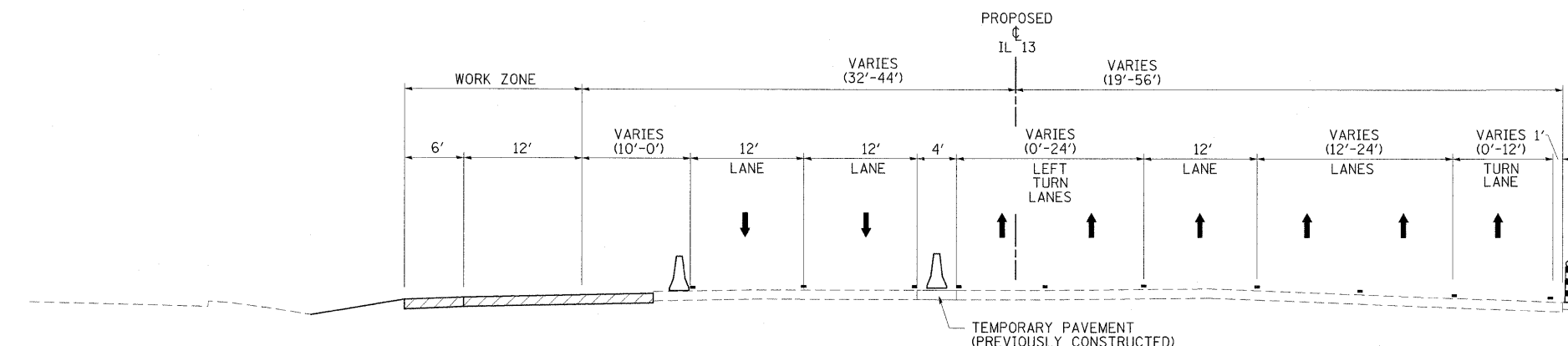

WESTBOUND EASTBOUND  
 IL 13 - STAGE 1A TYPICAL #8  
 STA. 836+64.57 TO STA. 840+15.84

- NOTES:**
- THE CONTRACTOR SHALL ADHERE TO DROP-OFF PROTECTION REQUIREMENTS SHOWN ON SHEET 136 AT ALL TIMES.
- DURING PEAK PERIODS:**
- CHANNELIZING DEVICES SHALL BE PLACED OUTSIDE OF THE EXISTING EDGE OF PAVEMENT ON THE EXISTING SHOULDER OR ON COMPLETED TEMPORARY PAVEMENT.
  - TWO LANES OF TRAFFIC SHALL BE MAINTAINED IN EACH DIRECTION.
- DURING OFF-PEAK WORK PERIODS:**
- CHANNELIZING DEVICES SHALL BE PLACED IN ACCORDANCE WITH IDOT STANDARD 701601-07 TO CLOSE THE LANE ADJACENT TO THE WORK ZONE.
  - THE CONTRACTOR SHALL COMPLETE WORK ADJACENT TO THE LANE CLOSURE.
  - THE CONTRACTOR SHALL NOT BE PERMITTED TO PERFORM MEDIAN AND SHOULDER WORK CONCURRENTLY.

**LEGEND**

- TEMPORARY BARRIER WALL
- DIRECTION OF TRAFFIC
- WORK ZONE
- TEMPORARY PAVEMENT (CONSTRUCTED IN THIS STAGE)
- DRUM WITH STEADY BURNING LIGHT
- TYPE II BARRICADE WITH STEADY BURNING LIGHT
- VERTICAL PANEL, POST MOUNTED

FILE NAME = ...D978182-sht-staging\A-IL13.TYP_083.dgn	USER NAME = Brad Downen	DESIGNED - JMS	REVISED -	<b>STATE OF ILLINOIS DEPARTMENT OF TRANSPORTATION</b>	<b>MAINTENANCE OF TRAFFIC TYPICAL SECTIONS - IL 13 STAGE 1A</b>				F.A. RTE.	SECTION	COUNTY	TOTAL SHEETS	SHEET NO.
		DRAWN - JMS	REVISED -		SCALE:	SHEET NO.	OF	SHEETS	STA.	TO STA.	WILLIAMSON	968	211
		CHECKED - BJD	REVISED -								* F.A.I. 57 AND F.A.P. 331		CONTRACT NO. 78182
		DATE - 10/07/11	REVISED -								ILLINOIS FED. AID PROJECT		