

MATCHLINE STA 1525+00

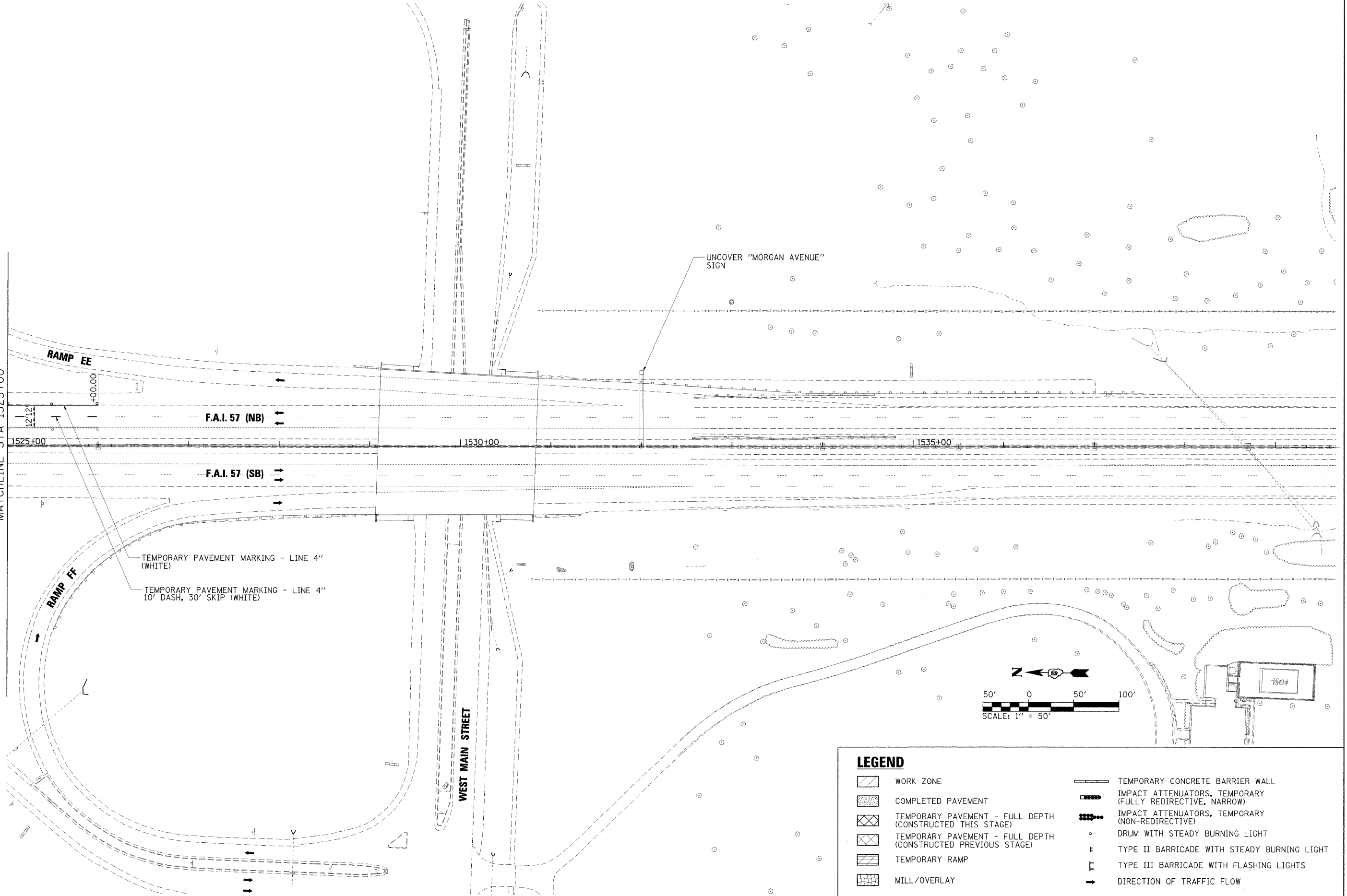

TEMPORARY PAVEMENT MARKING - LINE 4" (WHITE)  
 TEMPORARY PAVEMENT MARKING - LINE 4" 10' DASH, 30' SKIP (WHITE)

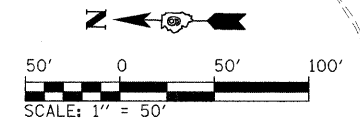

LEGEND	
	WORK ZONE
	COMPLETED PAVEMENT
	TEMPORARY PAVEMENT - FULL DEPTH (CONSTRUCTED THIS STAGE)
	TEMPORARY PAVEMENT - FULL DEPTH (CONSTRUCTED PREVIOUS STAGE)
	TEMPORARY RAMP
	MILL/OVERLAY
	TEMPORARY CONCRETE BARRIER WALL
	IMPACT ATTENUATORS, TEMPORARY (FULLY REDIRECTIVE, NARROW)
	IMPACT ATTENUATORS, TEMPORARY (NON-REDIRECTIVE)
	DRUM WITH STEADY BURNING LIGHT
	TYPE II BARRICADE WITH STEADY BURNING LIGHT
	TYPE III BARRICADE WITH FLASHING LIGHTS
	DIRECTION OF TRAFFIC FLOW

FILE NAME = ...D978182-shr-staging2-157.008.dgn	USER NAME = Brad Downen	DESIGNED - RMM/EMM	REVISED -
		DRAWN - RJE	REVISED -
		CHECKED - BJD	REVISED -
		DATE - 10/07/11	REVISED -

**STATE OF ILLINOIS  
 DEPARTMENT OF TRANSPORTATION**

**MAINTENANCE OF TRAFFIC PLAN - F.A.I. 57  
 STAGE 2**

SCALE: 1" = 50' SHEET NO. OF SHEETS STA. 1525+00 TO STA. 1539+00

F.A. RTE.	SECTION	COUNTY	TOTAL SHEETS	SHEET NO.
*	(X1-6-2)HBK-2, HB-1,2; (IX-1R-1	WILLIAMSON	968	240
* F.A.I. 57 AND F.A.P. 331			CONTRACT NO. 78182	
ILLINOIS FED. AID PROJECT				