

PLAN	SURVEYED	BY	DATE
	PLOTTED		
	NOTE BOOK		
	NO.		
	PAID FILE NAME		

PROFILE	SURVEYED	BY	DATE
	PLOTTED		
	NOTE BOOK		
	NO.		
	STRUCTURE NOTATIONS		

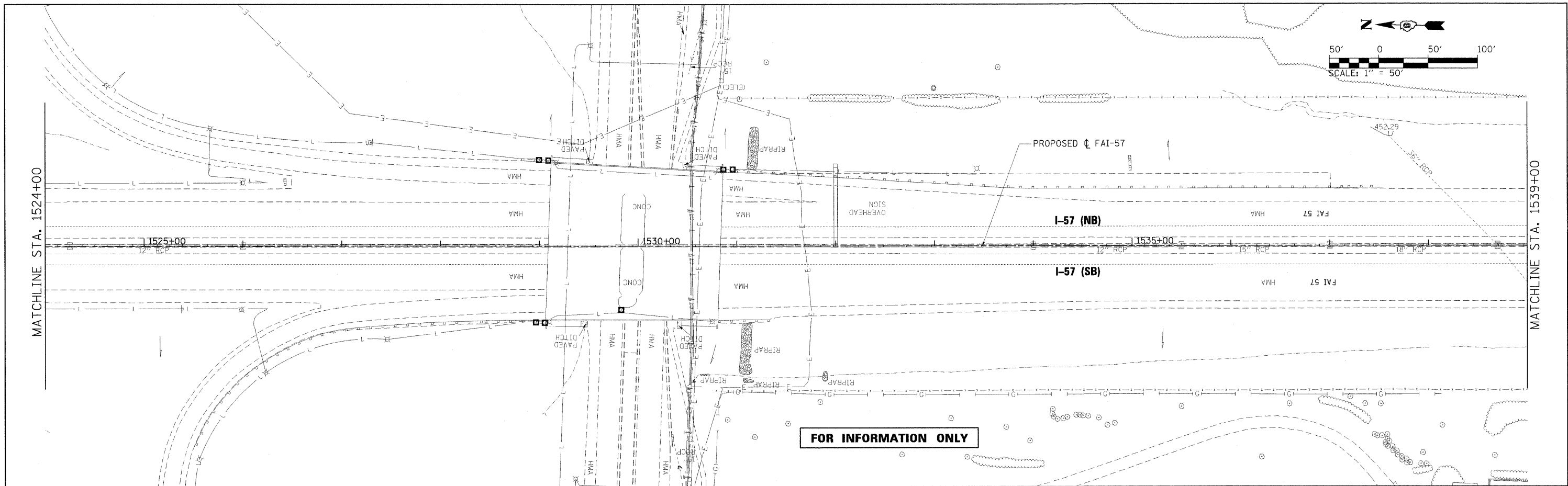

FOR INFORMATION ONLY

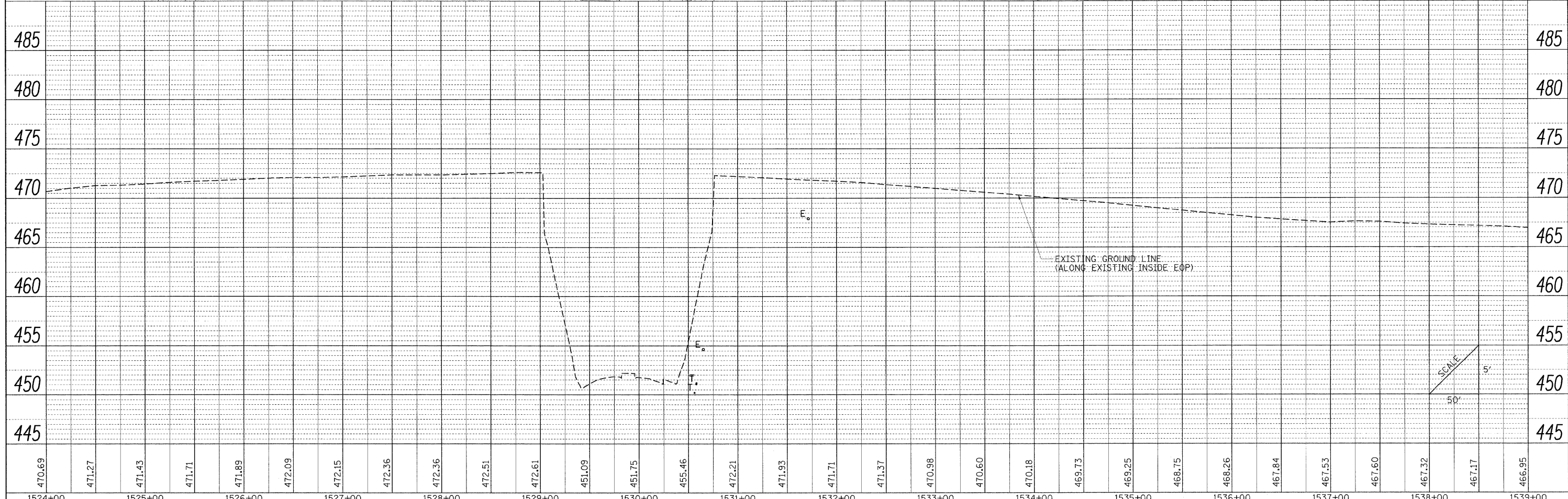

470.69	471.27	471.43	471.71	471.89	472.09	472.15	472.36	472.36	472.51	472.61	451.09	451.75	455.46	472.21	471.93	471.71	471.37	470.98	470.60	470.18	469.73	469.25	468.75	468.26	467.84	467.53	467.60	467.32	467.17	466.95			
1524+00	1525+00	1526+00	1527+00	1528+00	1529+00	1530+00	1531+00	1532+00	1533+00	1534+00	1535+00	1536+00	1537+00	1538+00	1539+00																		

FILE NAME = ...\\0978182-sht-drain157-807.dgn

USER NAME = Brad Downen
 PLOT SCALE = 50.0000' / IN.
 PLOT DATE = 10/12/2011

DESIGNED - KEU
 DRAWN - RAH
 CHECKED - BMB
 DATE - 10/07/11

REVISED -
 REVISED -
 REVISED -
 REVISED -

**STATE OF ILLINOIS
 DEPARTMENT OF TRANSPORTATION**

**DRAINAGE PLAN AND PROFILE
 INTERSTATE 57**

SCALE: 1" = 50' SHEET NO. OF SHEETS STA. 1524+00 TO STA. 1539+00

F.A. RTE.	SECTION	COUNTY	TOTAL SHEETS	SHEET NO.
• (X1-6-2)HBK-2, HB-1,2; (X-1)R-1	WILLIAMSON	968	308	
• F.A.I. 57 AND F.A.P. 331	CONTRACT NO. 78182		ILLINOIS FED. AID PROJECT	