

PLAN	SURVEYED	DATE
	BY	
	PLOTTED	
	DATE	
	BY	
	NOTE BOOK	
	NO.	
	RT. OF WAY CHECKED	
	DATE	
	BY	
	FILE NAME	
	NO.	

PROFILE	SURVEYED	DATE
	BY	
	PLOTTED	
	DATE	
	BY	
	NOTE BOOK	
	NO.	
	RT. OF WAY CHECKED	
	DATE	
	BY	
	FILE NAME	
	NO.	

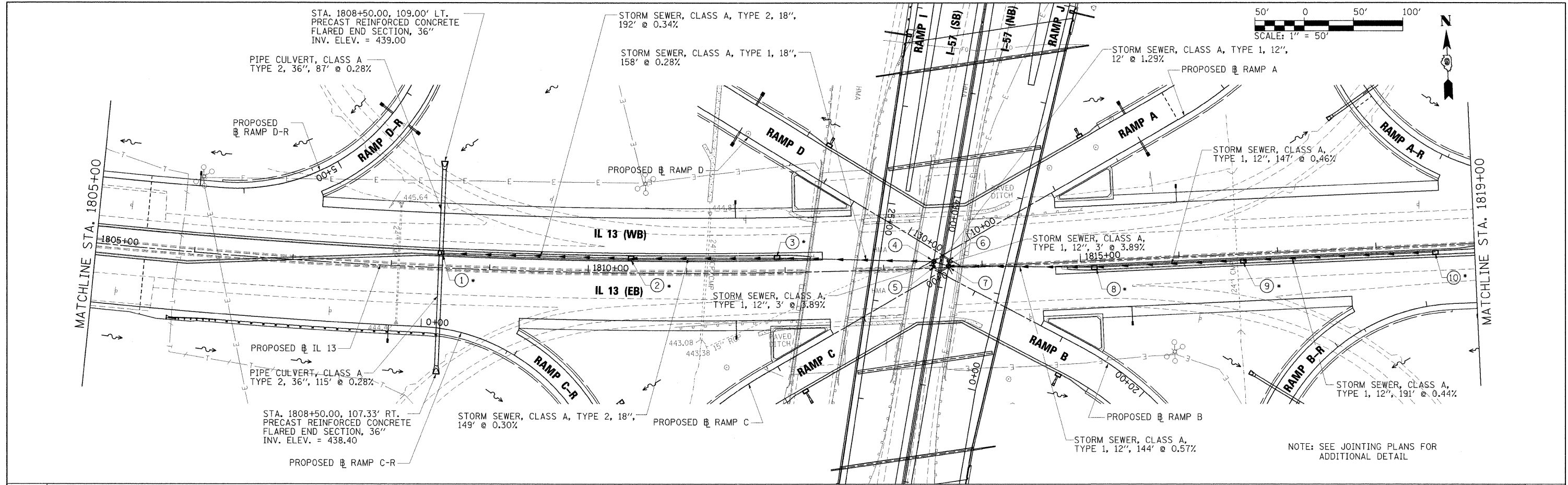

NOTE: SEE JOINTING PLANS FOR ADDITIONAL DETAIL

470	① • STA. 1808+50.00, 12.00' LT. INLETS, SPECIAL, NO. 1 (TYPE 3, 5 FEET) E.O.P. ELEV. = 450.85 TOP OF INLET ELEV. (S) = 451.29 TOP OF INLET ELEV. (N) = 451.75 INV. ELEV. (E) = 443.05 INV. ELEV. (N) = 438.74 INV. ELEV. (S) = 438.74	③ • STA. 1811+92.00, 12.00' LT. INLETS, SPECIAL, NO. 1 (TYPE 3, 5 FEET) E.O.P. ELEV. = 448.87 TOP OF INLET ELEV. (S) = 449.31 TOP OF INLET ELEV. (N) = 449.77 INV. ELEV. (E) = 444.35 INV. ELEV. (W) = 444.25	⑤ STA. 1813+50.72, 0.37' LT. INLET, TYPE A, TYPE 15 FRAME AND LID FLOWLINE = 448.00 TOP OF INLET ELEV. = 448.50 INV. ELEV. (N) = 445.20	⑦ STA. 1813+65.98, 1.19' LT. MANHOLE, TYPE A, 4'-DIAMETER FLOWLINE = 447.98 TOP OF INLET ELEV. = 448.48 INV. ELEV. (S) = 445.00 INV. ELEV. (E) = 445.20 INV. ELEV. (W) = 444.80	⑧ • STA. 1815+13.68, 4.00' RT. INLETS, SPECIAL, NO. 1 (TYPE 3, 5 FEET) E.O.P. ELEV. = 448.64 TOP OF INLET ELEV. (N) = 449.08 TOP OF INLET ELEV. (S) = 449.52 INV. ELEV. (E) = 446.45 INV. ELEV. (W) = 446.35	⑨ • STA. 1816+65.00, 4.00' RT. INLETS, SPECIAL, NO. 1 (TYPE 3, 5 FEET) E.O.P. ELEV. = 449.35 TOP OF INLET ELEV. (N) = 449.79 TOP OF INLET ELEV. (S) = 450.25 INV. ELEV. (E) = 447.25 INV. ELEV. (W) = 447.15	470
465	② • STA. 1810+43.50, 12.00' LT. INLETS, SPECIAL, NO. 1 (TYPE 3, 5 FEET) E.O.P. ELEV. = 449.73 TOP OF INLET ELEV. (S) = 450.17 TOP OF INLET ELEV. (N) = 450.63 INV. ELEV. (E) = 443.80 INV. ELEV. (W) = 443.70	④ STA. 1813+51.07, 6.80' LT. MANHOLE, TYPE A, 4'-DIAMETER FLOWLINE = 447.98 TOP OF INLET ELEV. = 448.48 INV. ELEV. (S) = 445.00 INV. ELEV. (E) = 445.20 INV. ELEV. (W) = 444.80	⑥ STA. 1813+66.35, 7.62' LT. INLET, TYPE A, TYPE 15 FRAME AND LID FLOWLINE ELEV. = 447.99 TOP OF INLET ELEV. = 448.49 INV. ELEV. (S) = 445.70	⑩ • STA. 1818+60.02, 4.00' RT. INLETS, SPECIAL, NO. 1 (TYPE 3, 5 FEET) E.O.P. ELEV. = 450.28 TOP OF INLET ELEV. (N) = 450.72 TOP OF INLET ELEV. (S) = 451.18 INV. ELEV. (W) = 448.10	465		

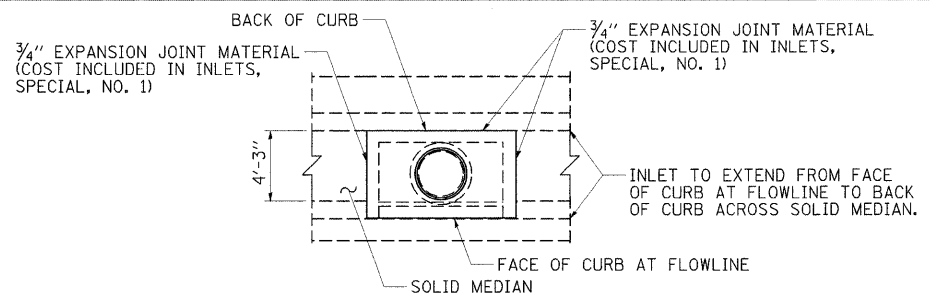

\* DETAIL FOR INLETS, SPECIAL, NO. 1 (TYPE 3, 5 FEET)

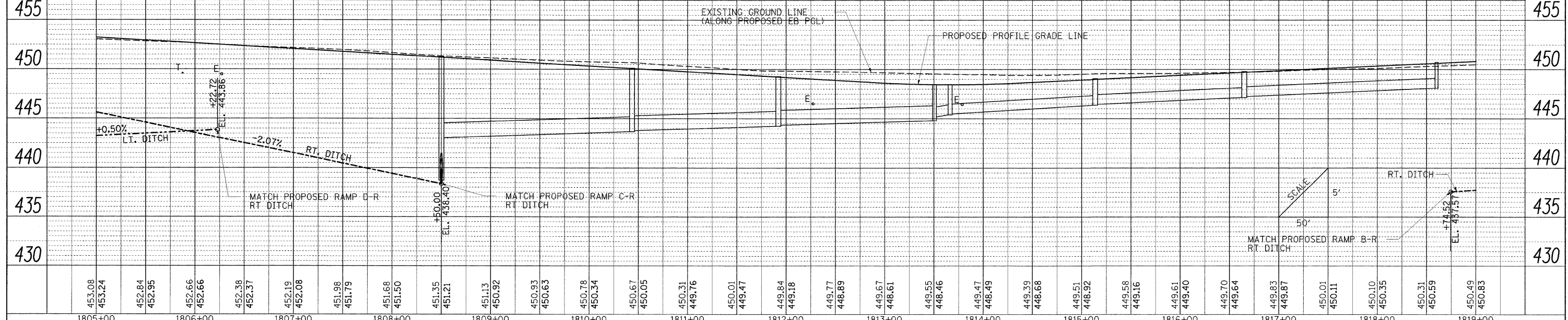

FILE NAME =	USER NAME = Brad Downen	DESIGNED = SCD / BMB	REVISED =	<b>STATE OF ILLINOIS DEPARTMENT OF TRANSPORTATION</b>	<b>DRAINAGE PLAN AND PROFILE ILLINOIS ROUTE 13</b>	F.A. RTE.	SECTION	COUNTY	TOTAL SHEETS	SHEET NO.
...:\0978182-sht-drainIL13-012.dgn	PLOT SCALE = 50.0000' / IN.	DRAWN = JEB / RAH	REVISED =			• 0X1-6-2HBK-2, HB-1,2; 0X-1R-1	WILLIAMSON	968	313	
	PLOT DATE = 10/12/2011	CHECKED = SCD / BJD	REVISED =			• F.A.I. 57 AND F.A.P. 331	CONTRACT NO. 78182			
		DATE = 10/07/11	REVISED =			ILLINOIS FED. AID PROJECT				

SCALE: 1" = 50' SHEET NO. OF SHEETS STA. 1805+00 TO STA. 1819+00