

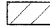





REMOVAL LEGEND

-  PAVEMENT REMOVAL
-  PAVED SHOULDER REMOVAL
-  MEDIAN REMOVAL
-  HOT-MIX ASPHALT SURFACE REMOVAL, BUTT JOINT
-  HOT-MIX ASPHALT SURFACE REMOVAL, VARIABLE DEPTH
-  DRIVEWAY PAVEMENT REMOVAL
-  COMBINATION CURB AND GUTTER REMOVAL
-  TREE REMOVAL

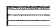

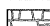
- NOTES:**
1. SEE SCHEDULE OF QUANTITIES FOR REMOVAL DETAILS AND QUANTITIES.
 2. SEE SIGNING AND LIGHTING PLANS FOR SIGNING AND LIGHTING REMOVALS.
 3. SEE DRAINAGE PLAN AND PROFILE SHEETS AND CULVERT PROFILES FOR LIMITS OF PARTIAL CULVERT REMOVAL.

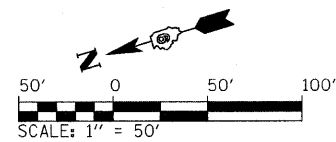
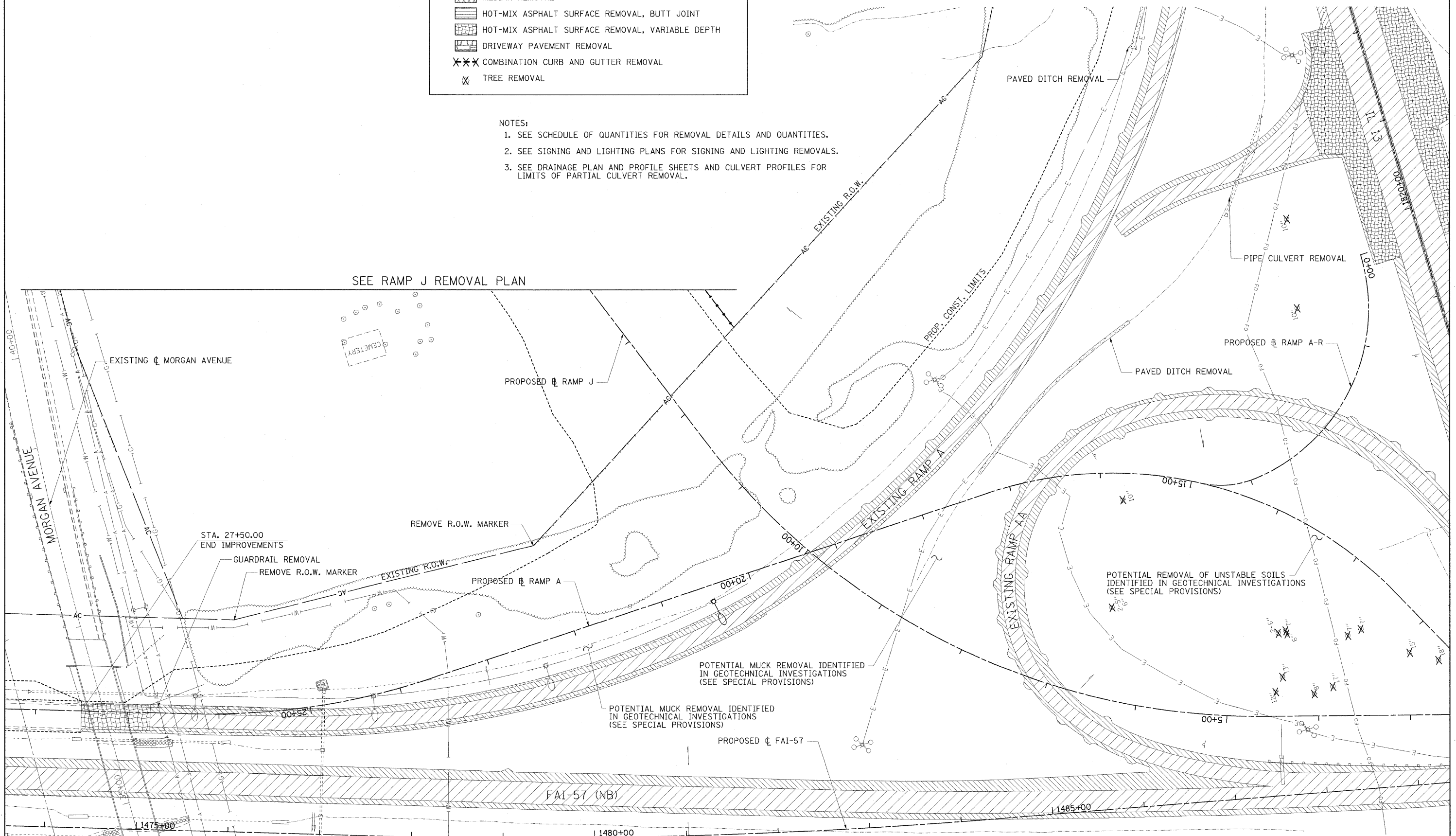

SEE RAMP J REMOVAL PLAN

EXISTING ϕ MORGAN AVENUE

PROPOSED ϕ RAMP J

REMOVE R.O.W. MARKER

STA. 27+50.00
END IMPROVEMENTS

GUARDRAIL REMOVAL

REMOVE R.O.W. MARKER

PROPOSED ϕ RAMP A

POTENTIAL MUCK REMOVAL IDENTIFIED
IN GEOTECHNICAL INVESTIGATIONS
(SEE SPECIAL PROVISIONS)

POTENTIAL MUCK REMOVAL IDENTIFIED
IN GEOTECHNICAL INVESTIGATIONS
(SEE SPECIAL PROVISIONS)

PROPOSED ϕ FAI-57

FAI-57 (NB)

POTENTIAL REMOVAL OF UNSTABLE SOILS
IDENTIFIED IN GEOTECHNICAL INVESTIGATIONS
(SEE SPECIAL PROVISIONS)

FILE NAME =
...10978182-shr-rem-RAMPA_816.dgn

USER NAME = Brad Downen
PLOT SCALE = 50.0000' / IN.
PLOT DATE = 10/12/2011

DESIGNED - MKW
DRAWN - MKW
CHECKED - BJD
DATE - 10/07/11

REVISED -
REVISED -
REVISED -
REVISED -

**STATE OF ILLINOIS
DEPARTMENT OF TRANSPORTATION**

**REMOVAL PLAN
RAMP A**
SCALE: 1" = 50' SHEET NO. OF SHEETS STA. TO STA.

F.A. RTE.	SECTION	COUNTY	TOTAL SHEETS	SHEET NO.
•	(X1-6-2)HBK-2, HB-1,2; (1X-1R-1)	WILLIAMSON	968	353
•	F.A.I. 57 AND F.A.P. 331	WILLIAMSON	CONTRACT NO. 78182	
[ILLINOIS] FED. AID PROJECT				