

MILE
57
STA. 269+63
N=409062.1
E=807330.8

LODGING
EXIT 59
STA. 272+88
N=408737.3
E=807348.9

CAMPING
EXIT 59
STA. 280+58
N=407966.5
E=807346.2

MATCHLINE STA. 268+00

MATCHLINE STA. 283+00

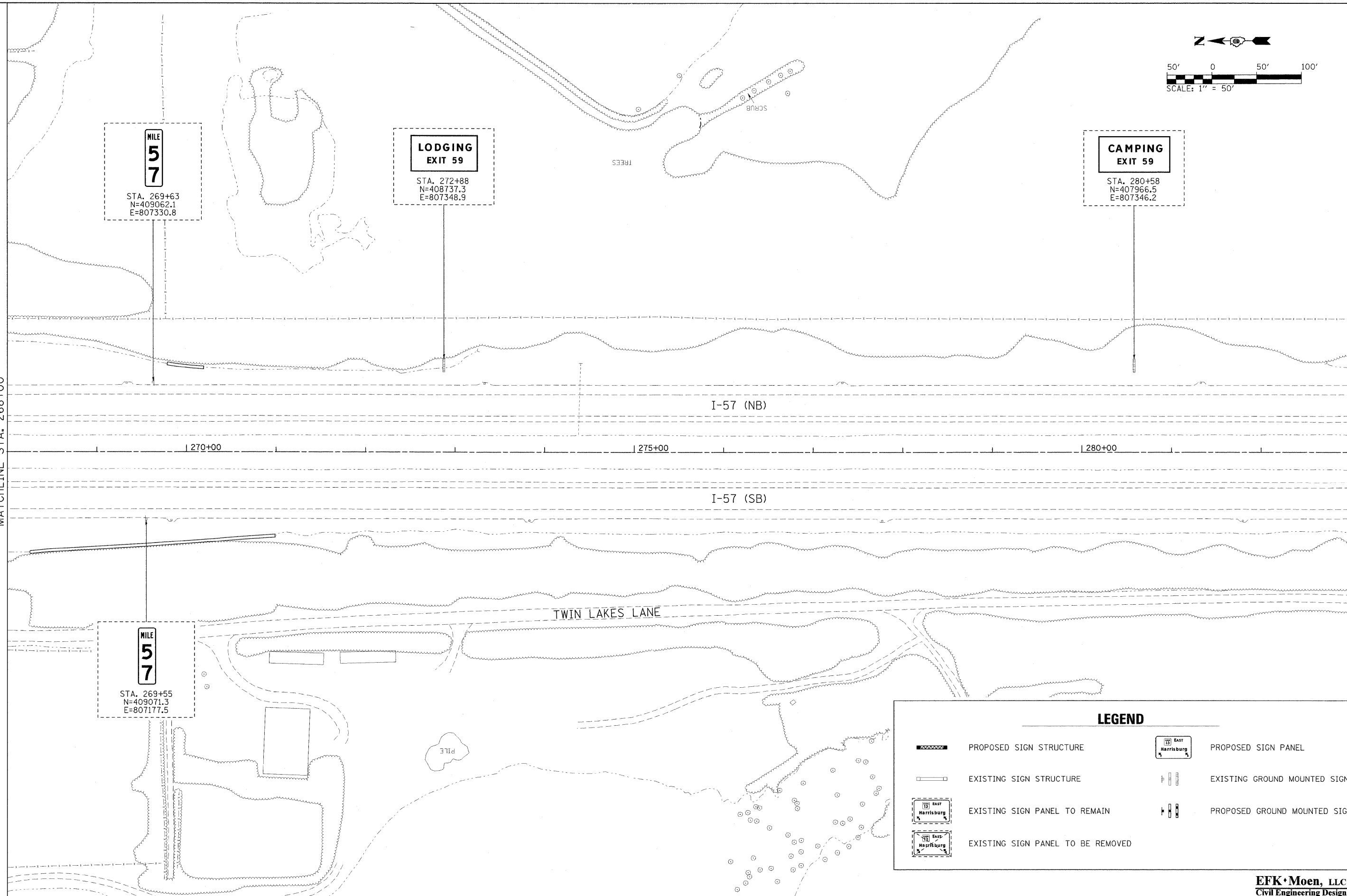

LEGEND	
	PROPOSED SIGN STRUCTURE
	EXISTING SIGN STRUCTURE
	EXISTING SIGN PANEL TO REMAIN
	EXISTING SIGN PANEL TO BE REMOVED
	PROPOSED SIGN PANEL
	EXISTING GROUND MOUNTED SIGN
	PROPOSED GROUND MOUNTED SIGN

EFK Moen, LLC
Civil Engineering Design

FILE NAME = ...D978182-sh1-sign004-157.dgn

USER NAME = Brad Downen	DESIGNED LE/JD	REVISED -
	DRAWN - MK	REVISED -
PLOT SCALE = 50.000000' / IN.	CHECKED - SD	REVISED -
PLOT DATE = 10/10/2011	DATE - 10/07/11	REVISED -

STATE OF ILLINOIS
DEPARTMENT OF TRANSPORTATION

SIGN PLAN
INTERSTATE 57

SCALE: 1" = 50' SHEET NO. 4 OF 43 SHEETS STA. 268+00 TO STA. 283+00

F.A. RTE.	SECTION	COUNTY	TOTAL SHEETS	SHEET NO.
* (X1-6-2)HBK-2, HB-1,2; (X1-1R-1	WILLIAMSON	968	416	
* F.A.I. 57 AND F.A.P. 331	CONTRACT NO. 78182		ILLINOIS FED. AID PROJECT	